



Schools Hill, Cheadle, Cheshire, SK8 1JD

Offers Over £650,000

🛏 5 🍴 2 🚗 3

- Magnificent 5 bed residence • Individual and versatile layout
- Double garage, Enclosed safe • Excellent state and independent schools nearby gardens.
- EPC Rating - D • Approx 3000 square ft
- NO CHAIN



Situated within easy reach of excellent state and independent schools, including the highly regarded Lorus school, we are pleased to offer for sale this magnificent period townhouse. Dating back to circa 1700 and steeped in local history, the property exudes an ambiance of period character and features an individual layout over three floors. In brief the accommodation comprises, lower ground floor; hall, laundry/utility room, downstairs wc, delightful 23' long sitting room and fifth bedroom/study. To the ground floor there is a spacious lounge and open plan dining room through to superb 'fired earth' fitted kitchen with Aga. To the first floor there is a master bedroom with en-suite shower room, three further double bedrooms, and beautiful family bathroom. Outside and to the front, there is a sunny, walled garden enjoying a Southerly aspect. To the rear there is a good sized split level garden with double garage and parking bay beyond. NO CHAIN - VIEWING A MUST!



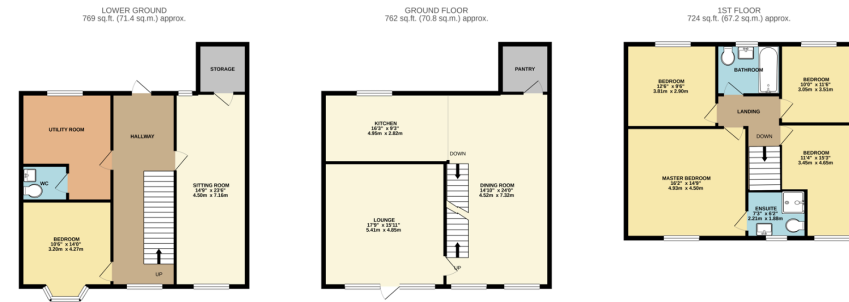

TOTAL FLOOR AREA: 2254 sq.ft. (209.4 sq.m.) approx.

Whilst every attempt has been made to ensure the accuracy of the floorplan contained here, measurements of doors, windows, rooms and any other items are approximate and no responsibility is taken for any error, omission or mis-statement. This plan is for illustration purposes only and should be used as such for any prospective purchaser. The services, systems and appliances shown have not been tested and no guarantee as to their operability or efficiency can be given.
Made with Metreplan 03200

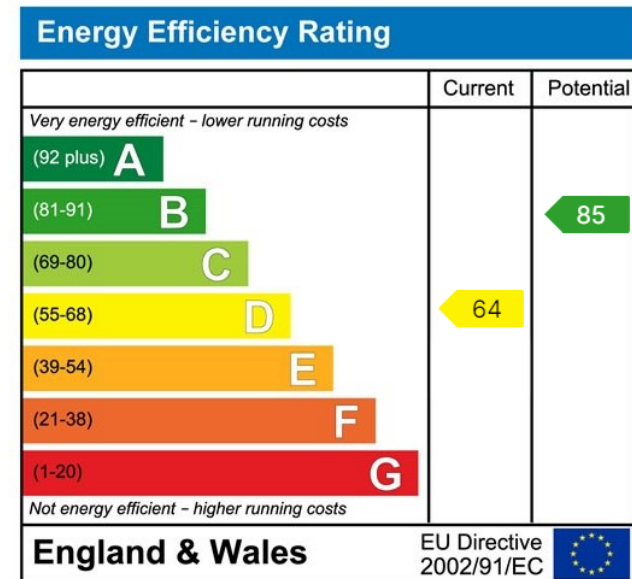

9 Gatley Road, Cheadle, Cheshire SK8 1LY Tel. 0161 428 1488 Fax. 0161 428 1479
Email. mail@andrewdawson.co.uk