



Wolsey Drive, Kingston Upon Thames

Offers Over **£900,000**

Wolsey Drive

Kingston Upon Thames, Kingston Upon Thames

New to market! Roomy end of terrace Tudor house with further potential. Grnd fl shower room added to side, wider third bedroom, spacious extended kitchen/diner. Large garage + OSP, NO CHAIN/VACANT!

Council Tax band: E

Tenure: Freehold

EPC Energy Efficiency Rating:

EPC Environmental Impact Rating:





Wolsey Drive, Kingston Upon Thames, KT2

Approximate Area = 1003 sq ft / 93.2 sq m

Garage = 285 sq ft / 26.5 sq m

Outbuilding = 42 sq ft / 3.9 sq m

Total = 1330 sq ft / 123.6 sq m

For identification only - Not to scale

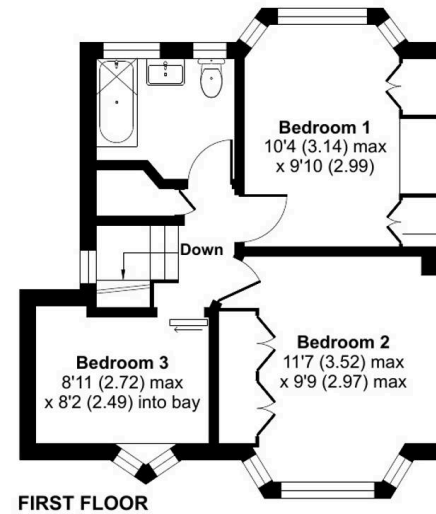
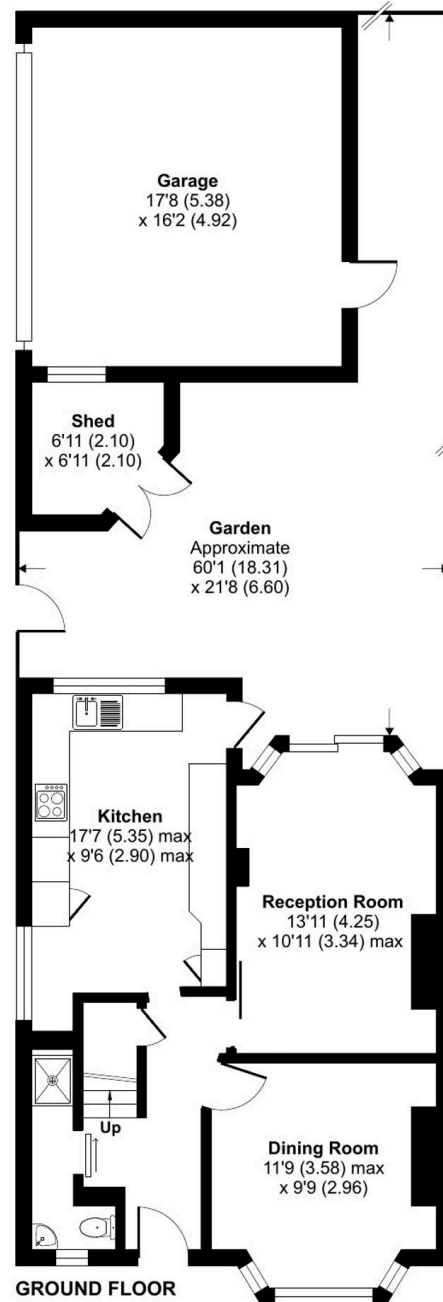

Floor plan produced in accordance with RICS Property Measurement Standards incorporating International Property Measurement Standards (IPMS2 Residential). © nchecon 2024.
Produced for Acres And West LTD (Mervyn Smith Estate Agents). REF: 1221438

Wolsey Drive

Kingston Upon Thames, Kingston Upon Thames

- Just on the market! Roomy end of terrace Tudor house with further potential. Ground floor shower room added to side, wider third bedroom, spacious extended kitchen/diner. NO CHAIN/VACANT!
- Great location for nearby schools – short walk to Tiffin Girls, Kingston Academy and Fernhill School. Also within reach of Latchmere and St Agatha's..
- Wide garage with power and light and easy vehicle access to the rear. Off street parking at the front.
- Kitchen has integral fridge/freezer, pull out pantry cupboard, double Neff ovens, inset Neff five burner gas hob, Neff washing machine and Bosch dishwasher.
- 2 separate receptions : Family bathroom to the 1st floor and shower room to the ground floor : Fitted wardrobes to the two main bedrooms.
- The double storey side extension provides a wider than average, much more usable third bedroom.
- Potential to extend further (stpc). The adjoining property has extended further to the rear ground and another house in the terrace has converted the loft.
- Within reach of the 65, 371 and K5 bus services. Nearby shops on Ham Parade or Tudor Drive.

Popular residential side road on the requested 1930s North Kingston Tudor development. Within close reach of a choice of sought after schools including Tiffin Girls, Ofsted Outstanding Kingston Academy and Fernhill School, Latchmere School and St Agatha's. Convenient for the 371,K5 and 65 bus services. Near to the Hawker Centre Gym. Wolsey Drive is between the lovely North Kingston Riverside and the open spaces of Richmond Park.

