



John William Close, , New Cross,  
London, SE14 5XE

Asking Price Of £310,000

Are you looking for your first step onto the property ladder or a savvy investment opportunity? Look no further than this fantastic second floor flat in Newland House, New Cross!

Located in a quiet cul-de-sac with excellent transport links to London, this purpose-built flat boasts two double bedrooms, a spacious living room with room for a dining table. There is a modern bathroom. The property is in good condition and ready to move into, with double glazing and a 159-year lease for added peace of mind. **#AskBeaumont**



# Newland House, John William Close

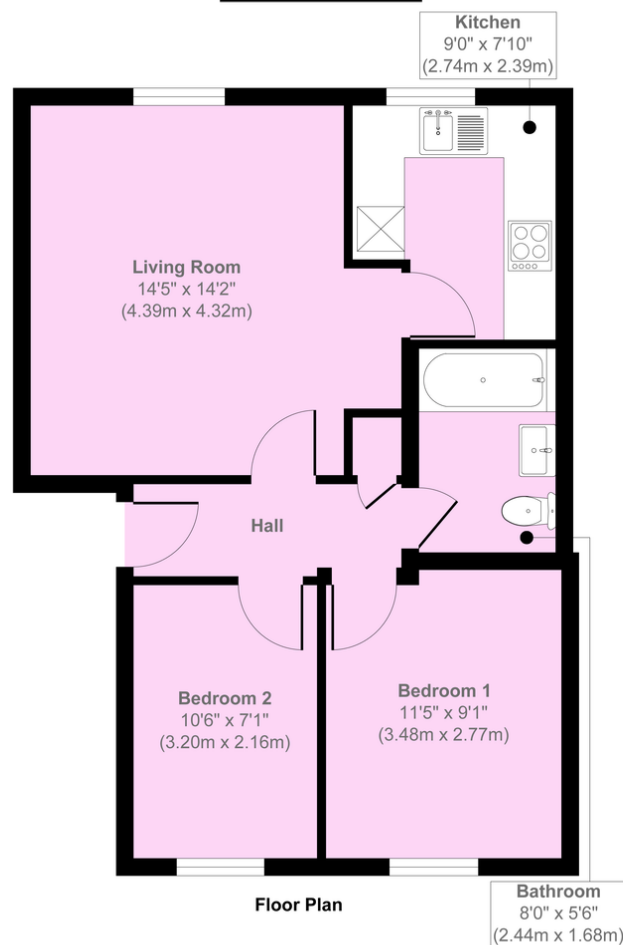

Approx. Gross Internal Floor Area 529 sq. ft / 49.14 sq. m

Illustration for identification purposes only, measurements are approximate, not to scale.  
Copyright © markbeaumont.com  
Produced by Elements Property



24 Scotts Road  
Scotts Place  
Bromley  
Kent  
BR1 3QD

www.markbeaumont.com  
sales@markbeaumont.com  
020 8852 5000

Agents Note: Whilst every care has been taken to prepare these particulars, they are for guidance purposes only. All measurements are approximate are for general guidance purposes only and whilst every care has been taken to ensure their accuracy, they should not be relied upon and potential buyers are advised to recheck the measurements