







## Property Summary

A striking & contemporary third floor flat. Located within 'Silkworks' landscaped grounds. This is a one bedroom apartment situated on the third floor comprising spacious lounge and dining room with modern open plan kitchen opening onto a Juliet balcony, one double bedroom, and one full bathroom. This imposing development is a flagship of modern design where no detail has been overlooked. There is a Gym and a lift. The property is located just a 0.1 mile from Elverson Road DLR and 0.3 Mile to Lewisham Station, less to Tescos and a little further to the main town High Street. Onsite gym and concierge.

## Property Features

- 1 Bed Flat
- Lift
- Onsite gym and concierge
- 0.3 Mile to Lewisham Station
- Juliet Balcony
- Double Bedroom
- 0.1 mile from Elverson Road DLR



AGENTS' NOTE We have been advised the following:

Lease. 999 years from 01/01/2009. 985 years remaining

Service Charge: £2919.53

Ground Rent: £350

Council Tax approx.: £1,413





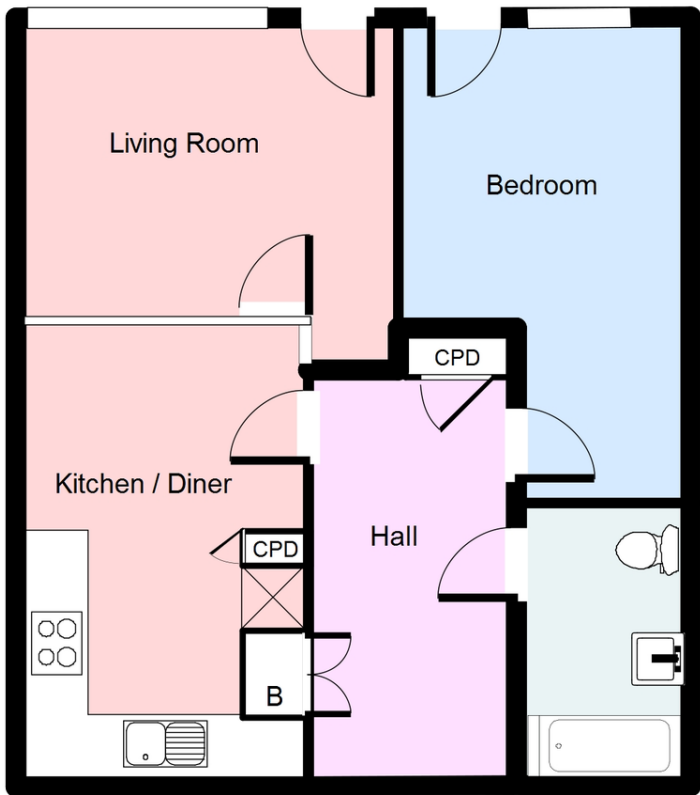

Copyright Mark Beaumont Estate Agents

510 sq. ft

Score	Energy rating	Current	Potential
92+	A		
81-91	B	85   B	85   B
69-80	C		
55-68	D		
39-54	E		
21-38	F		
1-20	G		