





Property Summary

A bright & spacious two bedroom first floor Victorian Conversion flat. Located in a popular tree lined Road and within good accessible distance to a choice of five main line stations and local transport. Good decorative order throughout which includes a fitted kitchen with built in appliances and good range of built in units, as well as a modern bathroom. The reception room has a feature fireplace and two arched character windows. Further benefits to note are smart inset halogen spot lighting, gas central heating. Share of Freehold.

Property Features

- VICTORIAN CONVERSION FLAT
- FIRST FLOOR
- 2 BEDROOMS
- FITTED KITCHEN
- MODERN BATHROOM
- 5 STATIONS WITHIN A MILE
- 6 PARKS WITHIN A MILE
- TREE LINED STREET
- GOOD CONDITION
- SHARE OF FREEHOLD





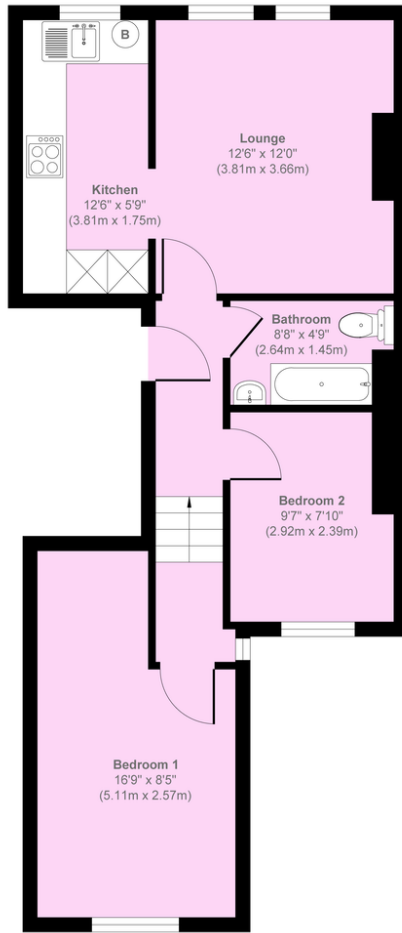

Top Floor

Approx. Gross Internal Floor Area 559 sq. ft / 52.00 sq. m

Illustration for identification purposes only, measurements are approximate, not to scale.
 Copyright © markbeaumont.com
 Produced by Elements Property

Score	Energy rating	Current	Potential
92+	A		
81-91	B		
69-80	C	70 c	79 c
55-68	D		
39-54	E		
21-38	F		
1-20	G		