

**67, Frankwell, Shrewsbury, SY3 8JR**  
£850 Per Month





67, Frankwell, Shrewsbury, SY3 8JR

**£850 Per Month**

VIRTUAL TOUR AVAILABLE: Beautifully refurbished two bedroom Victorian terraced house a short walk from Shrewsbury town centre.

Available: 12/02/26

## Description

Comprising: Living room, kitchen including oven & gas hob, dining room, bathroom including shower, two double bedrooms. Double glazing to the rear, secondary glazing to the front. Gas central heating. Small patio area leading to attractive tiered rear garden. EPC C

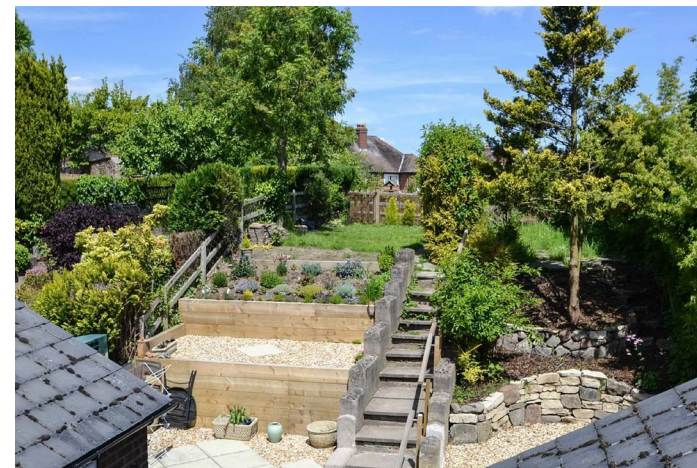

Unfurnished

Council Tax Band: B

Available: 12th February 2026

EPC: C



Floor Plans

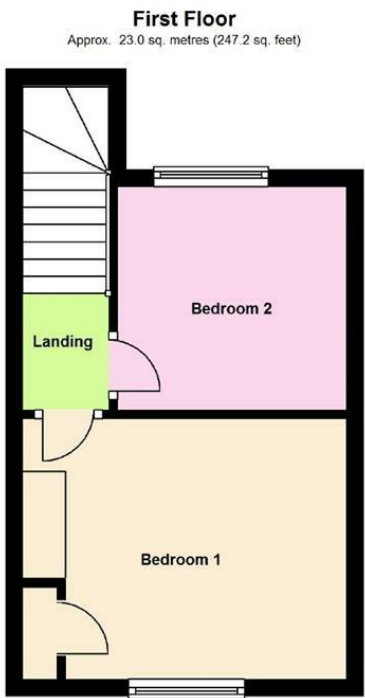
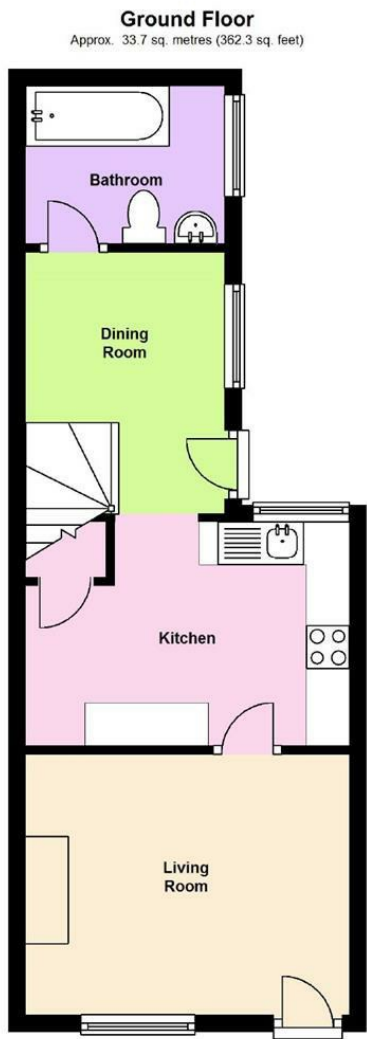

Total area: approx. 56.6 sq. metres (609.6 sq. feet)

We accept no responsibility for any mistake or inaccuracy contained within the floorplan. The floorplan is provided as a guide only and should be taken as an illustration only. The measurements, contents and positioning are approximations only and provided as a guidance tool and not an exact replication of the property.  
Plan produced using PlanUp.

These particulars, whilst believed to be accurate are set out as a general outline only for guidance and do not constitute any part of an offer or contract. Intending purchasers should not rely on them as statements of representation of fact, but must satisfy themselves by inspection or otherwise as to their accuracy. No person in this firms employment has the authority to make or give any representation or warranty in respect of the property.