



19, Lambourn Drive, Bicton Heath, Shrewsbury, SY3 5NE
£995 Per Month



19, Lambourn Drive, Bicton Heath, Shrewsbury, SY3 5NE

£995 Per Month

A modern three bedroom semi-detached house in good condition, a short distance from Royal Shrewsbury Hospital. Benefitting from a lovely private garden and located in a quiet residential area on the west of Shrewsbury a short distance from an excellent school and a range of amenities.

Available: Immediately

Description

Entrance hall, cloakroom, living room, kitchen/dining room including double oven, fridge/freezer, dishwasher and washing machine, two double bedrooms, one single bedroom bathroom including shower, driveway parking, good sized garage, gardens, double glazed windows & doors, gas fired central heating. EPC D



Unfurnished

Council Tax Band: C

Available: 23rd January 2026

EPC: D



Floor Plans

Ground Floor
Approx. 49.4 sq. metres (531.2 sq. feet)



First Floor
Approx. 33.1 sq. metres (355.8 sq. feet)

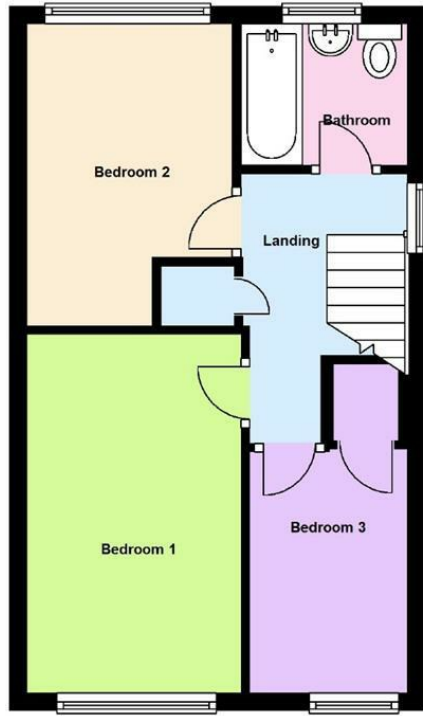

Total area: approx. 82.4 sq. metres (887.1 sq. feet)

We accept no responsibility for any mistake or inaccuracy contained within the floorplan. The floorplan is provided as a guide only and should be taken as an illustration only. The measurements, contents and positioning are approximations only and provided as a guidance tool and not an exact replication of the property.
Plan produced using PlanUp.

These particulars, whilst believed to be accurate are set out as a general outline only for guidance and do not constitute any part of an offer or contract. Intending purchasers should not rely on them as statements of representation of fact, but must satisfy themselves by inspection or otherwise as to their accuracy. No person in this firms employment has the authority to make or give any representation or warranty in respect of the property.