

9 Hawthorn Flatlets, Hawthorn Road, Belle Vue Road, Shrewsbury, SY3 7LZ
£500 Per Month



9 Hawthorn Flatlets, Hawthorn Road, Belle Vue Road, Shrewsbury, SY3 7LZ

£500 Per Month

VIRTUAL TOUR AVAILABLE - Ground floor studio flat nestled in a very quiet position in the heart of the popular residential area of Belle Vue, within walking distance of Shrewsbury town centre. Includes driveway parking.

Available: Immediately

Description

Open plan living and bedroom area including store cupboard, kitchen area including hob, fridge, microwave, shower room. Communal Garden. EPC TBC



Unfurnished

Council Tax Band: A

Available: 1st October 2025

EPC:

Floor Plans

GROUND FLOOR

APPROX. 23.5 SQ. METRES (253.3 SQ. FEET)

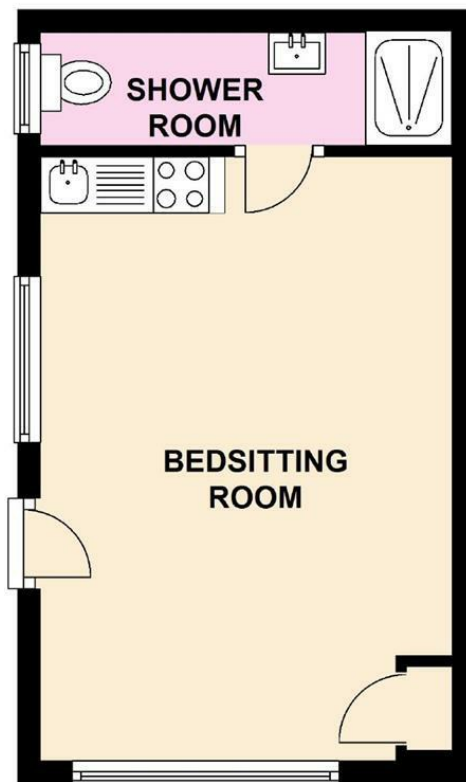

TOTAL AREA: APPROX. 23.5 SQ. METRES (253.3 SQ. FEET)

We accept no responsibility for any mistake or inaccuracy contained within the floorplan. The floorplan is provided as a guide only and should be taken as an illustration only. The measurements, contents and positioning are approximations only and provided as a guidance tool and not an exact replication of the property.

Plan produced using PlanUp.

These particulars, whilst believed to be accurate are set out as a general outline only for guidance and do not constitute any part of an offer or contract. Intending purchasers should not rely on them as statements of representation of fact, but must satisfy themselves by inspection or otherwise as to their accuracy. No person in this firm's employment has the authority to make or give any representation or warranty in respect of the property.