

5 The Old Glassworks, Coton Hill, Shrewsbury, SY1 2DR
£1,500 Per Month



5 The Old Glassworks, Coton Hill, Shrewsbury, SY1 2DR

£1,500 Per Month

VIRTUAL TOUR AVAILABLE - The Old Glassworks is a superb conversion of a former riverside church into nine individually designed luxury apartments retaining many original features whilst benefitting from a contemporary finish. Includes secure, allocated parking, lift access and private basement storage. No 5 benefits from two superb balconies overlooking the River Severn.

Available: 27/08/25

Description

Comprising: Entrance off communal landing adjacent to lift. Entrance hall with large storage cupboard, WC, spacious open plan living/dining room with kitchen and panoramic glass windows to private roof terrace, kitchen includes integrated fridge freezer, dishwasher, oven and electric hob, double bedroom with en suite shower room and views out to roof terrace. Stairs to landing, primary bedroom with built in wardrobes, en suite bathroom with shower overhead and wrap around glass windows, glass sliding door to private terrace and views over the River Severn and Chester Street. Allocated parking. Gas Central Heating. Double Glazing. EPC B.



Unfurnished

Council Tax Band: C

Available: 27th August 2025

EPC: B



Floor Plans

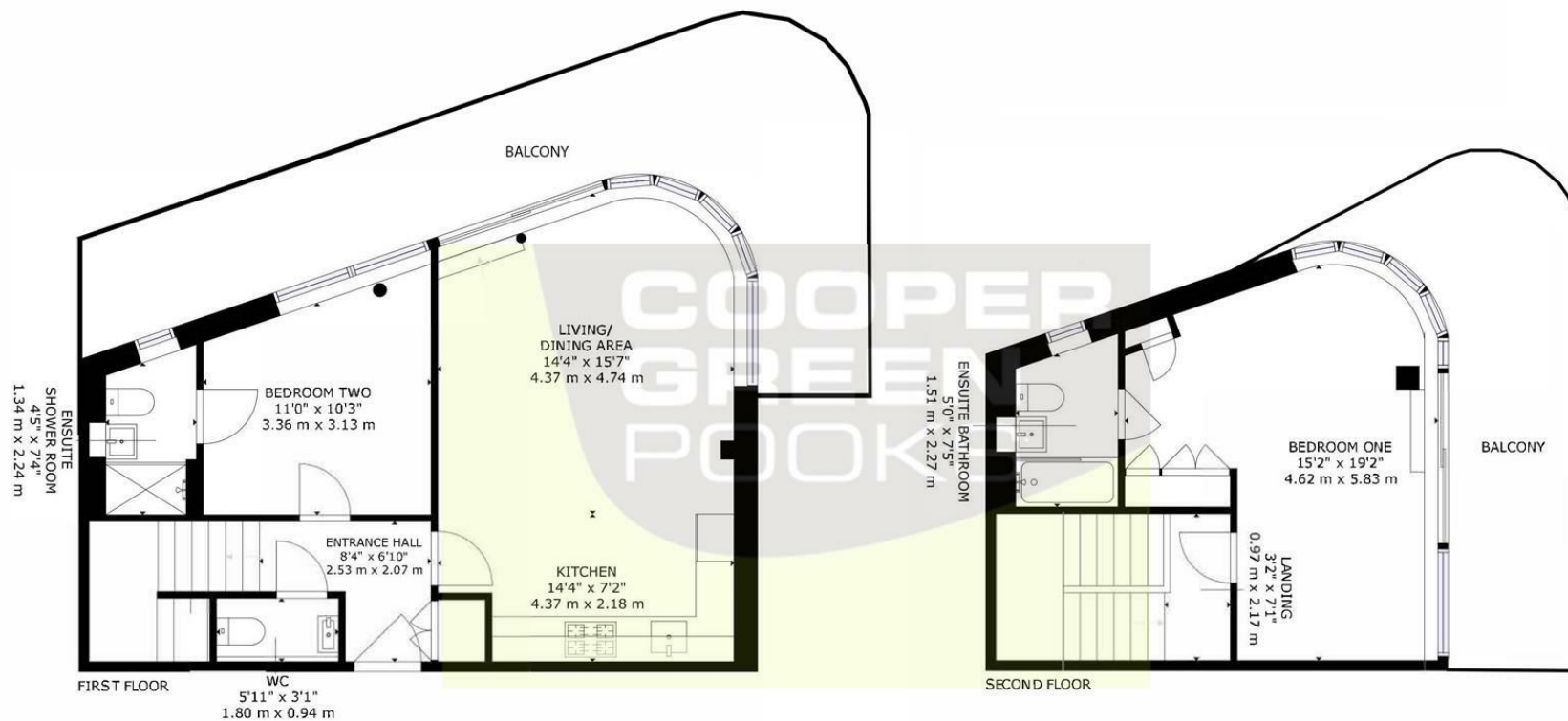

TWO STOREY FIRST FLOOR APARTMENT

GROSS INTERNAL AREA
 FIRST FLOOR: 613 sq.ft, 57 m², SECOND FLOOR: 362 sq.ft, 34 m²
 TOTAL: 975 sq.ft, 91 m²

SIZE AND DIMENSIONS ARE APPROXIMATE, ACTUAL MAY VARY

These particulars, whilst believed to be accurate are set out as a general outline only for guidance and do not constitute any part of an offer or contract. Intending purchasers should not rely on them as statements of representation of fact, but must satisfy themselves by inspection or otherwise as to their accuracy. No person in this firm's employment has the authority to make or give any representation or warranty in respect of the property.