



The White House, Lyth Hill Road, Bayston Hill, Shrewsbury, SY3 0AU

4 bedroom detached house—£1,450,000 Freehold

The White House, Lyth Hill Road, Bayston Hill, Shrewsbury, SY3 0AU

Coopergreenpooks.co.uk

£1,450,000 Freehold— 4 bedroom detached house

sales@cgpooks.co.uk

Occupying a fantastic position with impressive views over surrounding countryside, this beautiful detached house of character has been sympathetically improved and extended to provide very well-designed and practical accommodation over three floors. The property is set within landscaped gardens adjoining fields, with the plot extending up to just under 8 acres in total. The White House is quietly situated at the foot of the Lyth Hill conservation area, while being just a few minutes from Bayston Hill and its excellent range of amenities and primary school, as well as short distance from the bypass and town centre.

KEY FEATURES

- Lovely entrance hall opening to an inner hallway with feature turning staircases providing access to both the first and lower ground floors
- Stunning drawing room with large fireplace, wood boarded flooring and bi-folding doors onto the rear garden
- Separate sitting room with wood burning stove and bay window offering views to the front
- Two double bedrooms at ground floor level, a separate shower room and en-suite to bedroom two
- On the lower ground floor is a beautiful dining room, again having a feature fireplace and wood burning stove, with glazed double doors onto the garden
- The kitchen has been sympathetically extended to provide a contemporary and spacious room, complete with a range of bespoke fitted units, Fisher and Paykel range cooker and fridge freezer, island/breakfast bar, part-vaulted ceiling, doors to the garden and floor to ceiling glazing allowing plenty of natural light
- There is also a very useful cellar/store and practical boot room which connects to both a shower room and large utility
- On the first floor is a thoughtfully designed master bedroom with multiple built-in wardrobes, dressing area, Juliette balcony's to the rear and en-suite bathroom with shower
- A further double bedroom, study and family shower room are also at first floor level
- The property offers all the character expected from a house of this age, while being finished to a modern and contemporary standard. A new boiler and complete heating system was installed in 2017, along with all associated domestic pipework. Most rooms benefit from having windows to two elevations, creating a very light and comfortable feel throughout each floor
- The immediate garden comprises areas of lawn, paved terracing, planted borders and raised beds, as well as a section of wild meadow with footpaths leading to the adjoining fields. The rest of the land has been divided into useable paddocks, and the total area extends up to just under 8 acres, ideally suited to equestrian use, keeping livestock or as a smallholding
- To the front of the property is an extensive driveway with two access points off Lyth Hill Road, detached garaging and versatile outbuildings which are currently used for storage but provide potential for further development if required
- A superb position with the most stunning views over the surrounding Shropshire countryside, while being conveniently located within a 5-minute drive of the town centre and within easy access of Bayston Hill and road links via the bypass, while being conveniently located within a 5-minute drive of the town centre and within easy access of Bayston Hill and road links via the bypass

The White House, Lyth Hill Road, Bayston Hill, Shrewsbury, SY3 0AU

Coopergreenpooks.co.uk

£1,450,000 Freehold— 4 bedroom detached house

sales@cgpooks.co.uk

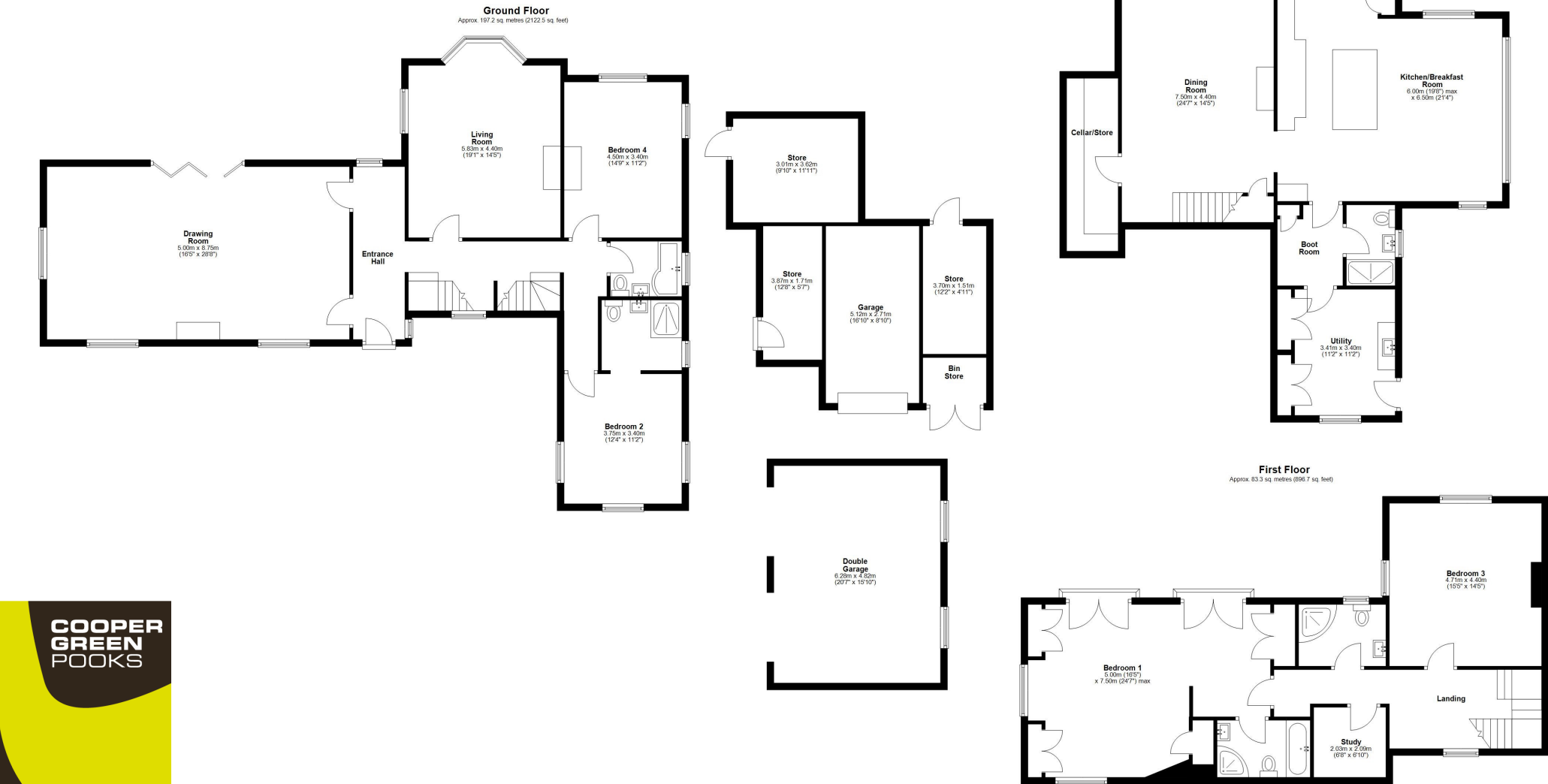

Total area: approx. 379.8 sq. metres (4088.4 sq. feet)





















The White House, Lyth Hill Road, Bayston Hill, Shrewsbury, SY3 0AU

£1,450,000 Freehold— 4 bedroom detached house

sales@cgpooks.co.uk

rightmove 

 onTheMarket.com

 **RICS**
Regulated by RICS

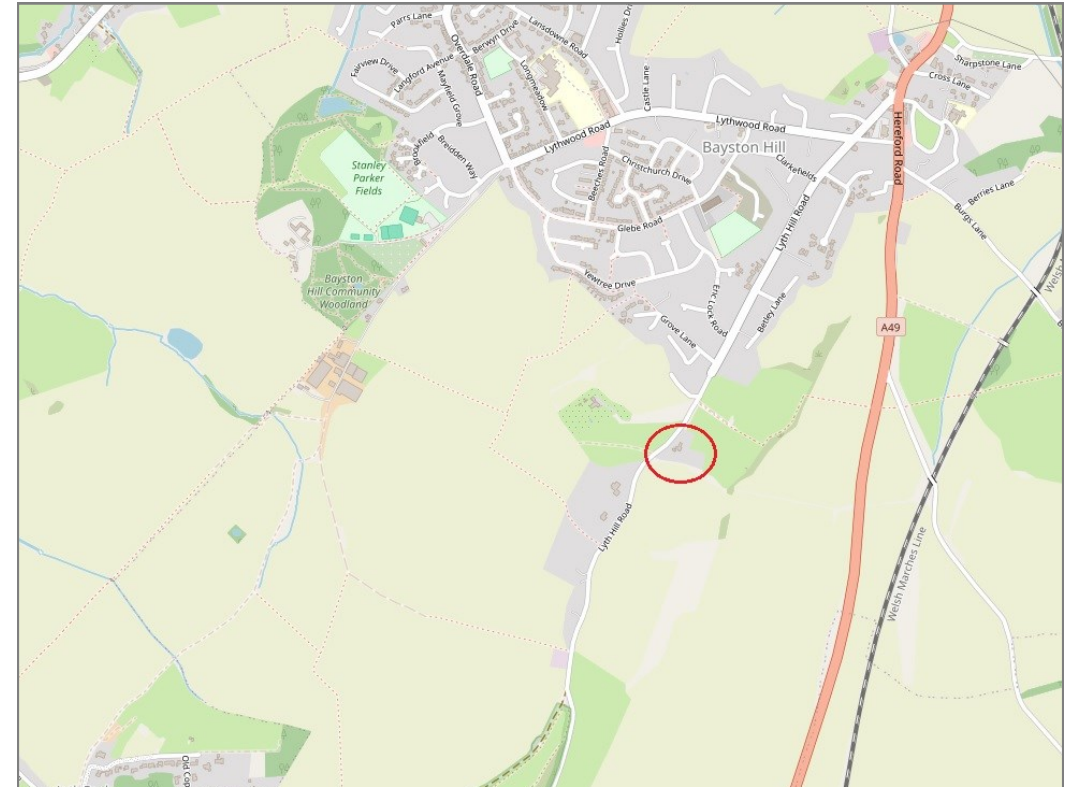
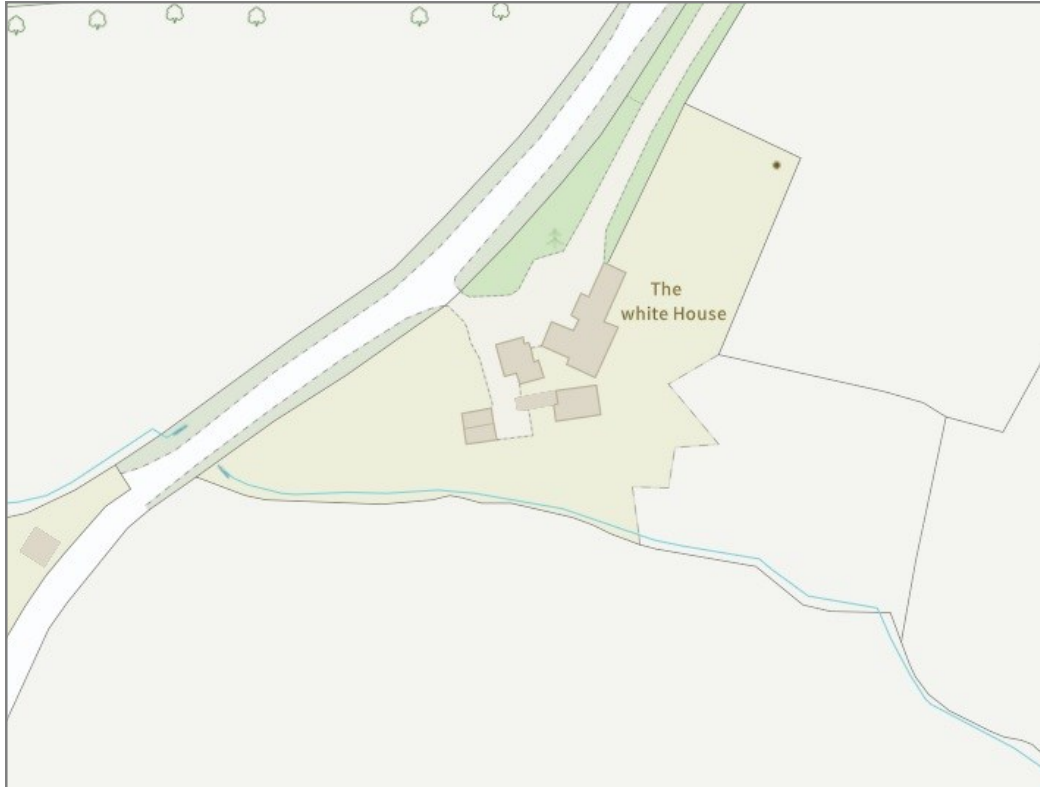

BOUNDARIES NOT CONFIRMED

Tenure	Freehold
Local Authority	Shropshire Council
Council Tax	Band G
EPC Band	Band D
Services	Mains electricity, gas and water are connected, with private drainage

 **Expert mortgage advice available**

3 Barker St, Shrewsbury SY1 1QF

Cooper Green Pooks
01743 276666



Your home may be repossessed if you do not keep up repayments on your mortgage.

There may be a fee for mortgage advice. The actual amount you pay will depend upon your circumstances. The fee is up to 1% but a typical fee is 0.3% of the amount borrowed.

The White House, Lyth Hill Road, Bayston Hill, Shrewsbury, SY3 0AU

Coopergreenpooks.co.uk

£1,450,000 Freehold— 4 bedroom detached house

sales@cgpooks.co.uk

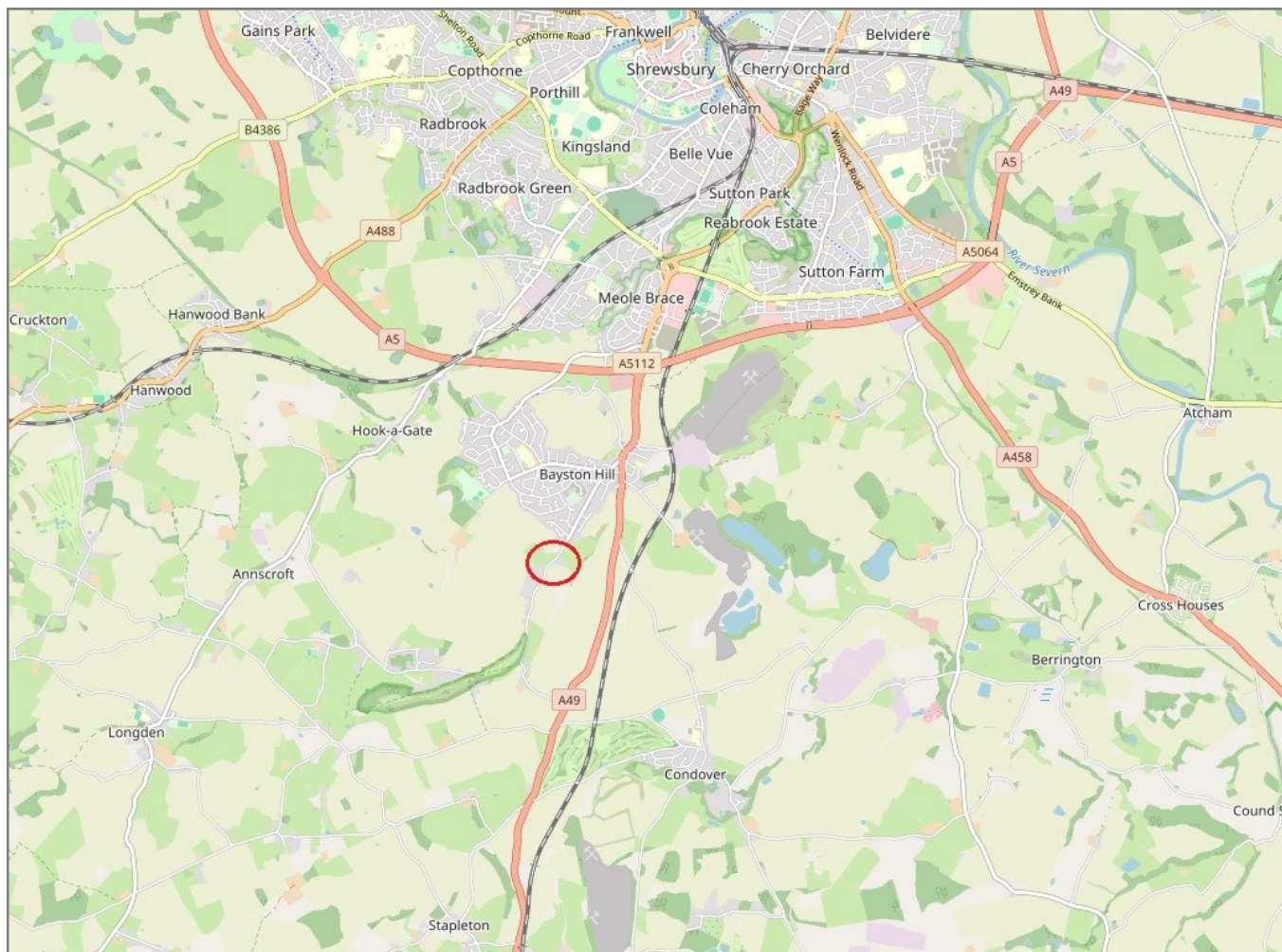

IMPORTANT NOTICE: Cooper Green Pooks for themselves and for the lessors or vendors of this property whose agents they are give notice that: 1 No appliances, services or service installations have been tested and no warranty as to suitability or serviceability is implied. Any prospective purchaser or lessee is advised to obtain verification from their surveyor or solicitor. 2. The particulars are set out as a general outline only for the guidance of the intended purchasers or lessees and do not constitute, nor constitute part of, an offer or contract. 3. All descriptions, reference to condition and necessary permissions for use and occupation and other details are given in good faith and are believed to be correct but any intending purchasers or lessees should not rely on them as statements or representation of fact but satisfy themselves by inspection or otherwise as to the correctness of each of them. 4. No person in the employment of Cooper Green Pooks has any authority to make or give any representation or warranty whatsoever in relation to this property. 5. All rentals and prices are quoted exclusive of Stamp Duty, legal and surveyors fees and any other associated purchasers or lessees costs. 6. Floor plans are indicative only and should not be relied on. 7. The plan showing the boundary of the property is indicative only and has not been checked against the legal title so should not be relied on. 8. All dimensions, floor areas and site areas are only approximate and should not be relied on. Dimensions are generally maximum room dimension.