



23, Carlton Close, Off Racecourse Lane, Shrewsbury, SY3 5JA
£1,250 Per Month



23, Carlton Close, Off Racecourse Lane, Shrewsbury, SY3 5JA

£1,250 Per Month

VIRTUAL TOUR AVAILABLE - Well presented three bedroom detached house benefiting from a private garden, driveway parking for two cars and a single garage with electric door. The property is located in a very popular residential area of Shrewsbury, a short distance from excellent schools, the Royal Shrewsbury Hospital and road links via the bypass.

Available: 12/08/25

Description

Comprising: entrance hall, living room, kitchen with integrated fridge, freezer, hob and oven, space for freestanding washing machine. Stairs to first floor landing, two double bedrooms, further single bedroom, bathroom with shower over bath. Double glazing. Gas central heating. Garage. Driveway parking. EPC D.



Unfurnished

Council Tax Band: D

Available: 12th August 2025

EPC: D



Floor Plans

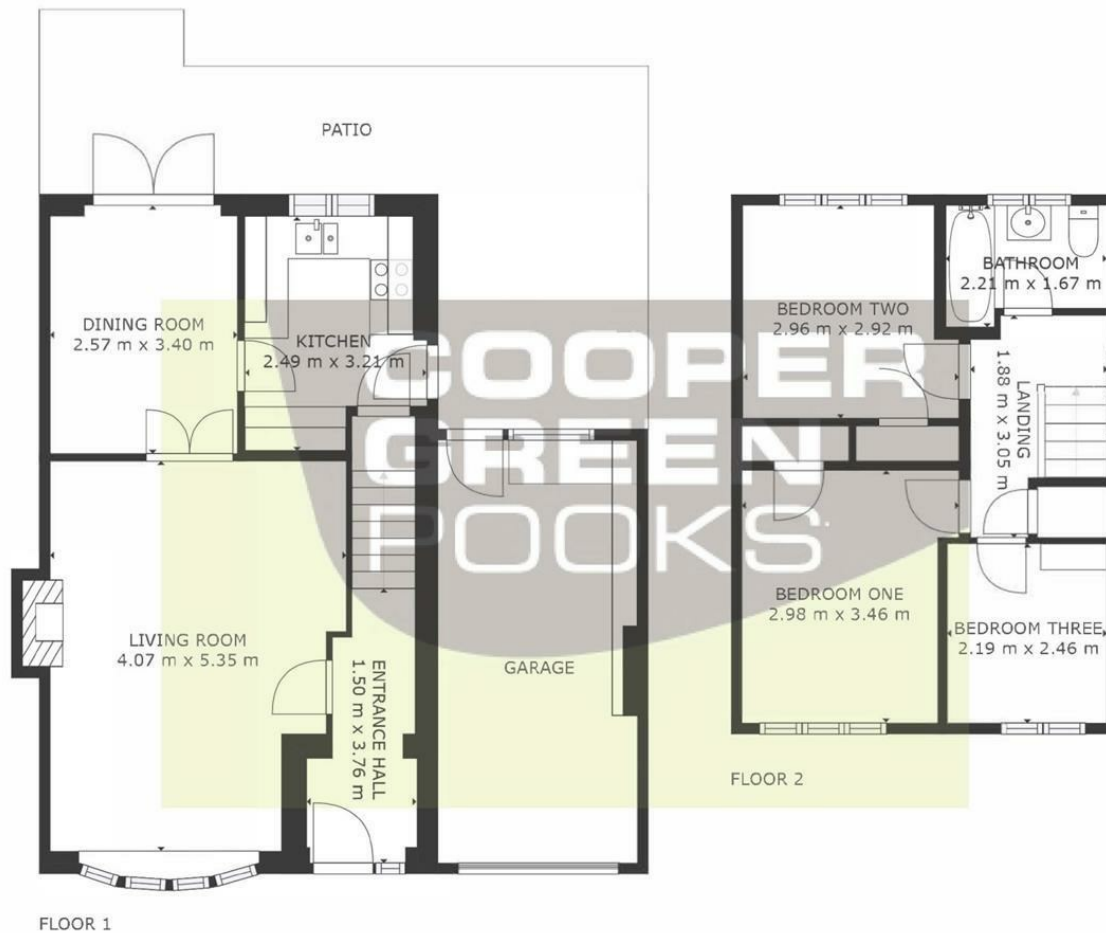

GROSS INTERNAL AREA
FLOOR 1: 46 m², FLOOR 2: 36 m²
TOTAL: 82 m²
SIZES AND DIMENSIONS ARE APPROXIMATE, ACTUAL MAY VARY.



These particulars, whilst believed to be accurate are set out as a general outline only for guidance and do not constitute any part of an offer or contract. Intending purchasers should not rely on them as statements of representation of fact, but must satisfy themselves by inspection or otherwise as to their accuracy. No person in this firm's employment has the authority to make or give any representation or warranty in respect of the property.