



15, St Julians Mews, Williams Way, Shrewsbury, SY1 1AD
£995 Per Month



15, St Julians Mews, Williams Way, Shrewsbury, SY1 1AD

£995 Per Month

VIRTUAL TOUR AVAILABLE - Modern, spacious two bedroom first floor apartment located in a desirable, gated development on the edge of Quarry Park in the heart of Shrewsbury. Includes allocated parking space.

Available: 08/08/25

Description

Comprising: Communal entrance with intercom, stairs to first floor, private entrance Hall, kitchen including dishwasher, washer/dryer, fridge/freezer, oven & gas hob, dining area, large living room, master bedroom with en-suite shower room, further double bedroom, bathroom including shower. Gas central heating, double glazing. Gated allocated parking space. EPC B



Unfurnished

Council Tax Band: B

Available: 8th August 2025

EPC: B



Floor Plans

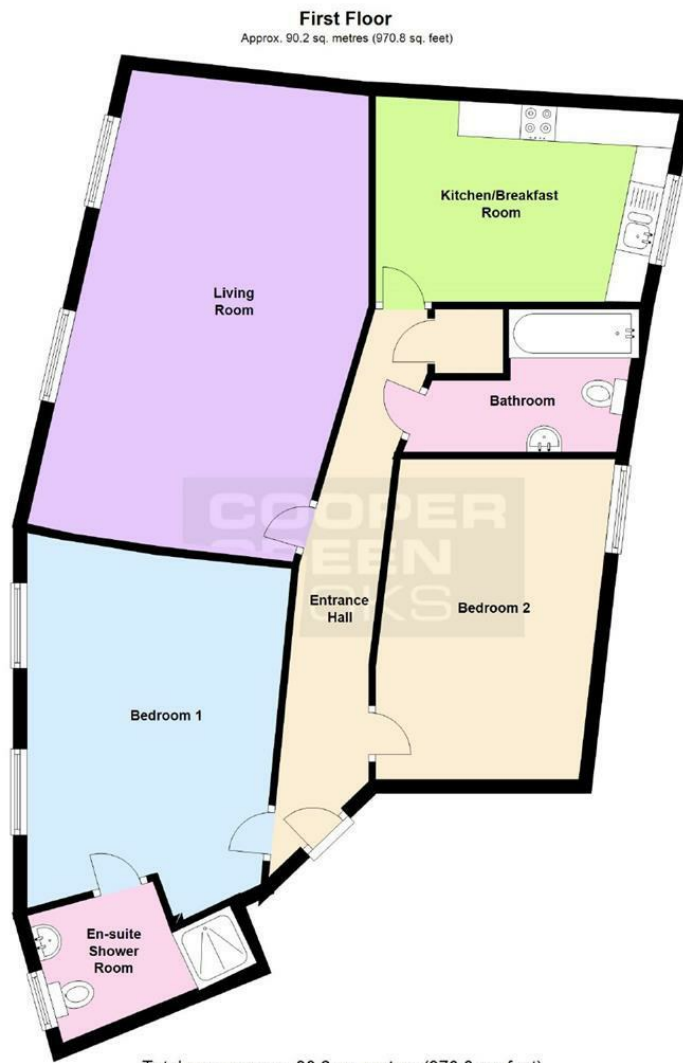

Total area: approx. 90.2 sq. metres (970.8 sq. feet)

We accept no responsibility for any mistake or inaccuracy contained within the floorplan. The floorplan is provided as a guide only and should be taken as an illustration only. The measurements, contents and positioning are approximations only and provided as a guidance tool and not an exact replication of the property.
Plan produced using PlanUp.

These particulars, whilst believed to be accurate are set out as a general outline only for guidance and do not constitute any part of an offer or contract. Intending purchasers should not rely on them as statements of representation of fact, but must satisfy themselves by inspection or otherwise as to their accuracy. No person in this firm's employment has the authority to make or give any representation or warranty in respect of the property.