



Flat B, 33, Underdale Road, Shrewsbury, SY2 5DT

£550 Per Month



Flat B, 33, Underdale Road, Shrewsbury, SY2 5DT

£550 Per Month

VIRTUAL TOUR AVAILABLE: One bedroom first floor flat with views over the River Sever located a short walk from Shrewsbury town centre and the railway station. Residents parking to the front.

Available: 11/07/2025

Description

Comprising: Entrance hall, kitchen, large living room with views and high heat retention storage heater, large bedroom, shower room. EPC D



Unfurnished

Council Tax Band: A

Available: 11th July 2025

EPC: D

Floor Plans

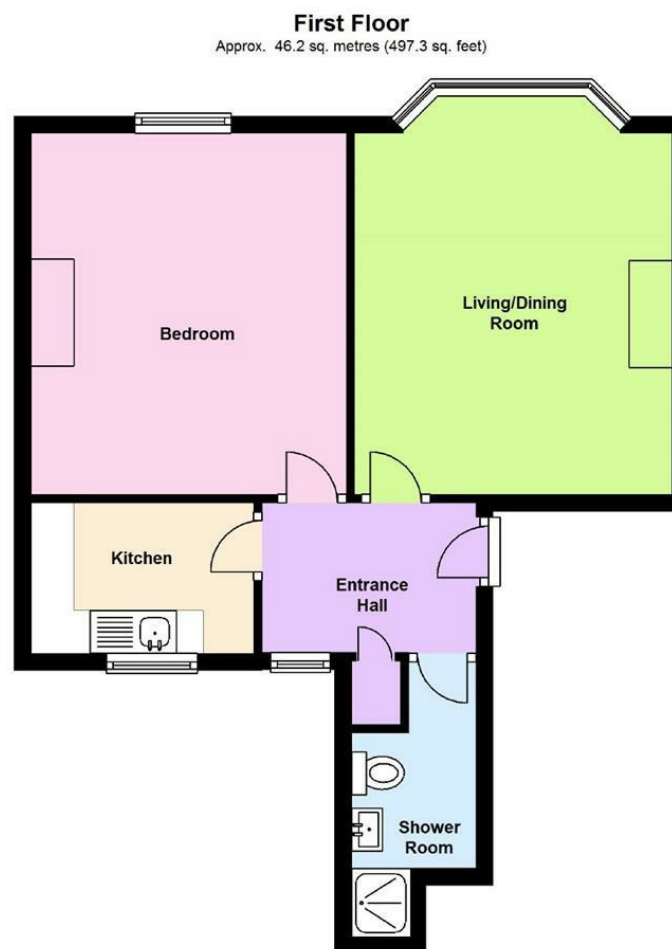

Total area: approx. 46.2 sq. metres (497.3 sq. feet)

We accept no responsibility for any mistake or inaccuracy contained within the floorplan. The floorplan is provided as a guide only and should be taken as an illustration only. The measurements, contents and positioning are approximations only and provided as a guidance tool and not an exact replication of the property.
Plan produced using PlanUp.

These particulars, whilst believed to be accurate are set out as a general outline only for guidance and do not constitute any part of an offer or contract. Intending purchasers should not rely on them as statements of representation of fact, but must satisfy themselves by inspection or otherwise as to their accuracy. No person in this firm's employment has the authority to make or give any representation or warranty in respect of the property.