

5, Greenfields Gardens, Ellesmere Grange, Shrewsbury, SY1 2RN
£775 Per Month



5, Greenfields Gardens, Ellesmere Grange, Shrewsbury, SY1 2RN

£775 Per Month

VIRTUAL TOUR AVAILABLE - Well maintained two double bedroom ground floor apartment located in a modern development close to Shrewsbury town centre in the popular residential area of Greenfields. Includes allocated parking space.

Available: 04/07/25

Description

Comprising: Communal Entrance Hall, Hall with Storage Cupboard, Spacious Living Room, Fitted Kitchen including Oven, Hob, Fridge/Freezer and Washing Machine, Master Bedroom including En-Suite Shower Room, Double Bedroom, Family Bathroom. Full Double Glazing, Bike Store, Allocated Parking Space. EPC C



Unfurnished

Council Tax Band: B

Available: 4th July 2025

EPC: C



Floor Plans

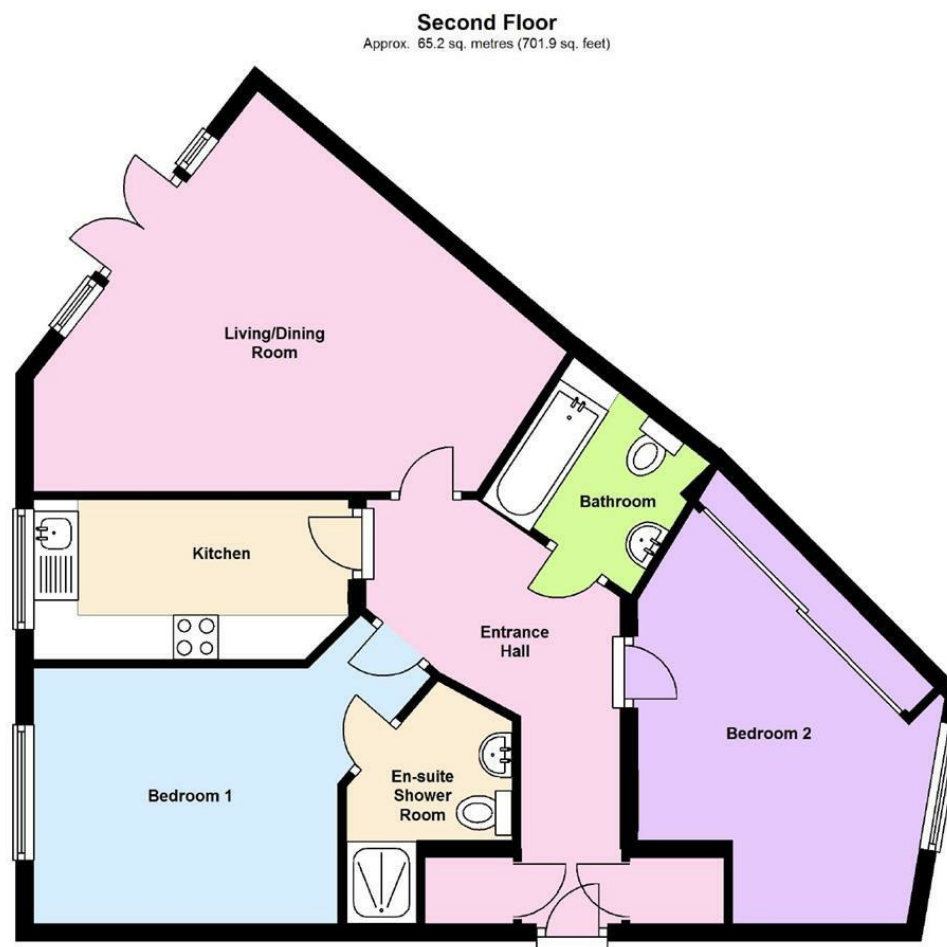

Total area: approx. 65.2 sq. metres (701.9 sq. feet)

We accept no responsibility for any mistake or inaccuracy contained within the floorplan. The floorplan is provided as a guide only and should be taken as an illustration only. The measurements, contents and positioning are approximations only and provided as a guidance tool and not an exact replication of the property.
Plan produced using PlanUp.

These particulars, whilst believed to be accurate are set out as a general outline only for guidance and do not constitute any part of an offer or contract. Intending purchasers should not rely on them as statements of representation of fact, but must satisfy themselves by inspection or otherwise as to their accuracy. No person in this firm's employment has the authority to make or give any representation or warranty in respect of the property.