



24, Brookfield, Bayston Hill, Shrewsbury, SY3 0LH
£1,200 Per Month



24, Brookfield, Bayston Hill, Shrewsbury, SY3 0LH

£1,200 Per Month

VIRTUAL TOUR AVAILABLE - An extended three bedroom semi-detached home offering balanced accommodation and benefitting from an integrated garage and open plan kitchen/dining space. Located in Bayston Hill, this property is in an excellent position for access to road networks and local amenities.

Available from: Immediately

Description

Comprising: porch, entrance hall, living room, dining space, conservatory, kitchen/breakfast area with integrated oven, dishwasher and hob, space for other appliances, access through to garage. Stairs to landing, two double bedrooms, further single bedroom, shower room. Rear garden with patio area, shed and summer house. Driveway parking. Gas central heating. Double glazing. EPC TBC.



Unfurnished

Council Tax Band: C

Available: 5th May 2025

EPC:

Floor Plans

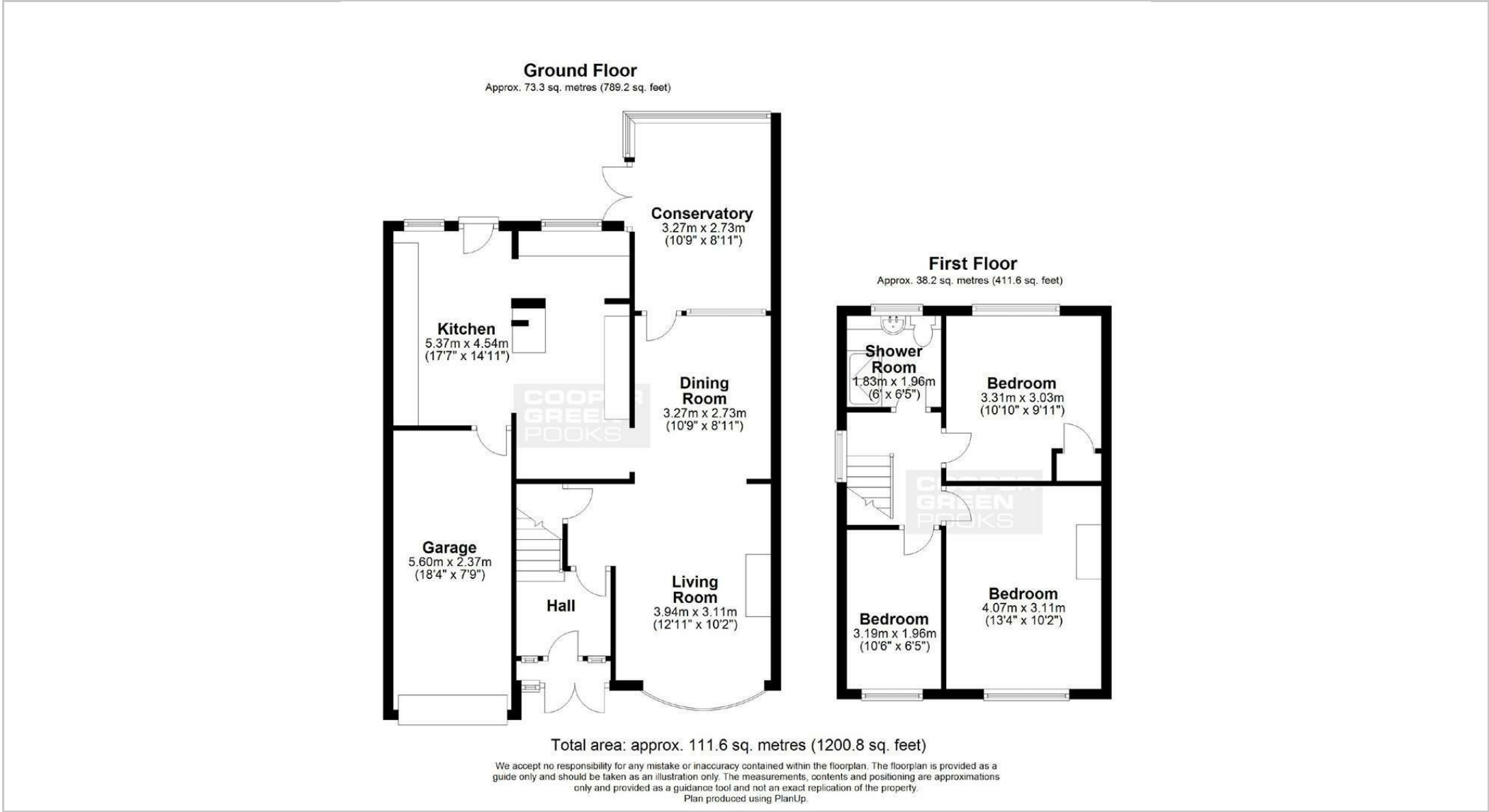

These particulars, whilst believed to be accurate are set out as a general outline only for guidance and do not constitute any part of an offer or contract. Intending purchasers should not rely on them as statements of representation of fact, but must satisfy themselves by inspection or otherwise as to their accuracy. No person in this firms employment has the authority to make or give any representation or warranty in respect of the property.