



40 Woodfield Avenue, Porthill, Shrewsbury SY3 8HT

4 bedroom semi-detached house—Offers in the region of £450,000 Freehold

40 Woodfield Avenue, Porthill, Shrewsbury SY3 8HT

Offers in the region of £450,000 Freehold—4 bedroom semi-detached house
sales@cgpooks.co.uk

This attractive and extended 4 bedroom semi detached house offers really good family accommodation, in a very popular location with a large private rear garden, whilst also being a short walk from Woodfield school, the Quarry park and town centre.

KEY FEATURES

- Entrance hall with Victorian style tiled flooring and cloakroom.
- Living room with open fireplace and bay window to front.
- Dining/family room with feature fireplace, glazed double doors to conservatory and wood flooring which also runs into the adjoining kitchen.
- The good sized fitted kitchen has an extensive range of fitted units, window to side and glazed double doors to the rear sun terrace and garden.
- Staircase from hall to the first floor landing where there are 3 bedrooms and a family bathroom with separate shower.
- From the inner landing there is a door to a further staircase which leads to the second floor 4th double bedroom, which has roof lights to 2 elevations.
- Double glazed windows and gas fired central heating.
- Driveway providing parking for about 2 cars, from which there is gated access along the side to the rear.
- Extensive private paved sun terrace adjoining the rear of the property, where there is also a sizable garden store.
- Large private lawned rear garden with established hedging and trees.
- Great location on a very popular street, within catchment for good school, as well as being close to the neighborhood store and a short walk from the riverside boathouse pub/restaurant, Quarry park and town centre.

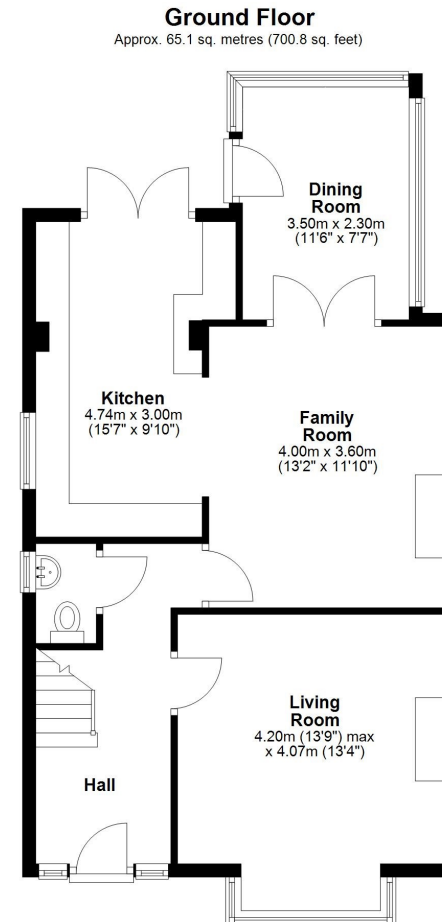

Coopergreenpooks.co.uk

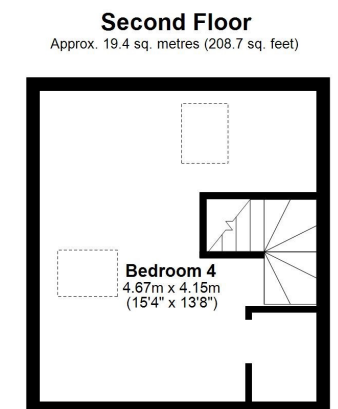
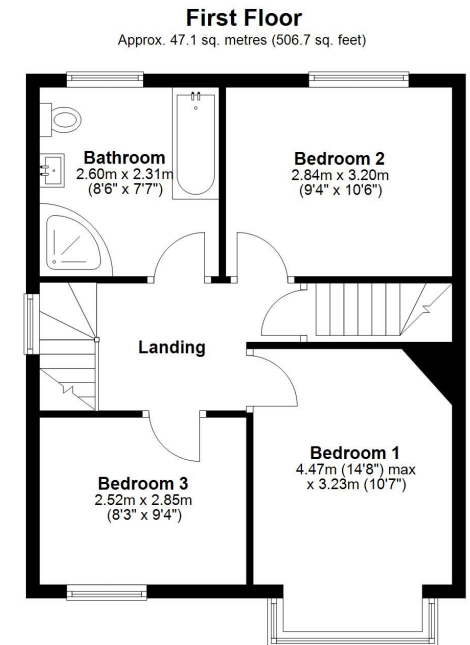

Total area: approx. 131.6 sq. metres (1416.2 sq. feet)









40 Woodfield Avenue, Porthill, Shrewsbury SY3 8HT

Offers in the region of £450,000 Freehold—4 bedroom semi-detached house
sales@cgpooks.co.uk

rightmove

onTheMarket.com

RICS®
Regulated by RICS

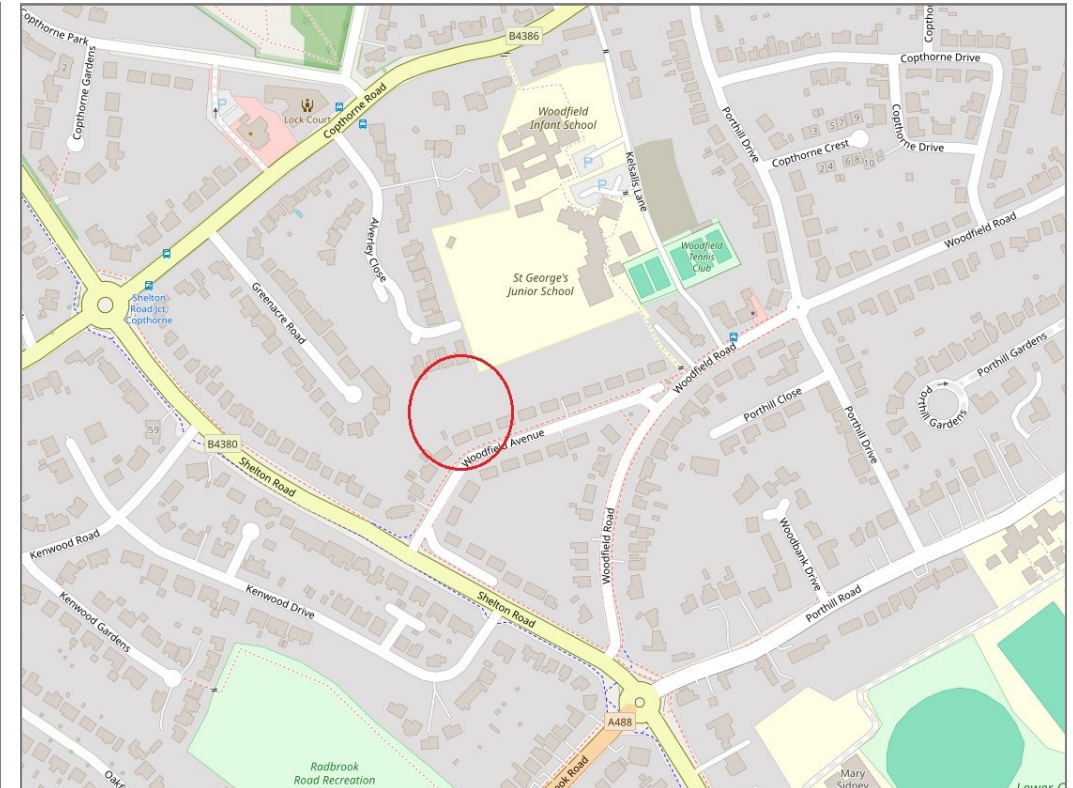
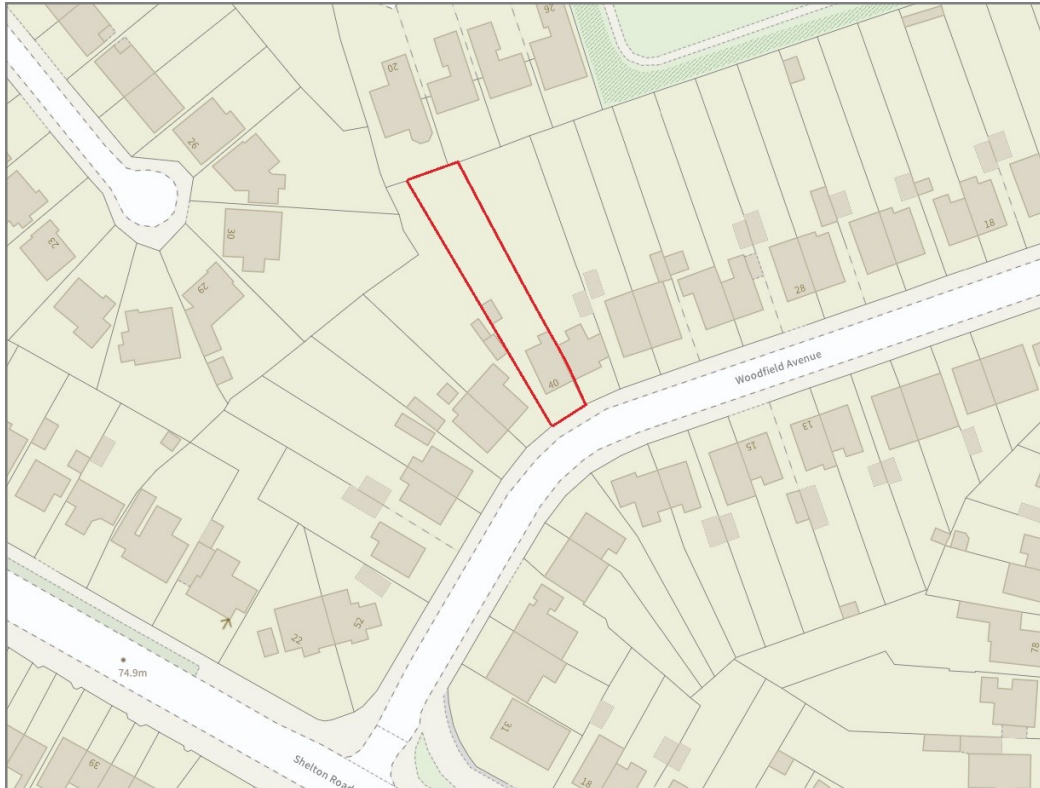

BOUNDARIES NOT CONFIRMED

Tenure	Freehold
Local Authority	Shropshire Council
Council Tax	Band C
EPC Band	TBC
Services	All mains services are connected

Expert mortgage advice available

3 Barker St, Shrewsbury SY1 1QF

Cooper Green Pooks
01743 276666



Your home may be repossessed if you do not keep up repayments on your mortgage.

There may be a fee for mortgage advice. The actual amount you pay will depend upon your circumstances. The fee is up to 1% but a typical fee is 0.3% of the amount borrowed.

40 Woodfield Avenue, Porthill, Shrewsbury SY3 8HT

Coopergreenpooks.co.uk

Offers in the region of £450,000 Freehold—4 bedroom semi-detached house

sales@cgpooks.co.uk

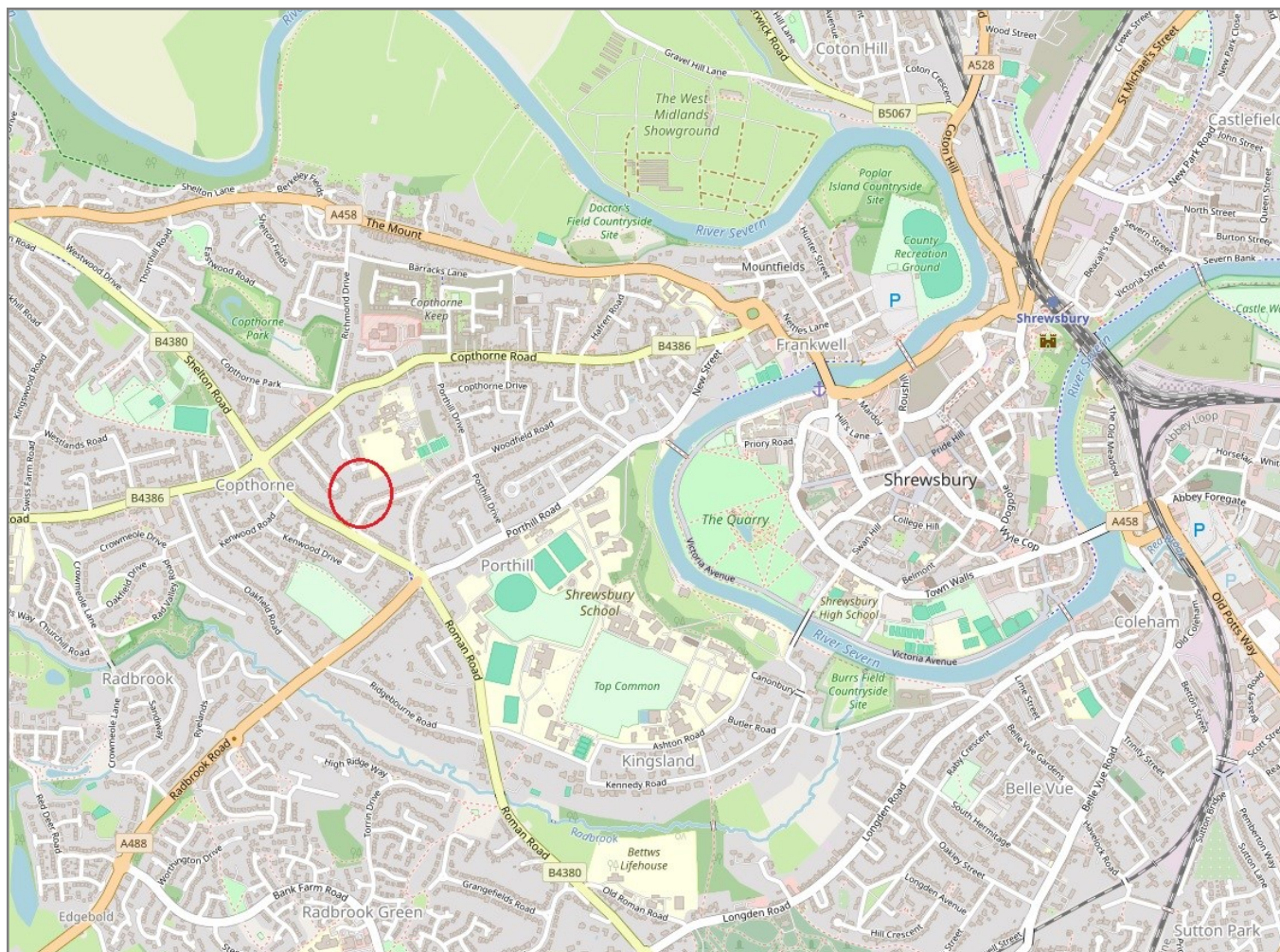

IMPORTANT NOTICE: Cooper Green Pooks for themselves and for the lessors or vendors of this property whose agents they are give notice that: 1 No appliances, services or service installations have been tested and no warranty as to suitability or serviceability is implied. Any prospective purchaser or lessee is advised to obtain verification from their surveyor or solicitor. 2. The particulars are set out as a general outline only for the guidance of the intended purchasers or lessees and do not constitute, nor constitute part of, an offer or contract. 3. All descriptions, reference to condition and necessary permissions for use and occupation and other details are given in good faith and are believed to be correct but any intending purchasers or lessees should not rely on them as statements or representation of fact but satisfy themselves by inspection or otherwise as to the correctness of each of them. 4. No person in the employment of Cooper Green Pooks has any authority to make or give any representation or warranty whatsoever in relation to this property. 5. All rentals and prices are quoted exclusive of Stamp Duty, legal and surveyors fees and any other associated purchasers or lessees costs. 6. Floor plans are indicative only and should not be relied on. 7. The plan showing the boundary of the property is indicative only and has not been checked against the legal title so should not be relied on. 8. All dimensions, floor areas and site areas are only approximate and should not be relied on. Dimensions are generally maximum room dimension.