



**55 Leighton Park, Bicton Heath, Shrewsbury SY3 5FS**  
2 bedroom apartment—£220,000 Leasehold



## 55 Leighton Park, Bicton Heath, Shrewsbury SY3 5FS

Coopergreenpooks.co.uk

£220,000 Leasehold—2 bedroom apartment

sales@cgpooks.co.uk

Occupying an elevated position within the stunning Central Hall, this beautifully presented apartment offers very well-proportioned and thoughtfully designed accommodation, with a lovely outlook over landscaped communal gardens and parkland, and benefitting from two private parking spaces.

### KEY FEATURES

- Good sized entrance hall with plenty of useful storage
- Impressive open plan kitchen/dining/living room with windows to two elevations
- A range of well-fitted units to the kitchen, complete with integrated appliances
- Master bedroom with built in wardrobe and en-suite shower room
- A further double bedroom and separate well-appointed family bathroom
- Gas fired central heating and secondary glazed windows
- Allocated parking for two cars as well as additional visitor spaces
- Situated within an imposing building of character, converted by Shropshire Homes, surrounded by stunning communal gardens and established parkland for residents to enjoy
- Conveniently located, just a short distance from Bicton Heath's excellent range of amenities, the Royal Shrewsbury Hospital, road links via the bypass, and less than two miles from the town centre.

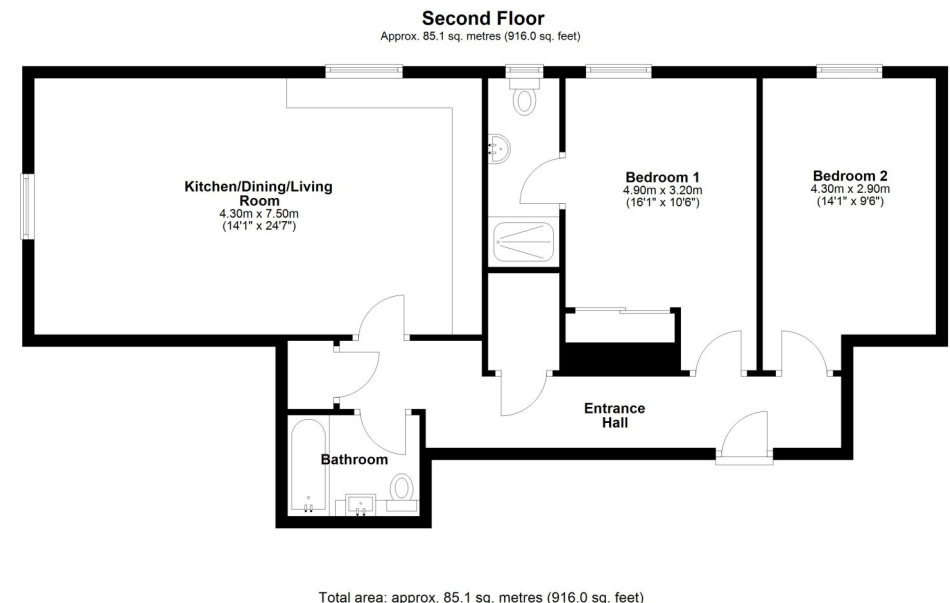

Cooper Green Pooks  
3 Barker Street  
Shrewsbury  
SY1 1QF

www.cgpooks.co.uk  
sales@cgpooks.co.uk  
01743 276666



















# 55 Leighton Park, Bicton Heath, Shrewsbury SY3 5FS

£220,000 Leasehold—2 bedroom apartment

sales@cgpooks.co.uk

rightmove

onTheMarket.com

RICS  
Regulated by RICS

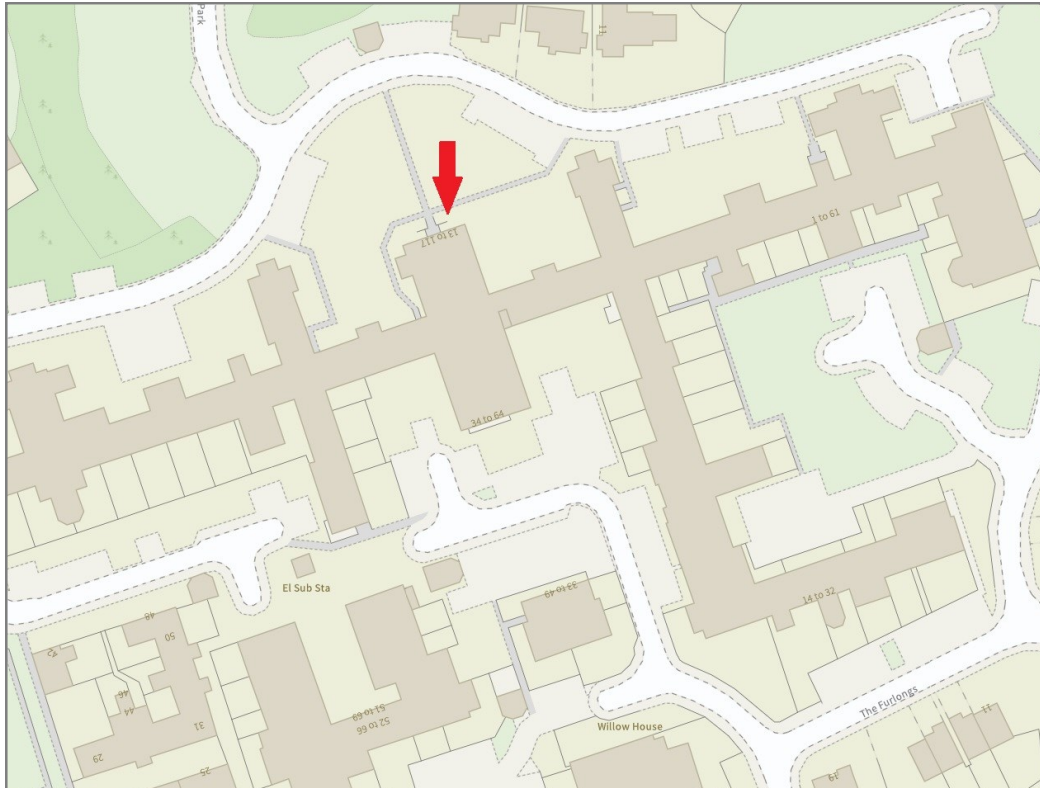

**BOUNDARIES NOT CONFIRMED**

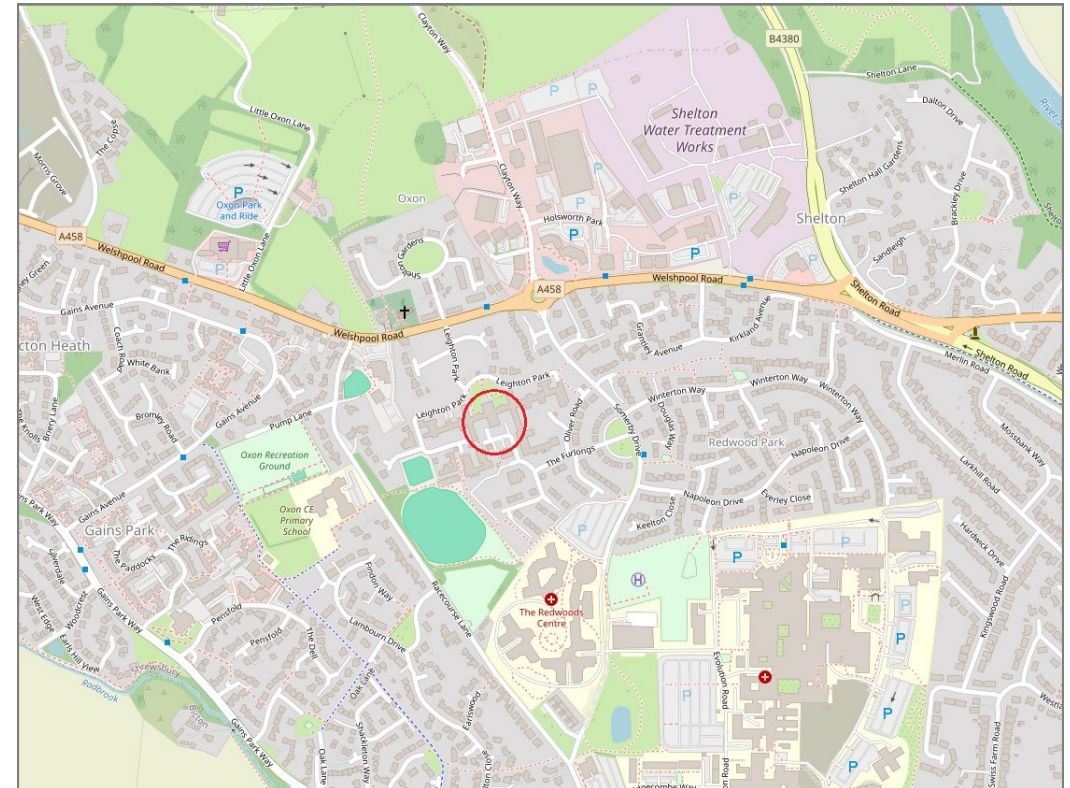

Tenure	<b>Leasehold</b>
Lease length	<b>199 years from 2019</b>
Service Charge	<b>£950 per 6 months</b>
Ground Rent	<b>£280 PA</b>

Local Authority	<b>Shropshire Council</b>
Council Tax	<b>Band B</b>
EPC Band	<b>Band C</b>
Services	<b>All mains services are connected</b>



# 55 Leighton Park, Bicton Heath, Shrewsbury SY3 5FS

Coopergreenpooks.co.uk

£220,000 Leasehold—2 bedroom apartment

sales@cgpooks.co.uk

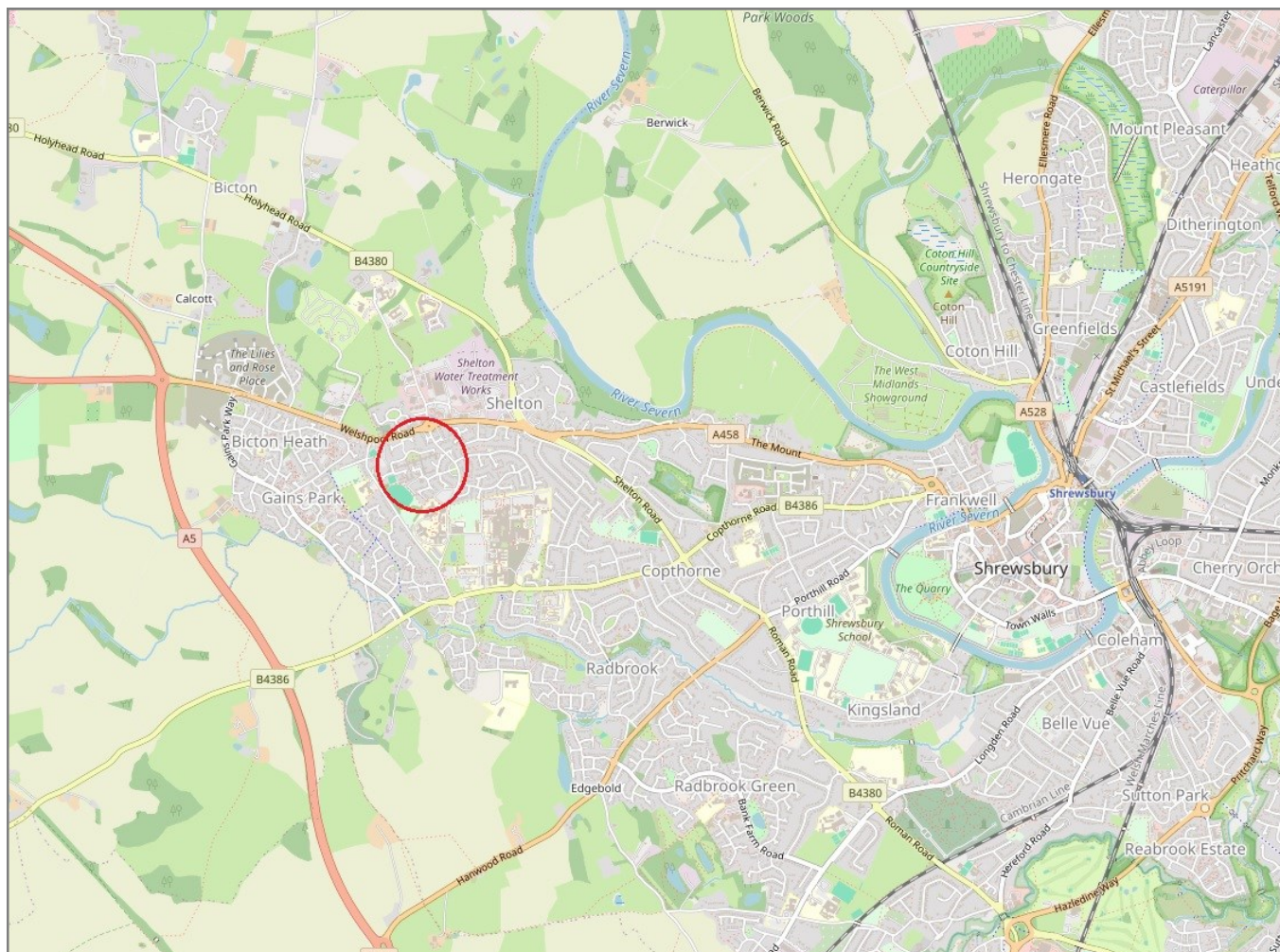

**IMPORTANT NOTICE:** Cooper Green Pooks for themselves and for the lessors or vendors of this property whose agents they are give notice that: 1 No appliances, services or service installations have been tested and no warranty as to suitability or serviceability is implied. Any prospective purchaser or lessee is advised to obtain verification from their surveyor or solicitor. 2. The particulars are set out as a general outline only for the guidance of the intended purchasers or lessees and do not constitute, nor constitute part of, an offer or contract. 3. All descriptions, reference to condition and necessary permissions for use and occupation and other details are given in good faith and are believed to be correct but any intending purchasers or lessees should not rely on them as statements or representation of fact but satisfy themselves by inspection or otherwise as to the correctness of each of them. 4. No person in the employment of Cooper Green Pooks has any authority to make or give any representation or warranty whatsoever in relation to this property. 5. All rentals and prices are quoted exclusive of Stamp Duty, legal and surveyors fees and any other associated purchasers or lessees costs. 6. Floor plans are indicative only and should not be relied on. 7. The plan showing the boundary of the property is indicative only and has not been checked against the legal title so should not be relied on. 8. All dimensions, floor areas and site areas are only approximate and should not be relied on. Dimensions are generally maximum room dimension.