



2 Rodney House, School Gardens, Shrewsbury SY1 2AJ

2 bedroom apartment—£250,000 Leasehold

2 Rodney House, School Gardens, Shrewsbury SY1 2AJ

Coopergreenpooks.co.uk

£250,000 Leasehold—2 bedroom apartment

sales@cgpooks.co.uk

Occupying a fantastic position, tucked away within the heart of the town centre, this attractive apartment of character offers well-proportioned accommodation, while benefitting from a lovely outlook and private parking.

KEY FEATURES

- Impressive communal entrance hall and turning staircase to the first floor
- Good sized inner hallway with plenty of useful storage
- Lovely open plan kitchen/dining room with feature fireplace and large window offering views to the rear
- Separate kitchen/breakfast room with a range of fitted units and space for appliances
- Two double bedrooms and a modern family bathroom with shower
- Allocated parking within a secluded courtyard
- This property forms part of a beautiful historic building of character, accessed via a very pretty cobbled street within the centre of town, a short walk from a range of bars/restaurants, main shopping areas, the Quarry Park and riverside walks

Cooper Green Pooks
3 Barker Street
Shrewsbury
SY1 1QF

www.cgpooks.co.uk
sales@cgpooks.co.uk
01743 276666



FIRST FLOOR
APPROX. 82.5 SQ. METRES (888.5 SQ. FEET)

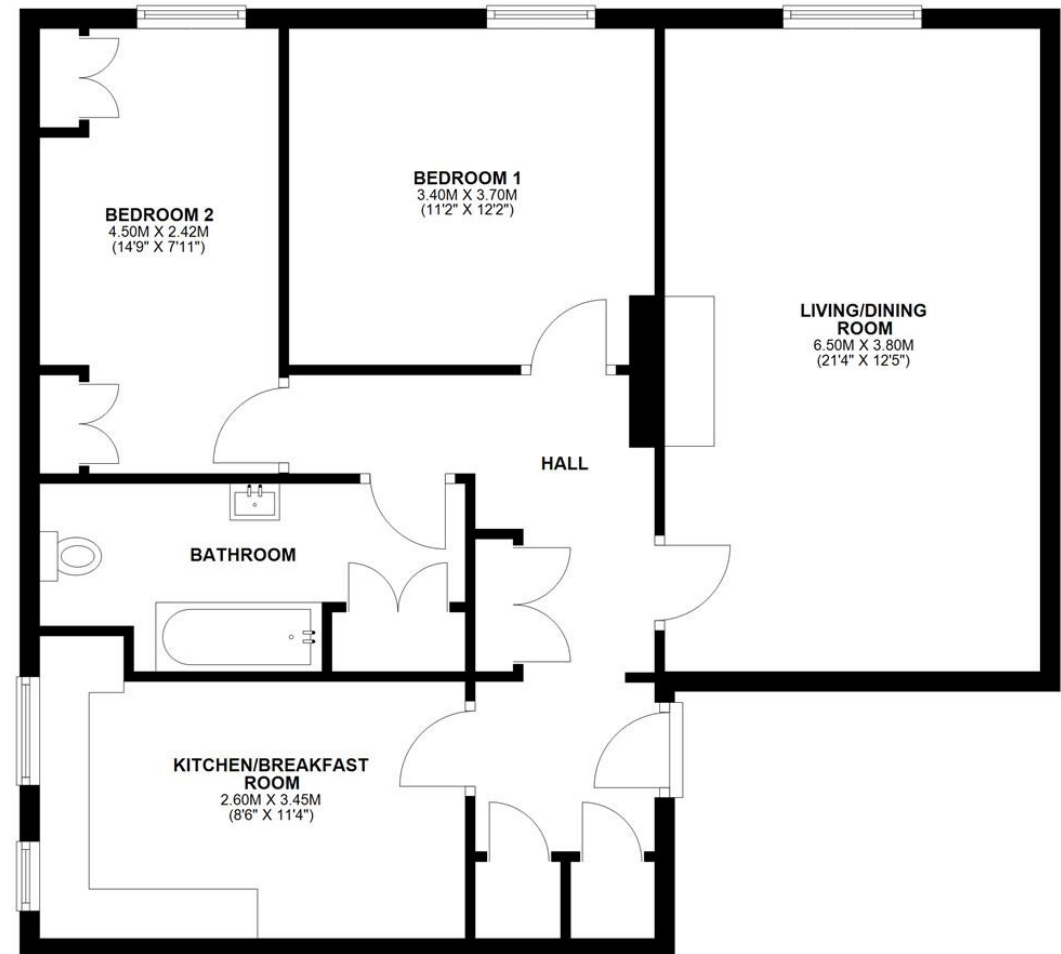

TOTAL AREA: APPROX. 82.5 SQ. METRES (888.5 SQ. FEET)







2 Rodney House, School Gardens, Shrewsbury SY1 2AJ

£250,000 Leasehold—2 bedroom apartment

sales@cgpooks.co.uk

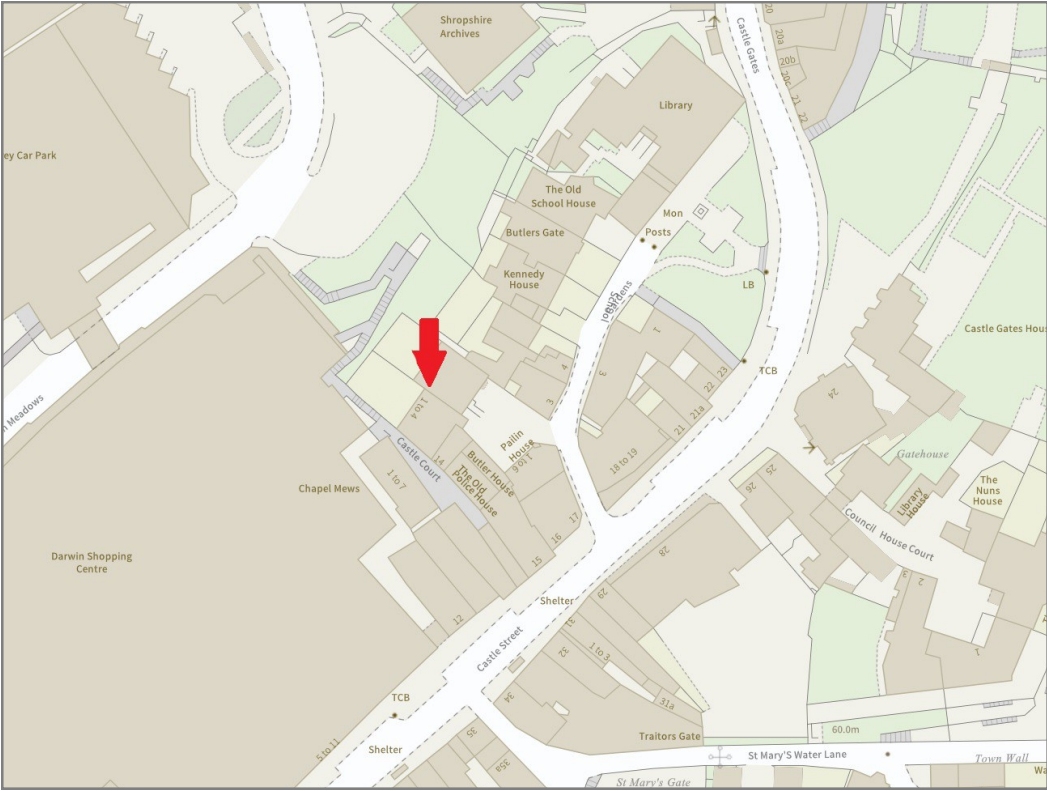

BOUNDARIES NOT CONFIRMED

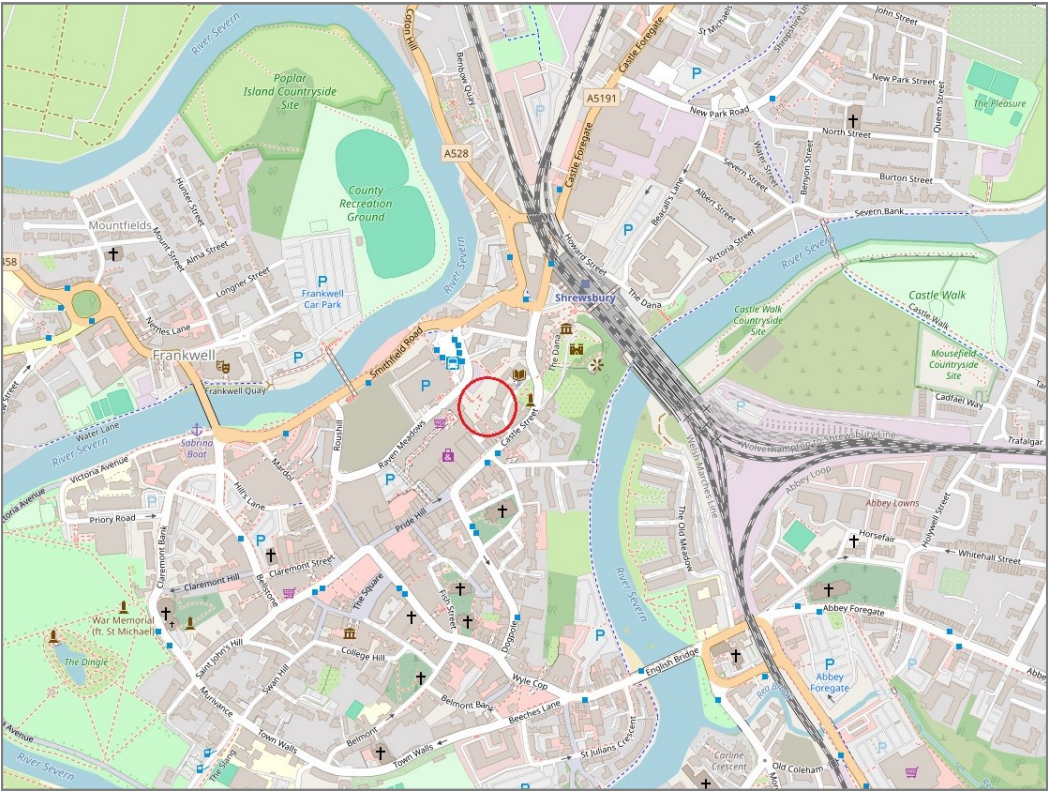

Tenure
Leasehold
Lease length
255 years from 2014 (244 years remaining)

Local Authority
Shropshire Council
Council Tax
Band B
EPC Band
Band D
Services
All mains services are connected