



3 Stokes Close, Copthorne, Shrewsbury, SY3 8FA

4 bedroom detached house — £500,000 Freehold

3 Stokes Close, Copthorne, Shrewsbury, SY3 8FA

£500,000 Freehold — 4 bedroom detached house

sales@cgpooks.co.uk

This beautifully presented detached house has been significantly upgraded and improved to provide thoughtfully designed accommodation finished to a high standard throughout, while benefitting from a landscaped rear garden, private driveway and detached garage. It is in a superb location within a popular modern development, just a short walk from the Quarry Park and town centre, as well as a choice of excellent primary and secondary schools.

KEY FEATURES

- Good sized entrance hall with cloakroom, useful under stairs storage and turning staircase to landing
- Living room with feature bay window to front
- Impressive open plan kitchen/dining/family room with additional storage and glazed double doors opening to the rear garden
- A range of well-fitted units to the kitchen area, complete with integrated appliances and breakfast bar
- Separate utility with further fitted units and access to side
- Lovely master bedroom with bay window and en-suite shower room
- Three further generous bedrooms and a well-appointed family bathroom
- uPVC double glazed windows and gas fired central heating
- Attractively landscaped rear garden, laid to lawn with specimen plants and trees, cobblestone paved terrace, pergola and greenhouse. There is also a purpose built home office/studio with power, lighting and double glazed windows and door
- Private driveway providing parking for two cars and access to the detached single garage

Coopergreenpooks.co.uk

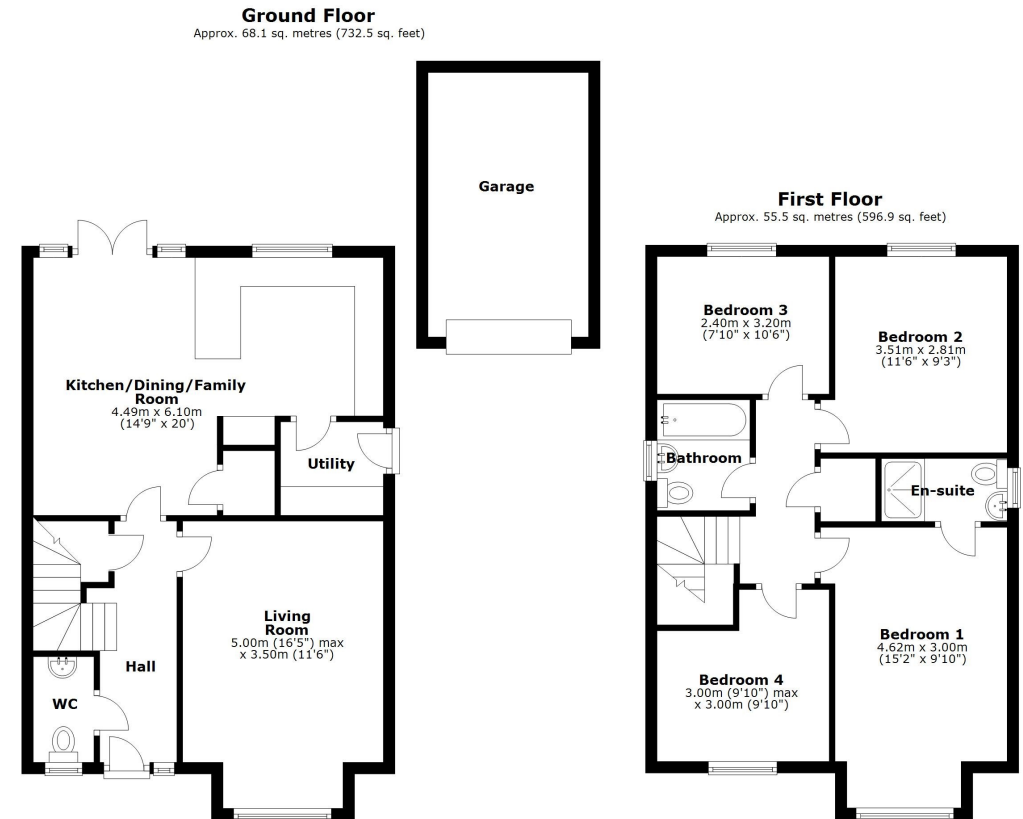

Total area: approx. 123.5 sq. metres (1329.4 sq. feet)

We accept no responsibility for any mistake or inaccuracy contained within the floorplan. The floorplan is provided as a guide only and should be taken as an illustration only. The measurements, contents and positioning are approximations only and provided as a guidance tool and not an exact replication of the property. Plan produced using PlanUp.









3 Stokes Close, Copthorne, Shrewsbury, SY3 8FA

£500,000 Freehold — 4 bedroom detached house

sales@cgpooks.co.uk



BOUNDARIES NOT CONFIRMED

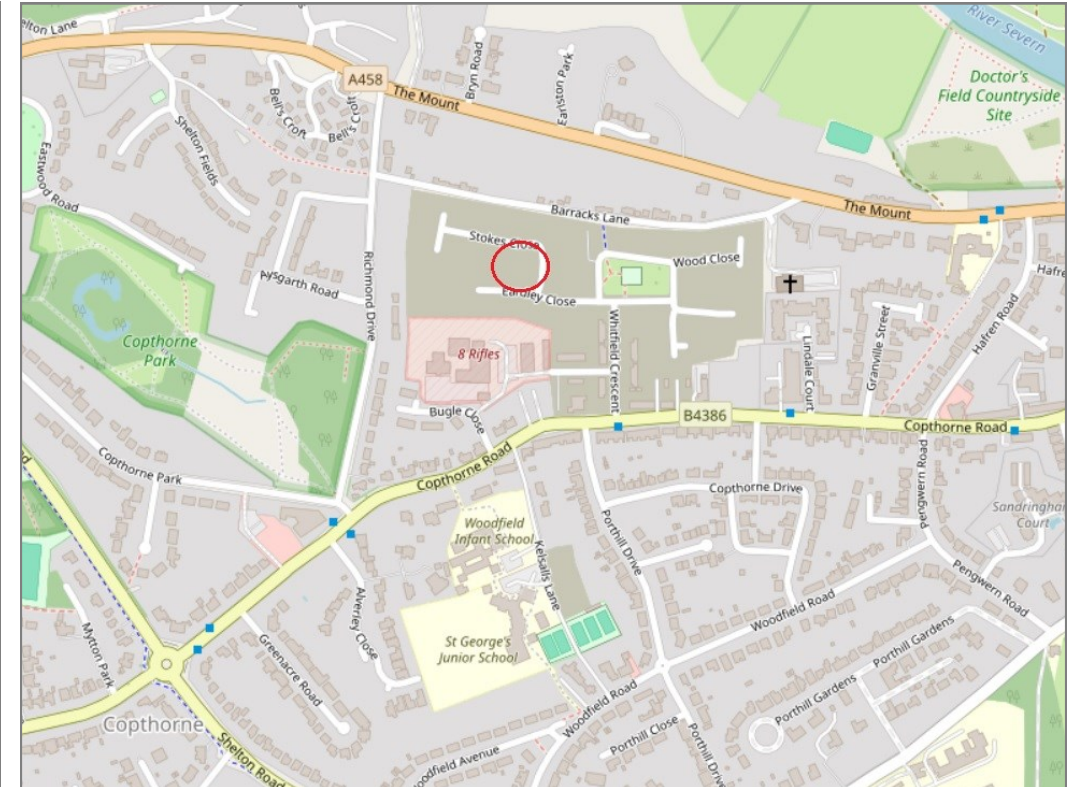

Tenure	Freehold
Local Authority	Shropshire Council
Council Tax	Band D
EPC Band	Band B
Services	All mains services are connected

Expert mortgage advice available
3 Barker St, Shrewsbury SY1 1QF
Cooper Green Pooks
01743 276666



Your home may be repossessed if you do not keep up repayments on your mortgage.
There may be a fee for mortgage advice. The actual amount you pay will depend upon your circumstances. The fee is up to 1% but a typical fee is 0.3% of the amount borrowed.

3 Stokes Close, Copthorne, Shrewsbury, SY3 8FA

Coopergreenpooks.co.uk

£500,000 Freehold — 4 bedroom detached house

sales@cgpooks.co.uk

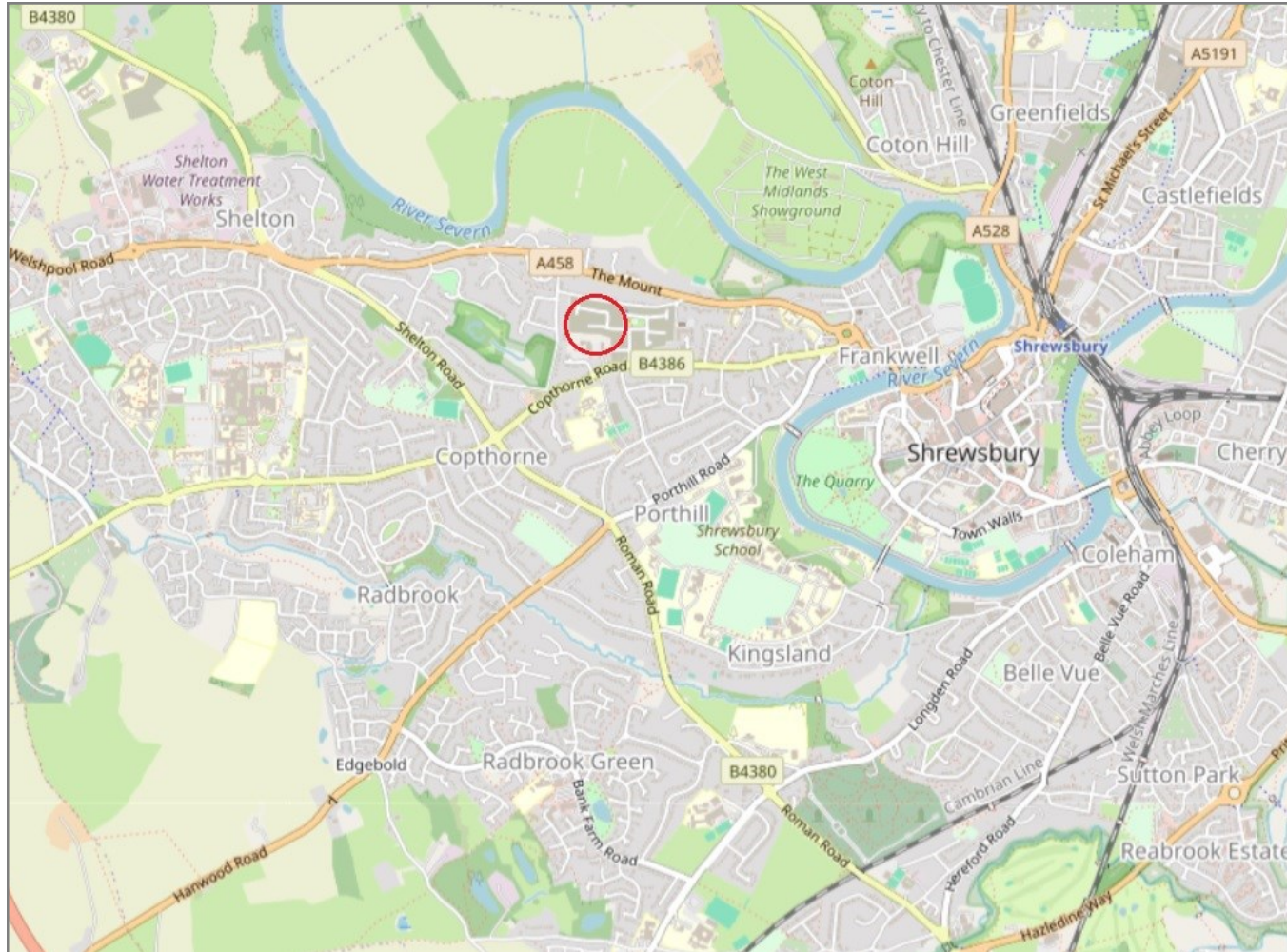

IMPORTANT NOTICE: Cooper Green Pooks for themselves and for the lessors or vendors of this property whose agents they are give notice that: 1 No appliances, services or service installations have been tested and no warranty as to suitability or serviceability is implied. Any prospective purchaser or lessee is advised to obtain verification from their surveyor or solicitor. 2. The particulars are set out as a general outline only for the guidance of the intended purchasers or lessees and do not constitute, nor constitute part of, an offer or contract. 3. All descriptions, reference to condition and necessary permissions for use and occupation and other details are given in good faith and are believed to be correct but any intending purchasers or lessees should not rely on them as statements or representation of fact but satisfy themselves by inspection or otherwise as to the correctness of each of them. 4. No person in the employment of Cooper Green Pooks has any authority to make or give any representation or warranty whatsoever in relation to this property. 5. All rentals and prices are quoted exclusive of Stamp Duty, legal and surveyors fees and any other associated purchasers or lessees costs. 6. Floor plans are indicative only and should not be relied on. 7. The plan showing the boundary of the property is indicative only and has not been checked against the legal title so should not be relied on. 8. All dimensions, floor areas and site areas are only approximate and should not be relied on. Dimensions are generally maximum room dimension.