



16 Kemble Drive, Radbrook, Shrewsbury, SY3 6AG

2 bedroom semi-detached house—£274,400 Freehold

16 Kemble Drive, Radbrook, Shrewsbury, SY3 6AG

£274,400 Freehold—2 bedroom semi-detached house

sales@cgpooks.co.uk

Occupying a lovely position at the end of a quiet cul-de-sac, this beautifully presented and extended semi-detached house offers thoughtfully designed accommodation with a contemporary finish, while benefitting from a landscaped rear garden and plenty of parking.

KEY FEATURES

- Entrance hall opening to a good sized living room with feature fireplace, decorative panelling and window to front
- Impressive extended kitchen/dining room with velux roof lights, useful under stairs pantry and glazed doors onto the rear garden
- A well-fitted range of units to the kitchen, complete with integrated appliances, Quartz work surfaces and a breakfast bar with solid oak worktop
- Two bedrooms with built in wardrobes and a separate family bathroom on the first floor
- uPVC double glazed windows and gas fired central heating
- Landscaped rear garden, laid to lawn with paved sun terraces, planted borders, timber store and gated access to side
- Driveway to front and side providing parking for at least four cars
- A superb location, just a short walk from Radbrook Green's excellent range of amenities, primary school, the Radbrook Nature Reserve, and within easy access of the town centre

Cooper Green Pooks
3 Barker Street
Shrewsbury
SY1 1QF

www.cgpooks.co.uk
sales@cgpooks.co.uk
01743 276666



Coopergreenpooks.co.uk

Ground Floor

Approx. 40.6 sq. metres (436.9 sq. feet)



First Floor

Approx. 27.6 sq. metres (297.1 sq. feet)

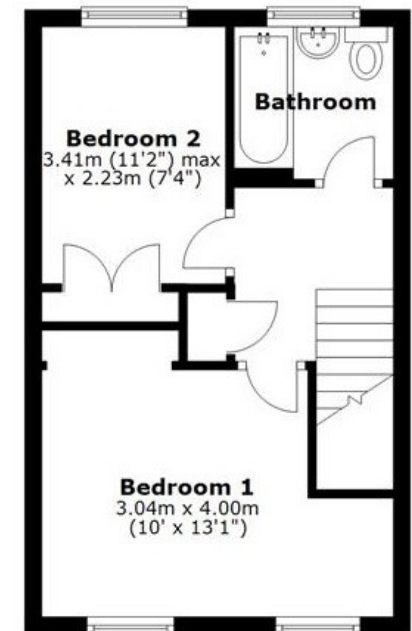

Total area: approx. 68.2 sq. metres (734.1 sq. feet)

We accept no responsibility for any mistake or inaccuracy contained within the floorplan. The floorplan is provided as a guide only and should be taken as an illustration only. The measurements, contents and positioning are approximations only and provided as a guidance tool and not an exact replication of the property.
Plan produced using PlanUp.





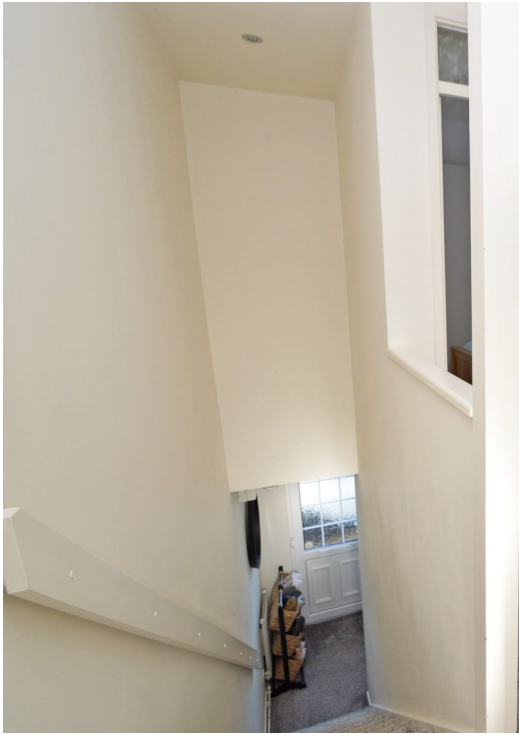



16 Kemble Drive, Radbrook, Shrewsbury, SY3 6AG

£274,400 Freehold—2 bedroom semi-detached house

sales@cgpooks.co.uk

rightmove

onTheMarket.com

RICS
Regulated by RICS



BOUNDARIES NOT CONFIRMED

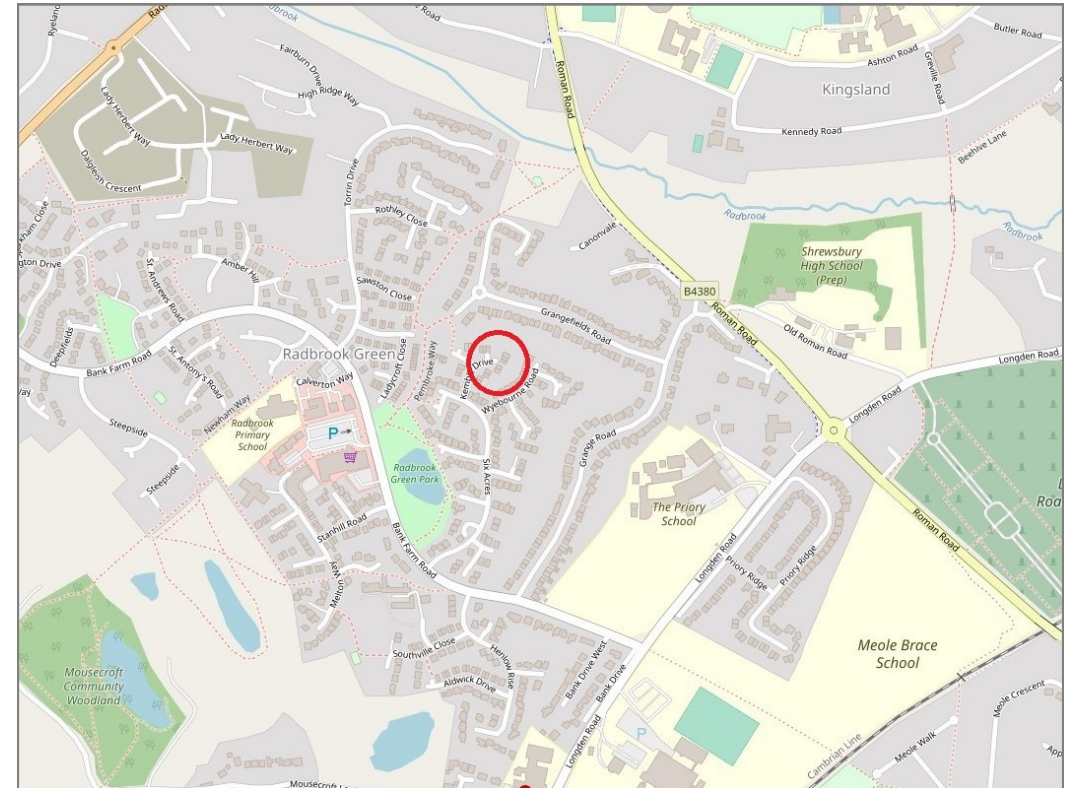

Tenure	Freehold
Local Authority	Shropshire Council
Council Tax	Band B
EPC Band	Band C
Services	All mains services are connected

Expert mortgage advice available

3 Barker St, Shrewsbury SY1 1QF

Cooper Green Pooks
01743 276666



Your home may be repossessed if you do not keep up repayments on your mortgage.

There may be a fee for mortgage advice. The actual amount you pay will depend upon your circumstances. The fee is up to 1% but a typical fee is 0.3% of the amount borrowed.

16 Kemble Drive, Radbrook, Shrewsbury, SY3 6AG

Coopergreenpooks.co.uk

£274,400 Freehold—2 bedroom semi-detached house

sales@cgpooks.co.uk

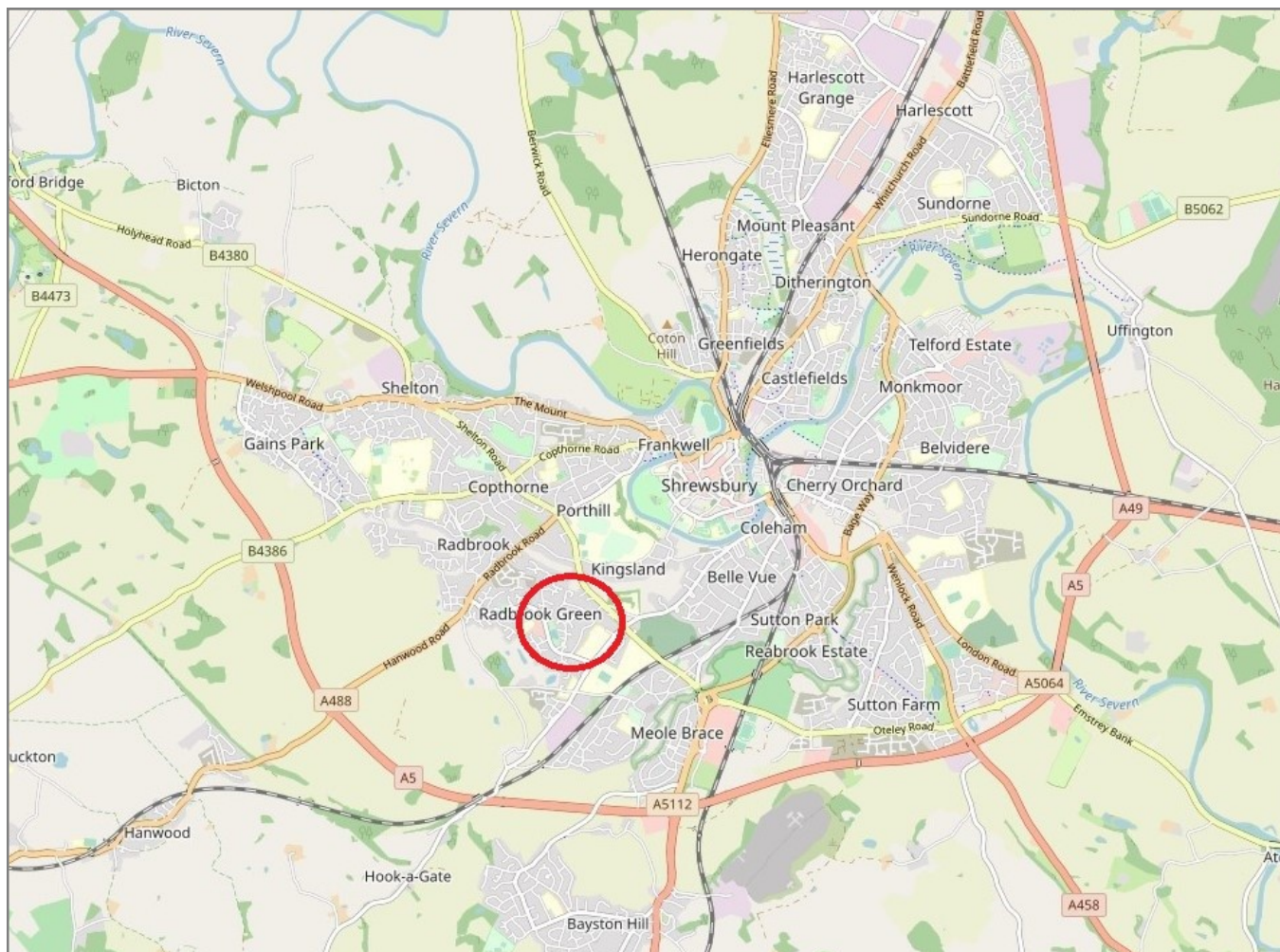

IMPORTANT NOTICE: Cooper Green Pooks for themselves and for the lessors or vendors of this property whose agents they are give notice that: 1 No appliances, services or service installations have been tested and no warranty as to suitability or serviceability is implied. Any prospective purchaser or lessee is advised to obtain verification from their surveyor or solicitor. 2. The particulars are set out as a general outline only for the guidance of the intended purchasers or lessees and do not constitute, nor constitute part of, an offer or contract. 3. All descriptions, reference to condition and necessary permissions for use and occupation and other details are given in good faith and are believed to be correct but any intending purchasers or lessees should not rely on them as statements or representation of fact but satisfy themselves by inspection or otherwise as to the correctness of each of them. 4. No person in the employment of Cooper Green Pooks has any authority to make or give any representation or warranty whatsoever in relation to this property. 5. All rentals and prices are quoted exclusive of Stamp Duty, legal and surveyors fees and any other associated purchasers or lessees costs. 6. Floor plans are indicative only and should not be relied on. 7. The plan showing the boundary of the property is indicative only and has not been checked against the legal title so should not be relied on. 8. All dimensions, floor areas and site areas are only approximate and should not be relied on. Dimensions are generally maximum room dimension.