



18, Mount Way, Pontesbury, SY5 0RB
£750 Per Month



18, Mount Way, Pontesbury, SY5 0RB

£750 Per Month

VIRTUAL TOUR AVAILABLE - An attractive three bedroom detached property situated in a popular residential area within Pontesbury, to the South West of Shrewsbury. Driveway Parking and single garage.

Available: 18/10/24

Description

Comprising: Porch, dining room, front-to-back living room with door to rear garden, kitchen with space for freestanding washing machine, fridge/freezer and cooker, door to rear garden, three double bedrooms with integrated storage, bathroom with shower over bath. Ample driveway parking, single garage. Front and rear gardens. Oil fired central heating. Double glazed windows. EPC D.



Unfurnished

Council Tax Band: D

Available: 18th October 2024

EPC: D

Floor Plans

Ground Floor

Approx. 47.8 sq. metres (515.0 sq. feet)

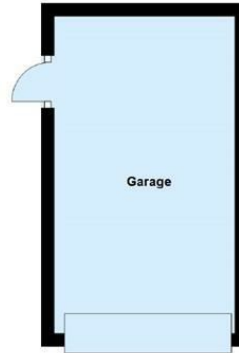

First Floor

Approx. 48.6 sq. metres (523.2 sq. feet)

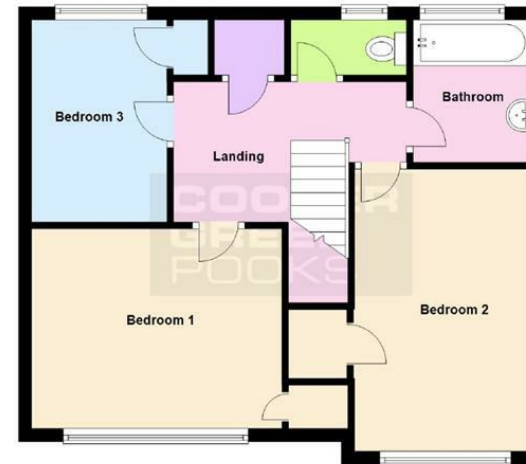

Total area: approx. 96.5 sq. metres (1038.2 sq. feet)

We accept no responsibility for any mistake or inaccuracy contained within the floorplan. The floorplan is provided as a guide only and should be taken as an illustration only. The measurements, contents and positioning are approximations only and provided as a guidance tool and not an exact replication of the property.

Plan produced using PlanUp.

These particulars, whilst believed to be accurate are set out as a general outline only for guidance and do not constitute any part of an offer or contract. Intending purchasers should not rely on them as statements of representation of fact, but must satisfy themselves by inspection or otherwise as to their accuracy. No person in this firm's employment has the authority to make or give any representation or warranty in respect of the property.