



35 Wood Street, Greenfields, Shrewsbury SY1 2PN

2 bedroom semi-detached house—£275,000 Freehold

35 Wood Street, Greenfields, Shrewsbury SY1 2PN

Coopergreenpooks.co.uk

£275,000 Freehold—3 bedroom semi-detached house

sales@cgpooks.co.uk

This well-presented semi-detached house offers good accommodation over 3 floors with attractive features. The property is well situated on a quiet street, just a short walk from the town centre with a private south facing rear garden.

KEY FEATURES

- Covered entrance area to hall with door to dining room.
- Living room with wood effect flooring, along with a bay window to front and an oak and cast-iron open fire surround.
- Dining room providing access to both the living room and kitchen and a window to the rear.
- Separate fitted kitchen with large walk in store, window to rear and door to courtyard and garden.
- Staircase from hall to first floor landing where there are 2 double bedrooms with separate shower.
- Staircase from first to second floor landing where there is a further good sized double bedroom.
- Double glazed windows and gas fired central heating.
- Enclosed courtyard to the front of the property and gated access from the side to the rear, where there is a large sun terrace and an established south facing private garden.
- Great location on a quiet no through street in the popular Greenfields area, just a 5 minute walk from the railway station and town centre.

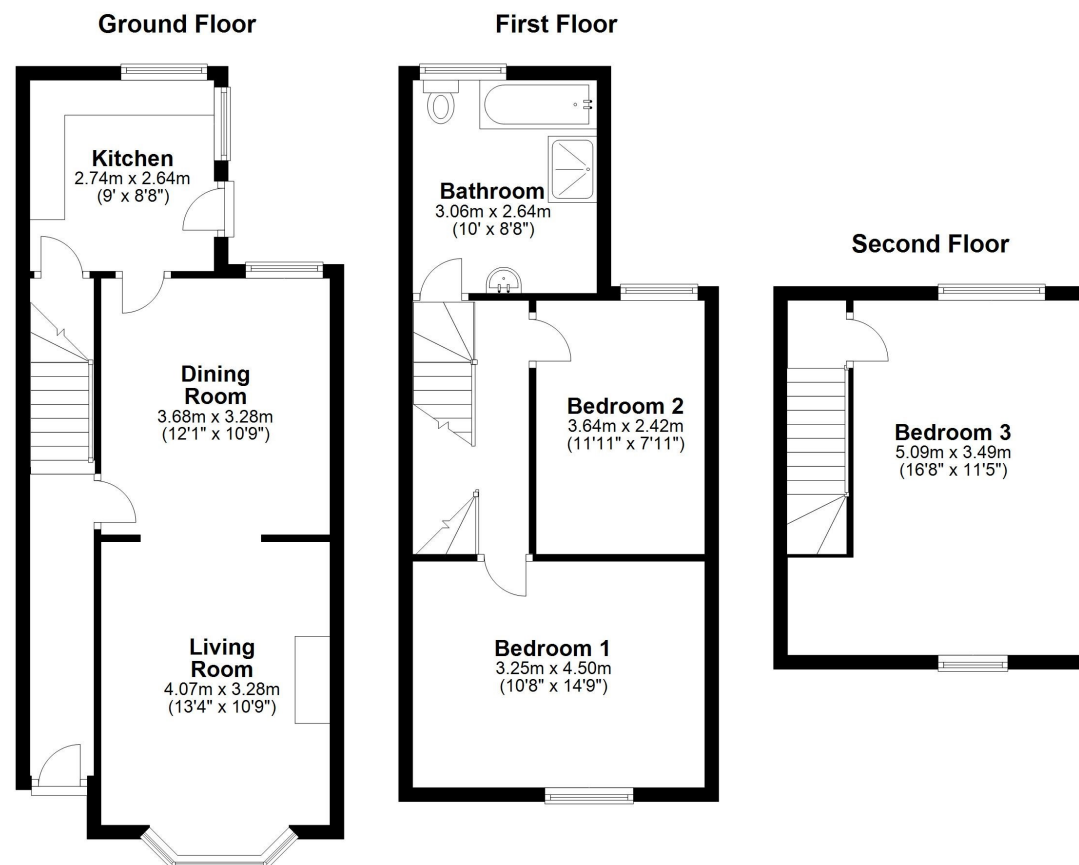

We accept no responsibility for any mistake or inaccuracy contained within the floorplan. The floorplan is provided as a guide only and should be taken as an illustration only. The measurements, contents and positioning are approximations only and provided as a guidance tool and not an exact replication of the property.
Plan produced using PlanUp.





35 Wood Street, Greenfields, Shrewsbury SY1 2PN

Coopergreenpooks.co.uk

£275,000 Freehold—3 bedroom semi-detached house

sales@cgpooks.co.uk



Cooper Green Pooks
3 Barker Street
Shrewsbury
SY1 1QF

www.cgpooks.co.uk
sales@cgpooks.co.uk
01743 276666



35 Wood Street, Greenfields, Shrewsbury SY1 2PN

£275,000 Freehold—3 bedroom semi-detached house

sales@cgpooks.co.uk

rightmove

onTheMarket.com

RICS
Regulated by RICS

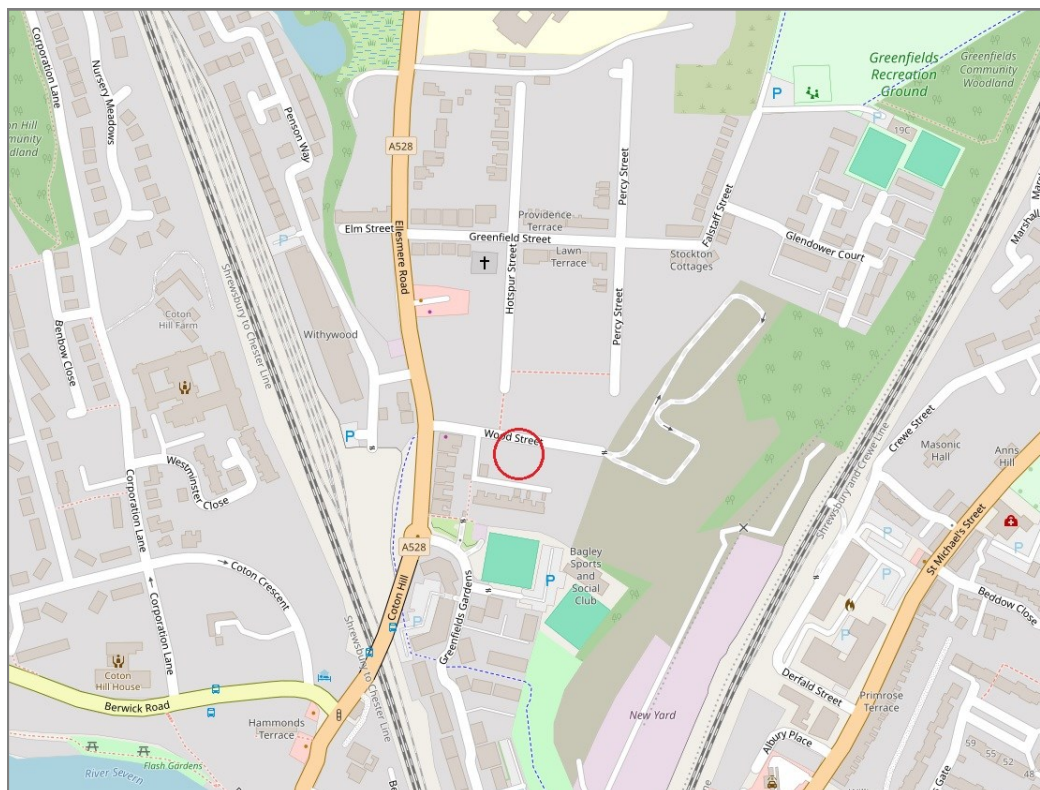
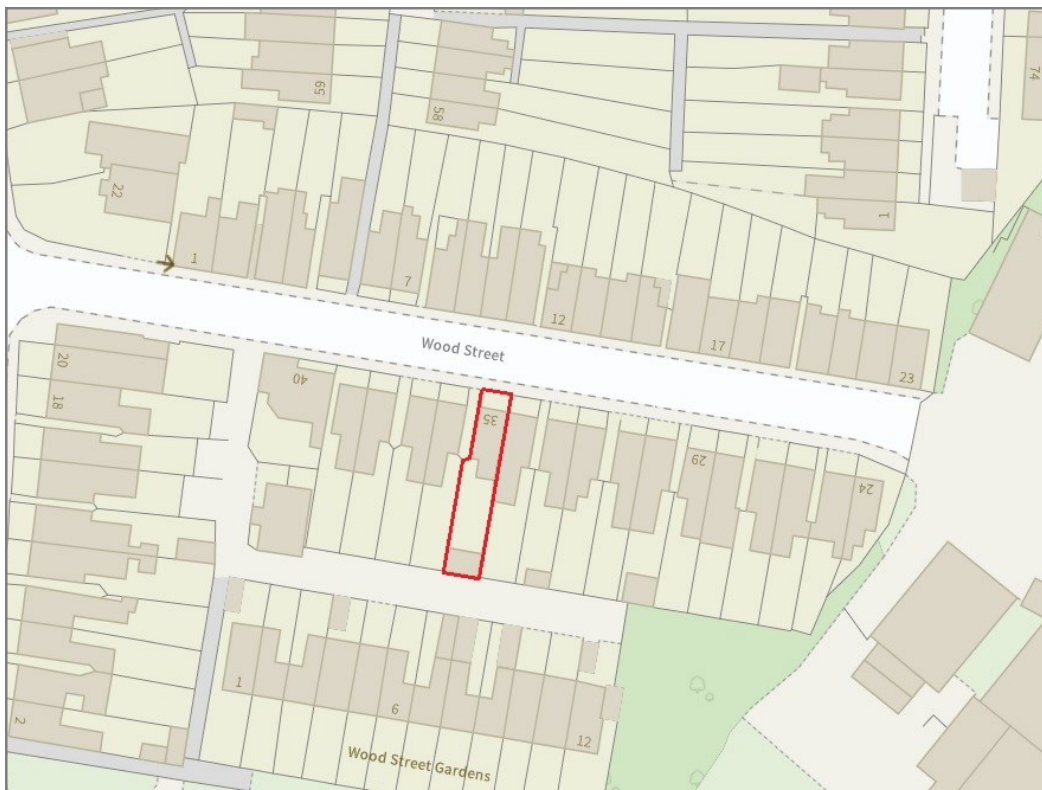

BOUNDARIES NOT CONFIRMED

Tenure	Freehold
Local Authority	Shropshire Council
Council Tax	Band B
EPC Band	Band D
Services	All mains services are connected

Expert mortgage advice available

3 Barker St, Shrewsbury SY1 1QF

Cooper Green Pooks
01743 276666



Your home may be repossessed if you do not keep up repayments on your mortgage.

There may be a fee for mortgage advice. The actual amount you pay will depend upon your circumstances. The fee is up to 1% but a typical fee is 0.3% of the amount borrowed.

35 Wood Street, Greenfields, Shrewsbury SY1 2PN

Coopergreenpooks.co.uk

£275,000 Freehold—3 bedroom semi-detached house

sales@cgpooks.co.uk

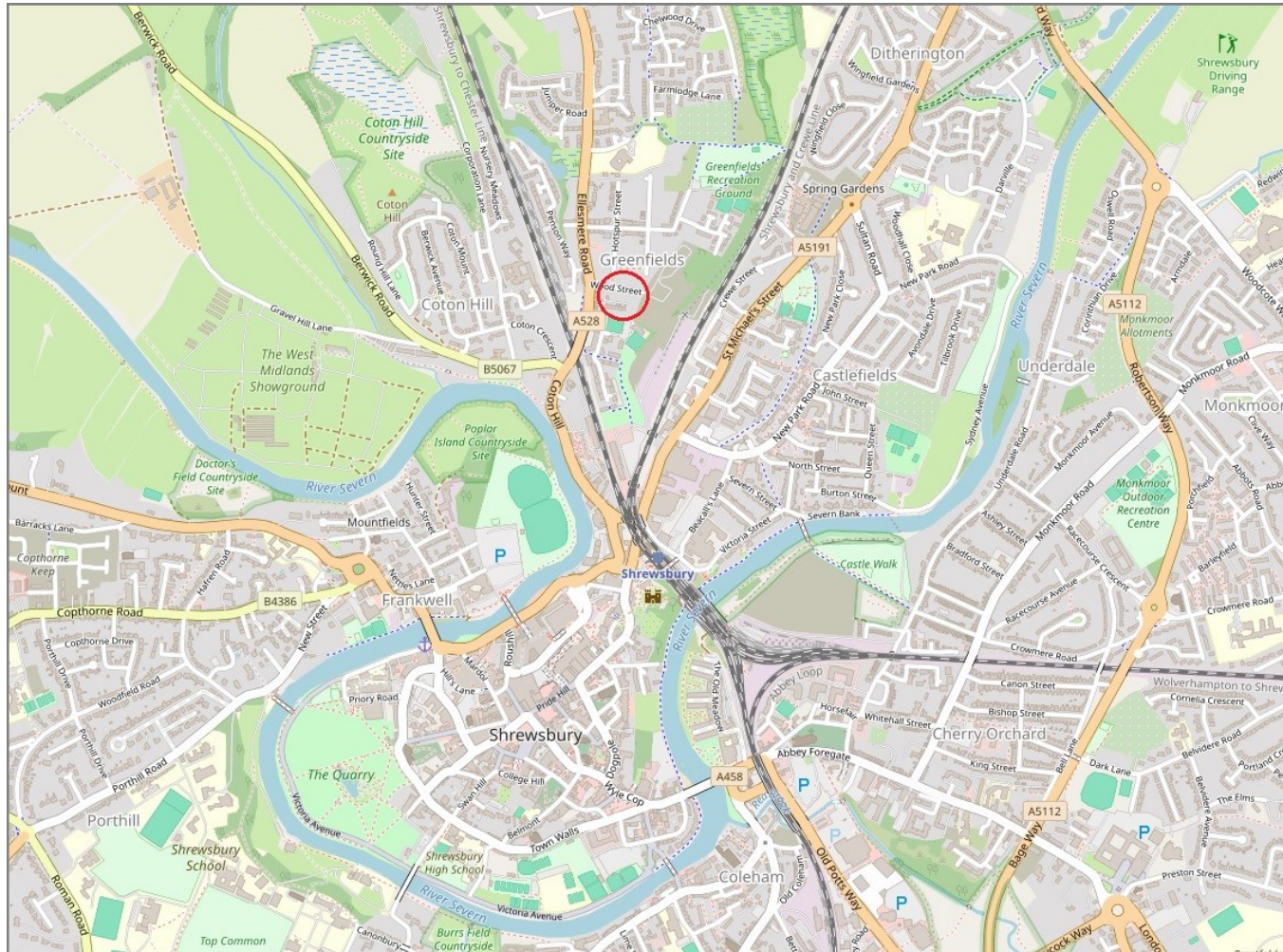

IMPORTANT NOTICE: Cooper Green Pooks for themselves and for the lessors or vendors of this property whose agents they are give notice that: 1 No appliances, services or service installations have been tested and no warranty as to suitability or serviceability is implied. Any prospective purchaser or lessee is advised to obtain verification from their surveyor or solicitor. 2. The particulars are set out as a general outline only for the guidance of the intended purchasers or lessees and do not constitute, nor constitute part of, an offer or contract. 3. All descriptions, reference to condition and necessary permissions for use and occupation and other details are given in good faith and are believed to be correct but any intending purchasers or lessees should not rely on them as statements or representation of fact but satisfy themselves by inspection or otherwise as to the correctness of each of them. 4. No person in the employment of Cooper Green Pooks has any authority to make or give any representation or warranty whatsoever in relation to this property. 5. All rentals and prices are quoted exclusive of Stamp Duty, legal and surveyors fees and any other associated purchasers or lessees costs. 6. Floor plans are indicative only and should not be relied on. 7. The plan showing the boundary of the property is indicative only and has not been checked against the legal title so should not be relied on. 8. All dimensions, floor areas and site areas are only approximate and should not be relied on. Dimensions are generally maximum room dimension.