

Flat 5 Thornes Hall, 28, Castle Street, Shrewsbury, SY1 2BQ
£1,100 Per Month



Flat 5 Thornes Hall, 28, Castle Street, Shrewsbury, SY1 2BQ

£1,100 Per Month

VIRTUAL TOUR AVAILABLE - Superb opportunity to rent a high quality two bedroom apartment in a recently renovated residential development in the heart of historic Shrewsbury. The development benefits from gated parking, lift access and high quality fixtures and fittings throughout. Situated in one of Shrewsbury's most recognizable buildings, the apartments occupy a fantastic position on this historic street a stone's throw from the castle, library and railway station.

Available: 28/08/24

Description

Comprising: Generous communal entrance hall including lift to first & second floor, attractive communal staircase, communal landing, private entrance hall including large store cupboard, superb modern kitchen including oven, induction hob, full sized integrated fridge / freezer and integrated dishwasher, living & dining area benefitting from large bay window with stunning views towards the Castle and grounds, attractive shower room with walk in shower and high end fittings, master bedroom, further double bedroom. The development benefits from a communal bike store and allocated (gated) parking for each apartment. Blinds included. EPC C



Unfurnished

Council Tax Band: B

Available: 28th August 2024

EPC: C

Floor Plans

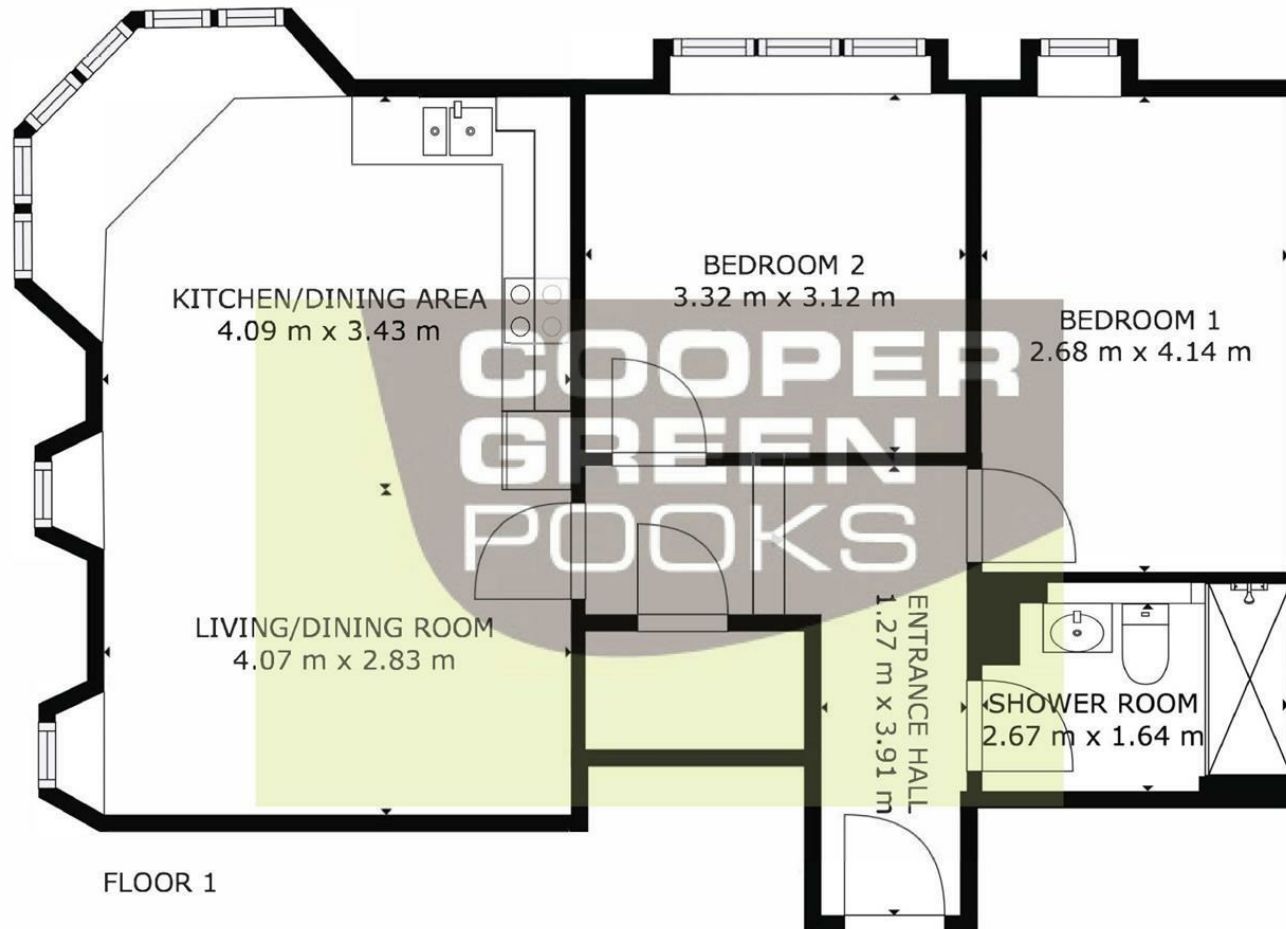

GROSS INTERNAL AREA
FLOOR 1: 69 m²
TOTAL: 69 m²

SIZES AND DIMENSIONS ARE APPROXIMATE, ACTUAL MAY VARY.



These particulars, whilst believed to be accurate are set out as a general outline only for guidance and do not constitute any part of an offer or contract. Intending purchasers should not rely on them as statements of representation of fact, but must satisfy themselves by inspection or otherwise as to their accuracy. No person in this firm's employment has the authority to make or give any representation or warranty in respect of the property.