

4 The Mews, St Julians Friars, Shrewsbury, SY1 1XN
£950 Per Month





4 The Mews, St Julians Friars, Shrewsbury, SY1 1XN

£950 Per Month

VIRTUAL TOUR AVAILABLE - Modern two bedroom ground floor apartment in Shrewsbury town centre on the edge of Quarry Park a Short Walk from the River Severn. Allocated driveway parking space.

Description

Comprising: Entrance Hall, Living Room, Breakfast Kitchen with White Goods, Two Double Bedrooms with Built in Wardrobes including One with En-Suite Shower Room, Bathroom including shower. Gas central heating, double glazing. Allocated Parking Space. EPC B



Unfurnished

Council Tax Band: B

Available: 10th July 2024

EPC: C

Floor Plans

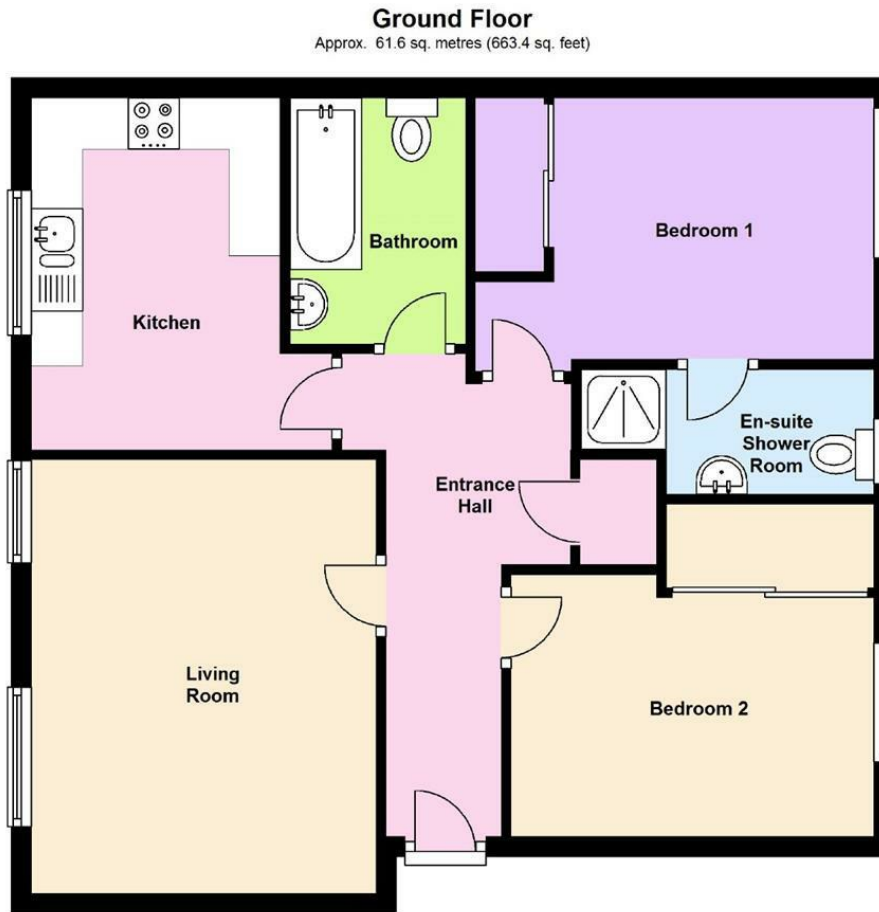

We accept no responsibility for any mistake or inaccuracy contained within the floorplan. The floorplan is provided as a guide only and should be taken as an illustration only. The measurements, contents and positioning are approximations only and provided as a guidance tool and not an exact replication of the property.
Plan produced using PlanUp.

These particulars, whilst believed to be accurate are set out as a general outline only for guidance and do not constitute any part of an offer or contract. Intending purchasers should not rely on them as statements of representation of fact, but must satisfy themselves by inspection or otherwise as to their accuracy. No person in this firm's employment has the authority to make or give any representation or warranty in respect of the property.