



**3 Bage Terrace, St Michaels Street, Shrewsbury, SY1 2HA**

2 bedroom town house—£199,950 Freehold

## 3 Bage Terrace, St Michaels Street, Shrewsbury, SY1 2HA

Coopergreenpooks.co.uk

£199,950 Freehold—2 bedroom town house

sales@cgpooks.co.uk

Located just a few minutes' walk from the town centre, this modern and well maintained 3 storey town house forms part of a terrace of just 4 properties with the benefit of an integral single garage.

### KEY FEATURES

- Entrance hall from which there is access to a separate fitted kitchen and cloakroom
- Open plan living/dining room with oak boarded flooring and Juliet balcony to the rear
- Staircase from living room to the lower ground floor, where there is a good-sized utility room with door connecting to the integral garage, which is approached via St Michaels Terrace
- From entrance hall, staircase to first floor landing, which provides access to the 2 double bedrooms and a bathroom
- Double glazed windows and gas fired central heating
- Constructed in 2007 and part of a development of just 4 properties
- Very convenient location, just a short walk from the railway station and town centre
- No onward chain

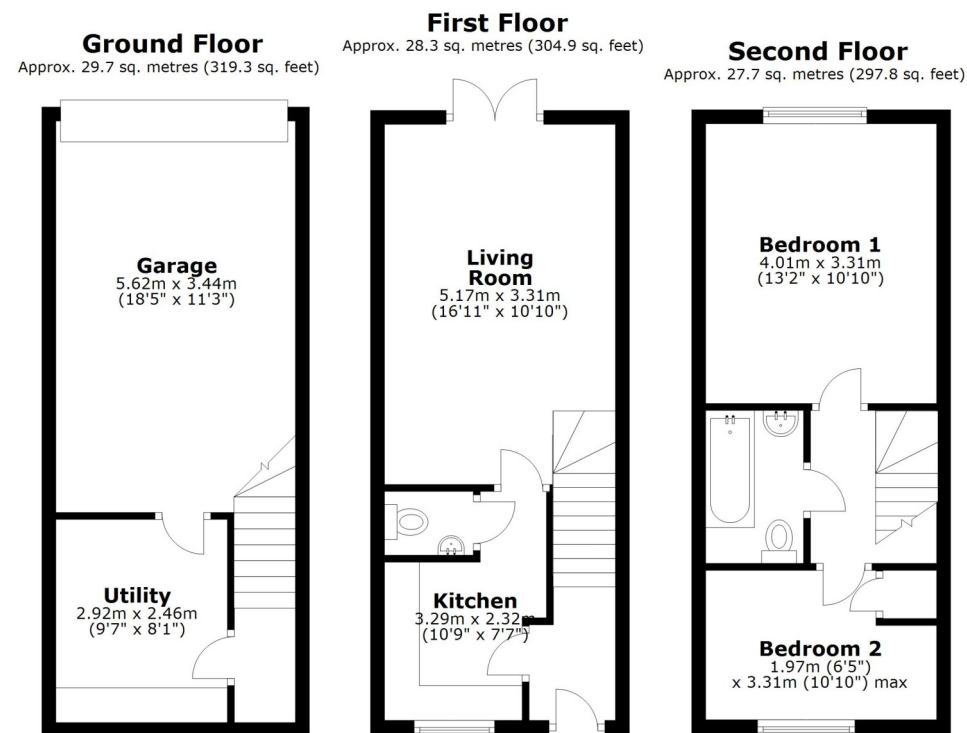

Total area: approx. 85.7 sq. metres (922.0 sq. feet)

We accept no responsibility for any mistake or inaccuracy contained within the floorplan. The floorplan is provided as a guide only and should be taken as an illustration only. The measurements, contents and positioning are approximations only and provided as a guidance tool and not an exact replication of the property.  
Plan produced using PlanUp.

Cooper Green Pooks  
3 Barker Street  
Shrewsbury  
SY1 1QF

www.cgpooks.co.uk  
sales@cgpooks.co.uk  
01743 276666







## 3 Bage Terrace, St Michaels Street, Shrewsbury, SY1 2HA

Coopergreenpooks.co.uk

£199,950 Freehold—2 bedroom town house

sales@cgpooks.co.uk



Cooper Green Pooks  
3 Barker Street  
Shrewsbury  
SY1 1QF

www.cgpooks.co.uk  
sales@cgpooks.co.uk  
01743 276666



# 3 Bage Terrace, St Michaels Street, Shrewsbury, SY1 2HA

£199,950 Freehold—2 bedroom town house

sales@cgpooks.co.uk

rightmove

onTheMarket.com

RICS  
Regulated by RICS

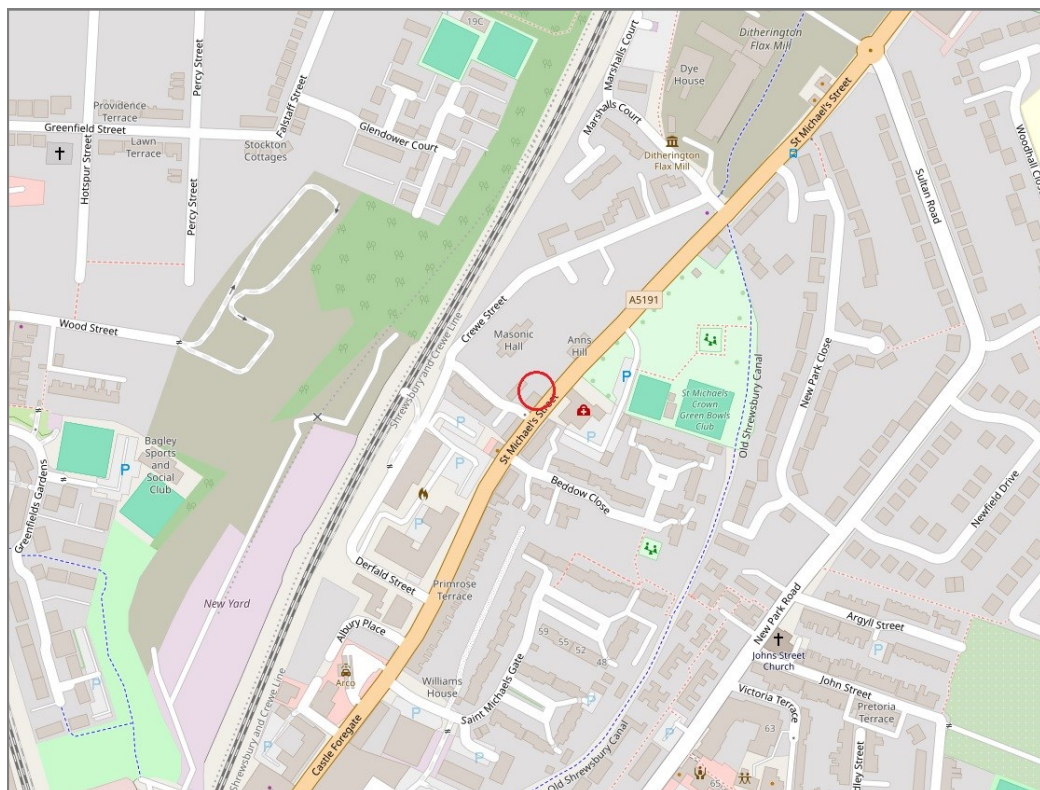
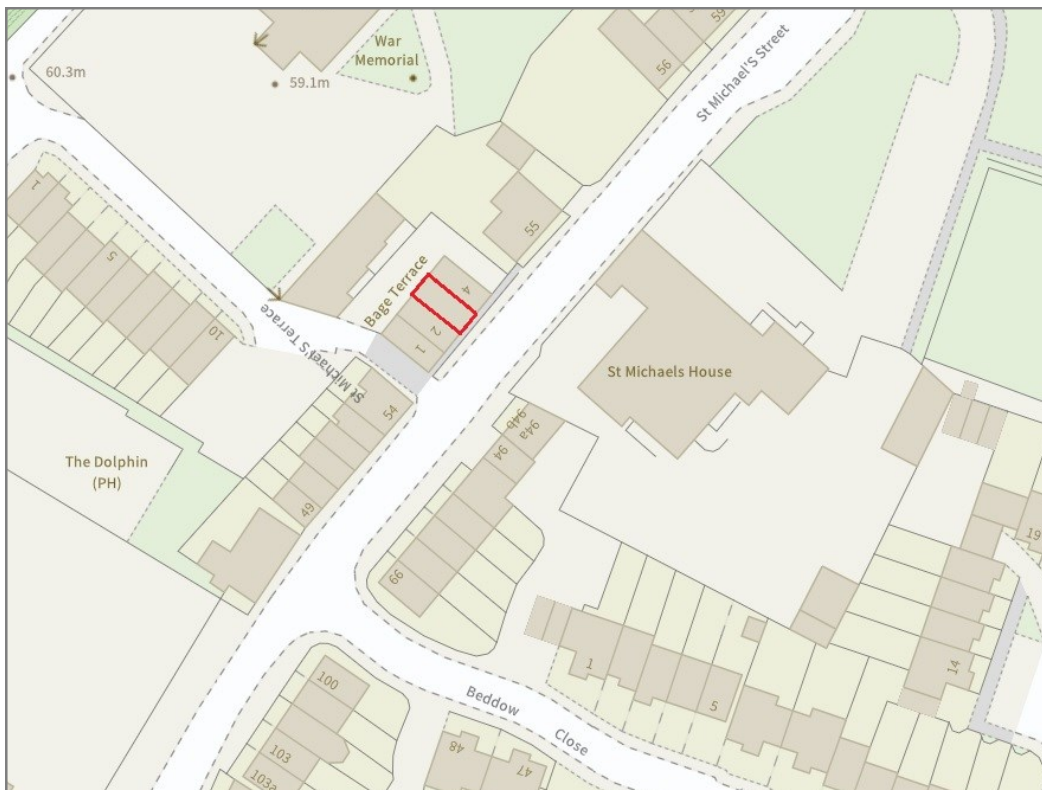

**BOUNDARIES NOT CONFIRMED**

Tenure	<b>Freehold</b>
Local Authority	<b>Shropshire Council</b>
Council Tax	<b>Band B</b>
EPC Band	<b>Band C</b>
Services	<b>All mains services are connected</b>

**Expert mortgage advice available**

3 Barker St, Shrewsbury SY1 1QF

**Cooper Green Pooks**  
**01743 276666**



Your home may be repossessed if you do not keep up repayments on your mortgage.

There may be a fee for mortgage advice. The actual amount you pay will depend upon your circumstances. The fee is up to 1% but a typical fee is 0.3% of the amount borrowed.

### 3 Bage Terrace, St Michaels Street, Shrewsbury, SY1 2HA

Coopergreenpooks.co.uk

£199,950 Freehold—2 bedroom town house

sales@cgpooks.co.uk

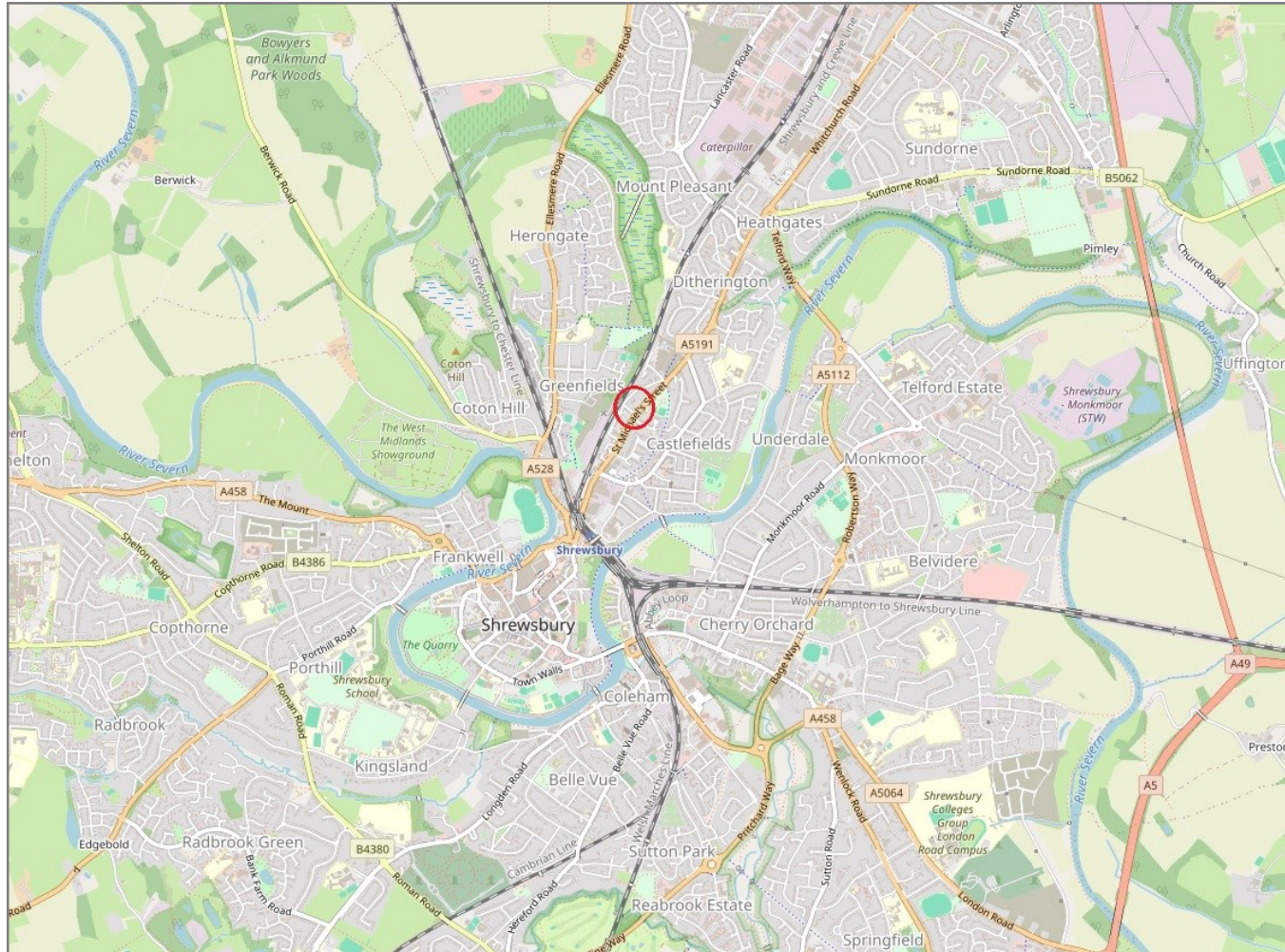

**IMPORTANT NOTICE:** Cooper Green Pooks for themselves and for the lessors or vendors of this property whose agents they are give notice that: 1 No appliances, services or service installations have been tested and no warranty as to suitability or serviceability is implied. Any prospective purchaser or lessee is advised to obtain verification from their surveyor or solicitor. 2. The particulars are set out as a general outline only for the guidance of the intended purchasers or lessees and do not constitute, nor constitute part of, an offer or contract. 3. All descriptions, reference to condition and necessary permissions for use and occupation and other details are given in good faith and are believed to be correct but any intending purchasers or lessees should not rely on them as statements or representation of fact but satisfy themselves by inspection or otherwise as to the correctness of each of them. 4. No person in the employment of Cooper Green Pooks has any authority to make or give any representation or warranty whatsoever in relation to this property. 5. All rentals and prices are quoted exclusive of Stamp Duty, legal and surveyors fees and any other associated purchasers or lessees costs. 6. Floor plans are indicative only and should not be relied on. 7. The plan showing the boundary of the property is indicative only and has not been checked against the legal title so should not be relied on. 8. All dimensions, floor areas and site areas are only approximate and should not be relied on. Dimensions are generally maximum room dimension.