



**14, Farran Grove, Berwick Grange, Shrewsbury, SY1 4YB**  
£850 Per Month





14, Farran Grove, Berwick Grange, Shrewsbury, SY1 4YB

**£850 Per Month**

VIRTUAL TOUR AVAILABLE - Recently refurbished two bedroom modern mid terraced house in a popular residential area to the north of Shrewsbury town centre. Located in a quiet cul-de-sac position, this property has very convenient road links and provides easy access to the wide range of businesses located Battlefield Enterprise Park.

Available: 16/07/24

## Description

Comprising: Entrance hall, living room including karndean flooring, new handleless kitchen oven & gas hob, dining area including door to the rear. Stairs to first floor landing, master bedroom, further bedroom, new bathroom including shower. New gas central heating and wiring. Double glazing. Attractive rear garden including store and patio. Allocated driveway parking (opposite). EPC C



Unfurnished

Council Tax Band: B

Available: 16th July 2024

EPC: C

## Floor Plans

### Ground Floor

Approx. 28.9 sq. metres (311.4 sq. feet)

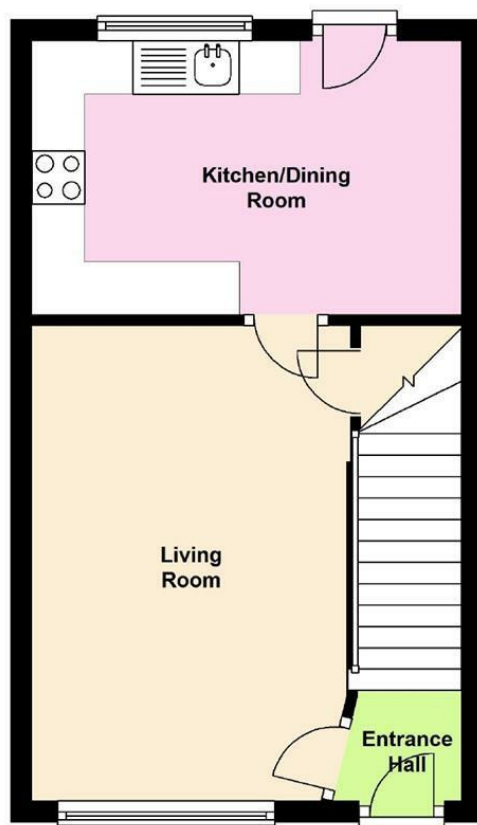

### First Floor

Approx. 29.2 sq. metres (314.1 sq. feet)

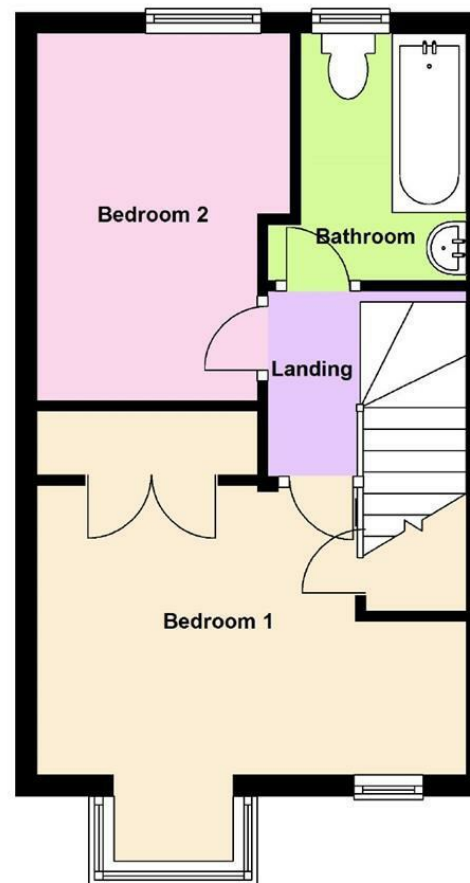

Total area: approx. 58.1 sq. metres (625.5 sq. feet)

We accept no responsibility for any mistake or inaccuracy contained within the floorplan. The floorplan is provided as a guide only and should be taken as an illustration only. The measurements, contents and positioning are approximations only and provided as a guidance tool and not an exact replication of the property.

Plan produced using PlanUp.

These particulars, whilst believed to be accurate are set out as a general outline only for guidance and do not constitute any part of an offer or contract. Intending purchasers should not rely on them as statements of representation of fact, but must satisfy themselves by inspection or otherwise as to their accuracy. No person in this firm's employment has the authority to make or give any representation or warranty in respect of the property.