



Apartment 18, Summerfield Place, Wenlock Road, Shrewsbury, SY2 6JX

2 bedroom apartment — £279,000 Leasehold

Apartment 18, Summerfield Place, Wenlock Road, Shrewsbury, SY2 6JX

Coopergreenpooks.co.uk

£279,000 Leasehold—2 bedroom apartment

sales@cgpooks.co.uk

Occupying a lovely position within a popular modern development, built with the over 60's in mind, this beautifully presented and well-designed first floor apartment offers spacious and practical accommodation, finished to a high standard throughout, while being surrounded by attractively landscaped communal gardens and benefitting from a private allocated parking space.

KEY FEATURES

- Well-maintained and very neatly kept communal entrance hall and lift access to the first floor
- Good sized entrance hall and very useful store/utility room with washing machine and additional shelving
- Open plan living/dining room with views to front
- Well-fitted kitchen, complete with fully integrated appliances
- Large master bedroom with windows to two elevations, en-suite bathroom and walk-in-wardrobe which has been fitted out with hanging rails and shelving
- A further double bedroom and separate shower room
- uPVC double glazed windows, efficient electric heating system and air conditioning
- Fantastic communal gardens surround the building, comprising areas of lawn, raised beds and paved terraces for residents to enjoy
- On duty house manager to offer help and support where needed
- Other features include a resident's lounge, guest suite and a thriving community who regularly get together for coffee mornings, games nights, as well as walking and gardening clubs etc.
- Private allocated parking space included in the sale and guest parking with EV charging point
- This property is situated in a quiet position at the end of the building, set back from the road, and is located just 10 minutes from the town centre with a regular bus service running from outside the main entrance

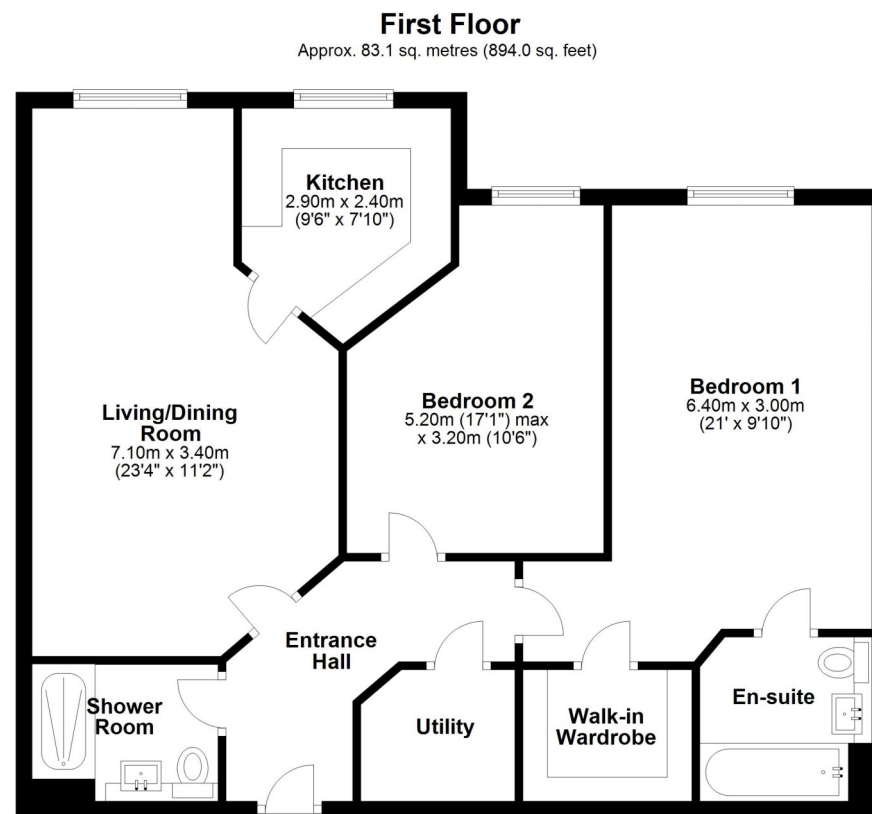

Total area: approx. 83.1 sq. metres (894.0 sq. feet)

We accept no responsibility for any mistake or inaccuracy contained within the floorplan. The floorplan is provided as a guide only and should be taken as an illustration only. The measurements, contents and positioning are approximations only and provided as a guidance tool and not an exact replication of the property. Plan produced using PlanUp.









Apartment 18, Summerfield Place, Wenlock Road, Shrewsbury, SY2 6JX

£279,000 Leasehold—2 bedroom apartment

sales@cgpooks.co.uk

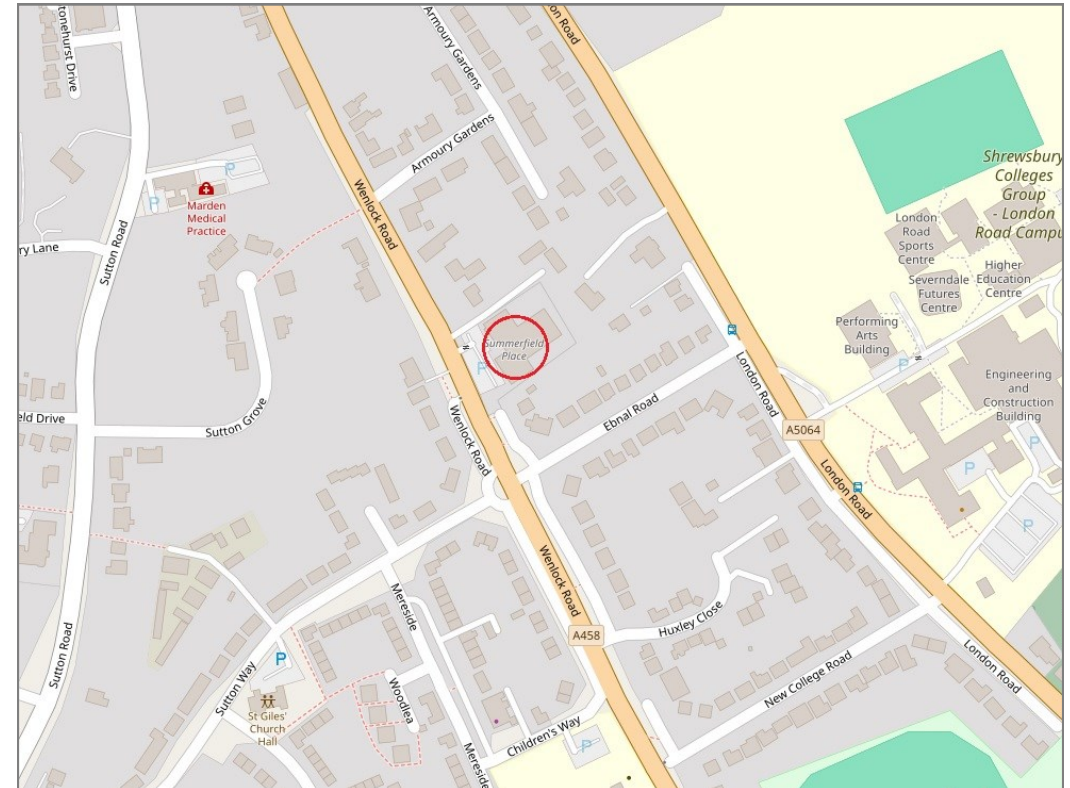

BOUNDARIES NOT CONFIRMED

Tenure	Leasehold
Local Authority	Shropshire Council
Council Tax	Band D
EPC Band	Band B
Services	Mains water, electricity and drainage are connected

Expert mortgage advice available
3 Barker St, Shrewsbury SY1 1QF
Cooper Green Pooks
01743 276666



Your home may be repossessed if you do not keep up repayments on your mortgage.
There may be a fee for mortgage advice. The actual amount you pay will depend upon your circumstances. The fee is up to 1% but a typical fee is 0.3% of the amount borrowed.

Apartment 18, Summerfield Place, Wenlock Road, Shrewsbury, SY2 6JX

Coopergreenpooks.co.uk

£279,000 Leasehold—2 bedroom apartment

sales@cgpooks.co.uk

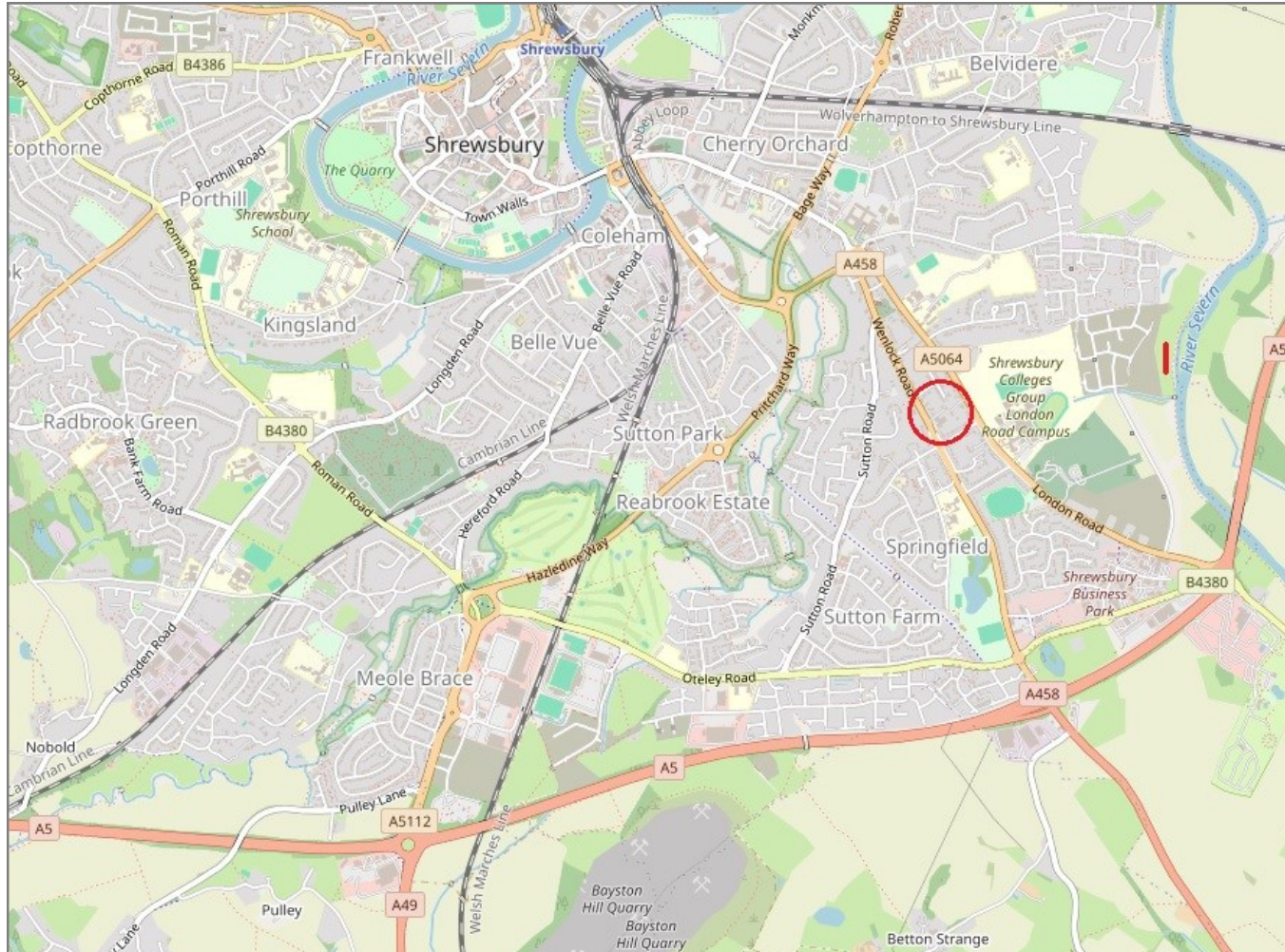

IMPORTANT NOTICE: Cooper Green Pooks for themselves and for the lessors or vendors of this property whose agents they are give notice that: 1 No appliances, services or service installations have been tested and no warranty as to suitability or serviceability is implied. Any prospective purchaser or lessee is advised to obtain verification from their surveyor or solicitor. 2. The particulars are set out as a general outline only for the guidance of the intended purchasers or lessees and do not constitute, nor constitute part of, an offer or contract. 3. All descriptions, reference to condition and necessary permissions for use and occupation and other details are given in good faith and are believed to be correct but any intending purchasers or lessees should not rely on them as statements or representation of fact but satisfy themselves by inspection or otherwise as to the correctness of each of them. 4. No person in the employment of Cooper Green Pooks has any authority to make or give any representation or warranty whatsoever in relation to this property. 5. All rentals and prices are quoted exclusive of Stamp Duty, legal and surveyors fees and any other associated purchasers or lessees costs. 6. Floor plans are indicative only and should not be relied on. 7. The plan showing the boundary of the property is indicative only and has not been checked against the legal title so should not be relied on. 8. All dimensions, floor areas and site areas are only approximate and should not be relied on. Dimensions are generally maximum room dimension.