



**1, Passey Close, Oteley Road, Sovereign Park, Shrewsbury, SY2 6JL**  
£1,100 Per Month



1, Passey Close, Oteley Road, Sovereign Park, Shrewsbury, SY2 6JL

**£1,100 Per Month**

VIRTUAL TOUR AVAILABLE - Well presented three bedroom end of terrace property, finished to a high standard throughout, situated within this popular modern development with the benefit of a private garden and parking. The property is located a short distance from some excellent amenities, road links via the bypass and less than two miles from Shrewsbury town centre.

Available: 27/06/2024

## Description

Comprising: Entrance hall, WC, kitchen with integrated washing machine, fridge/freezer, dishwasher, oven and hob, living room with patio doors to rear garden and under-stairs storage. Two double bedrooms, further single bedroom, en-suite shower room, bathroom with shower over the bath. Front and rear gardens. Gas central heating. Double glazing. Two driveway parking spaces. EPC B.



Unfurnished

Council Tax Band: C

Available: 27th June 2024

EPC: B

## Floor Plans

### Ground Floor

Approx. 37.0 sq. metres (398.7 sq. feet)

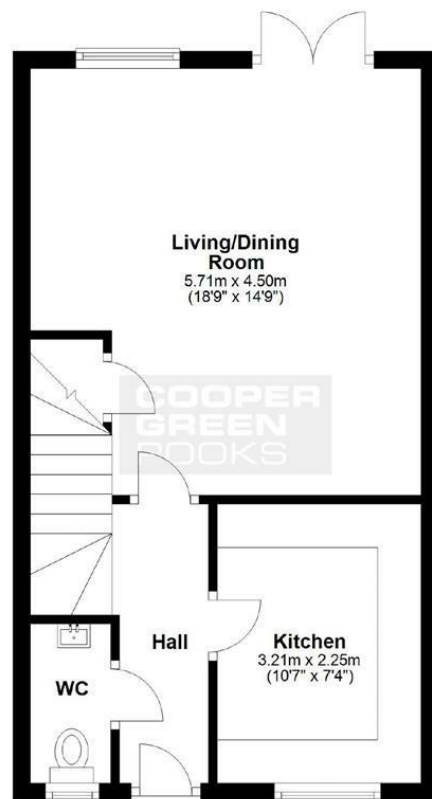

### First Floor

Approx. 37.0 sq. metres (398.7 sq. feet)

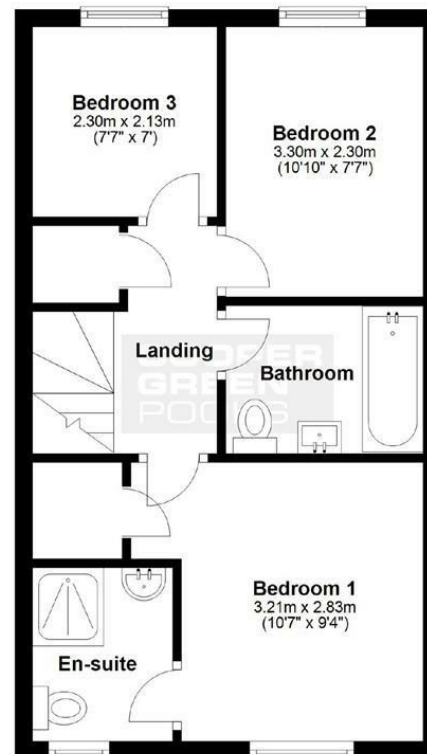

Total area: approx. 74.1 sq. metres (797.4 sq. feet)

We accept no responsibility for any mistake or inaccuracy contained within the floorplan. The floorplan is provided as a guide only and should be taken as an illustration only. The measurements, contents and positioning are approximations only and provided as a guidance tool and not an exact replication of the property.  
Plan produced using PlanUp.

These particulars, whilst believed to be accurate are set out as a general outline only for guidance and do not constitute any part of an offer or contract. Intending purchasers should not rely on them as statements of representation of fact, but must satisfy themselves by inspection or otherwise as to their accuracy. No person in this firm's employment has the authority to make or give any representation or warranty in respect of the property.