

A photograph of a three-story brick building with a blue door and 'FOR SALE' signs. The building is made of light-colored bricks and has several windows. A blue door is visible on the right side. The sky is blue with some clouds. The building is located on a street with other buildings in the background.

4, Beechwood House, Town Walls, Shrewsbury, SY1 1AG
£1,250 Per Month



4, Beechwood House, Town Walls, Shrewsbury, SY1 1AG

£1,250 Per Month

VIRTUAL TOUR AVAILABLE - Attractive and centrally located two bedroom town house positioned between the ancient Town Walls and Belmont Bank offering convenient access to all Shrewsbury's town centre has to offer. Private covered parking space adjacent to the property is included.

Available: 12/07/24

Description

Comprising: Entrance hall through to bedroom two with en suite shower room. Stairs to first floor landing with back door to Belmont Bank, bedroom two with built in wardrobes and en suite bathroom with separate shower. Stairs to second floor landing, kitchen dining room, kitchen with integrated fridge freezer, double oven, induction hob and dish washer, through to WC with space for freestanding washing machine. Stairs to living room with roof terrace. Allocated parking space. Gas Central Heating. Double Glazing. EPC C.



Unfurnished

Council Tax Band: D

Available: 12th July 2024

EPC: C

Floor Plans

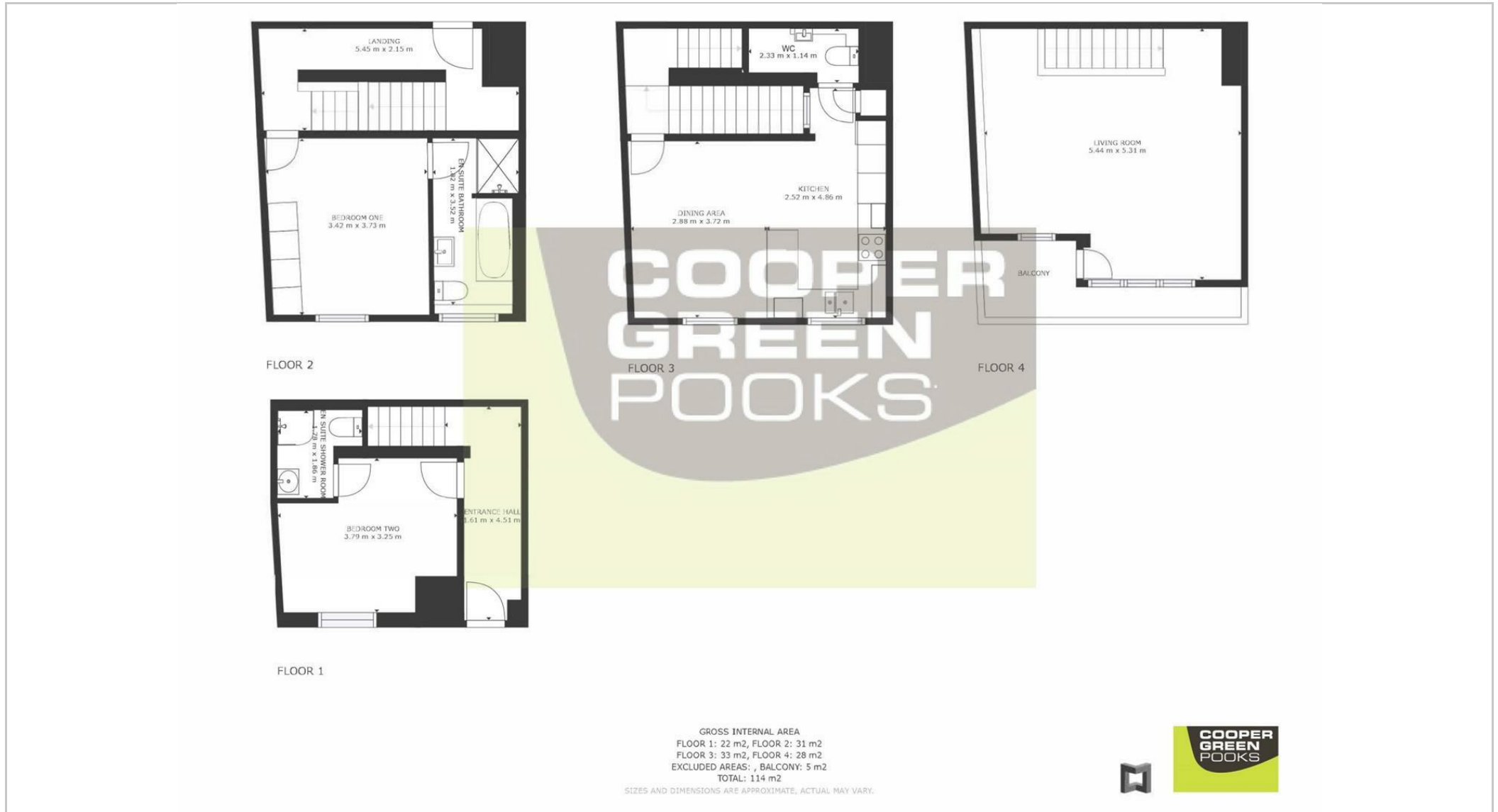

These particulars, whilst believed to be accurate are set out as a general outline only for guidance and do not constitute any part of an offer or contract. Intending purchasers should not rely on them as statements of representation of fact, but must satisfy themselves by inspection or otherwise as to their accuracy. No person in this firm's employment has the authority to make or give any representation or warranty in respect of the property.