



57, Armoury Gardens, Shrewsbury, SY2 6PJ

£1,995 Per Month



57, Armoury Gardens, Shrewsbury, SY2 6PJ

£1,995 Per Month

Fantastic four bedroom family home occupying a lovely position within one of Shrewsbury's most sought after residential areas, this stunning semi-detached house has been extended and significantly improved to provide substantial and thoughtfully designed accommodation, finished to an exceptionally high standard throughout.

Available from: IMMEDIATELY

Description

Comprising: Impressive entrance hall with staircase to spacious landing, cloakroom and parquet tiled flooring which continues throughout most of the ground floor, living room with feature fireplace and bay window to front, fantastic open plan kitchen/dining room, incorporating a well-designed family room, with two sets of bi-folding doors opening to the rear garden, the bespoke fitted kitchen includes high quality integrated appliances, plenty of storage, solid oak work surfaces, island unit with induction hob and downdraft extractor, and a Belfast sink with boiling water tap, separate utility with built in washer/dryer, connecting to both the integral garage and rear garden creating a very practical route of access to the front and back of the property, the double storey extension has allowed for a master bedroom and beautifully fitted en-suite, complete with double length shower and vanity unit, a further three double bedrooms, two of which overlook the rear garden and the other has a bay window to the front, there is also a well-appointed family bathroom on the first floor. Very useful insulated and boarded loft space with ladder access from the landing, uPVC double glazed windows, gas fired central heating and underfloor heating throughout the kitchen/dining/family room. Landscaped private rear garden, laid to lawn with good sized porcelain tiled sun terrace, new fencing all round, and external lighting, driveway to front providing plenty of parking and access to the integral garage which has an electric roller shutter door. EPC C.



Unfurnished

Council Tax Band: D

Available: 9th May 2024

EPC: C

Floor Plans

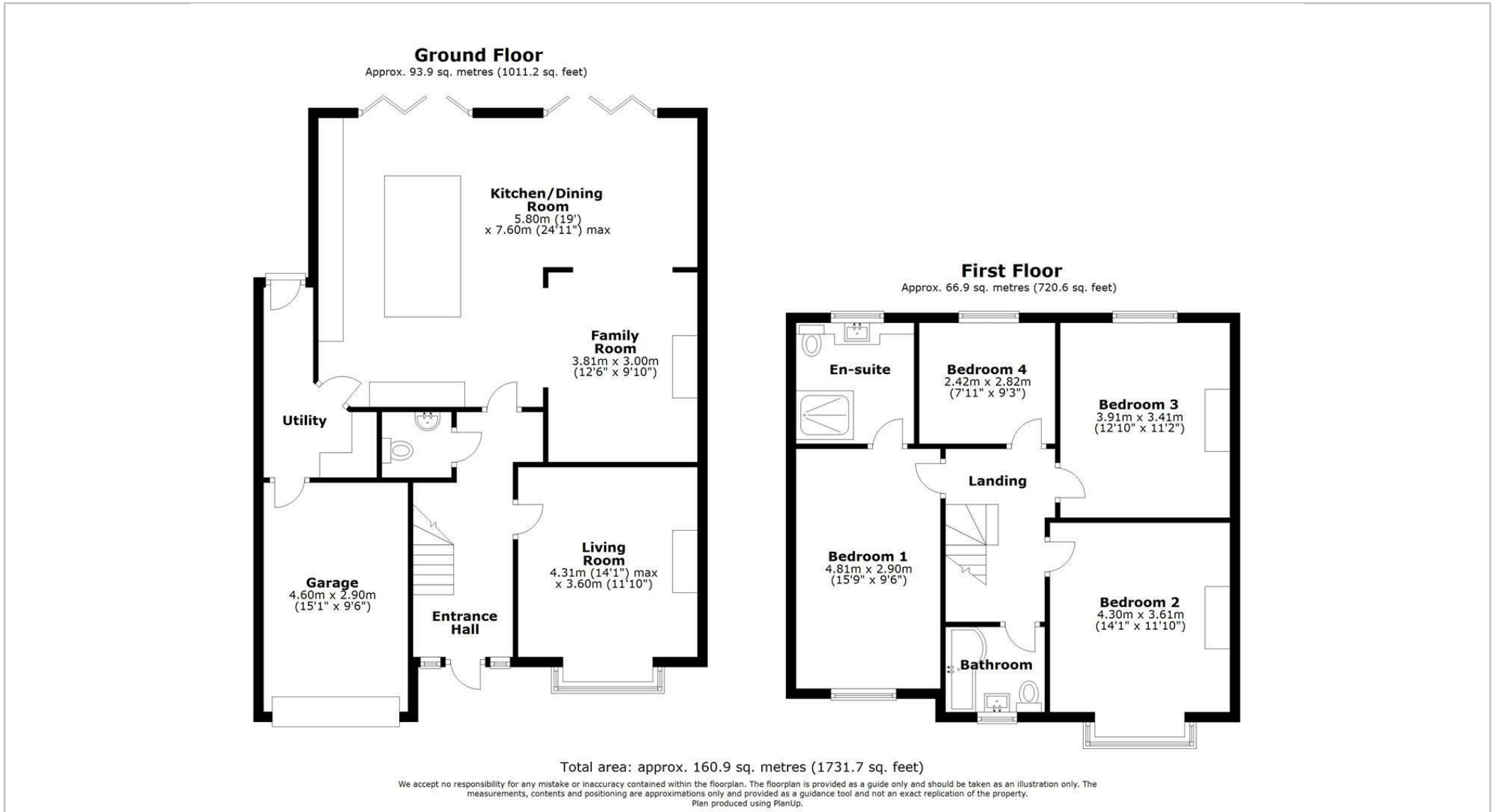

These particulars, whilst believed to be accurate are set out as a general outline only for guidance and do not constitute any part of an offer or contract. Intending purchasers should not rely on them as statements of representation of fact, but must satisfy themselves by inspection or otherwise as to their accuracy. No person in this firm's employment has the authority to make or give any representation or warranty in respect of the property.