



**25, Clarkefields, Bayston Hill, Shrewsbury, SY3 0ES**  
£1,200 Per Month





25, Clarkefields, Bayston Hill, Shrewsbury, SY3 0ES

**£1,200 Per Month**

VIRTUAL TOUR AVAILABLE - Spacious detached three bedroom house with front and back gardens, driveway parking and garage. Located in the popular village of Bayston Hill, the property is a short drive to the A5 ring road and Meole Brace retail Park.

Available: 06/06/24

## Description

Comprising: Porch, entrance hall with storage cupboard and shower room, kitchen with freestanding cooker, space for under counter fridge, dining area with glazed sliding door to rear garden, spacious living room with glazed patio doors to rear garden. Stairs to spacious first floor landing, two double bedrooms with storage, further bedroom, shower room. Front and rear garden with patio. Utility / garden room with freestanding freezer, washing machine and tumble dryer. Single garage with door to rear garden. Gas Central Heating. Double Glazed through out. EPC D



Unfurnished

Council Tax Band: C

Available: 6th June 2024

EPC: D



## Floor Plans

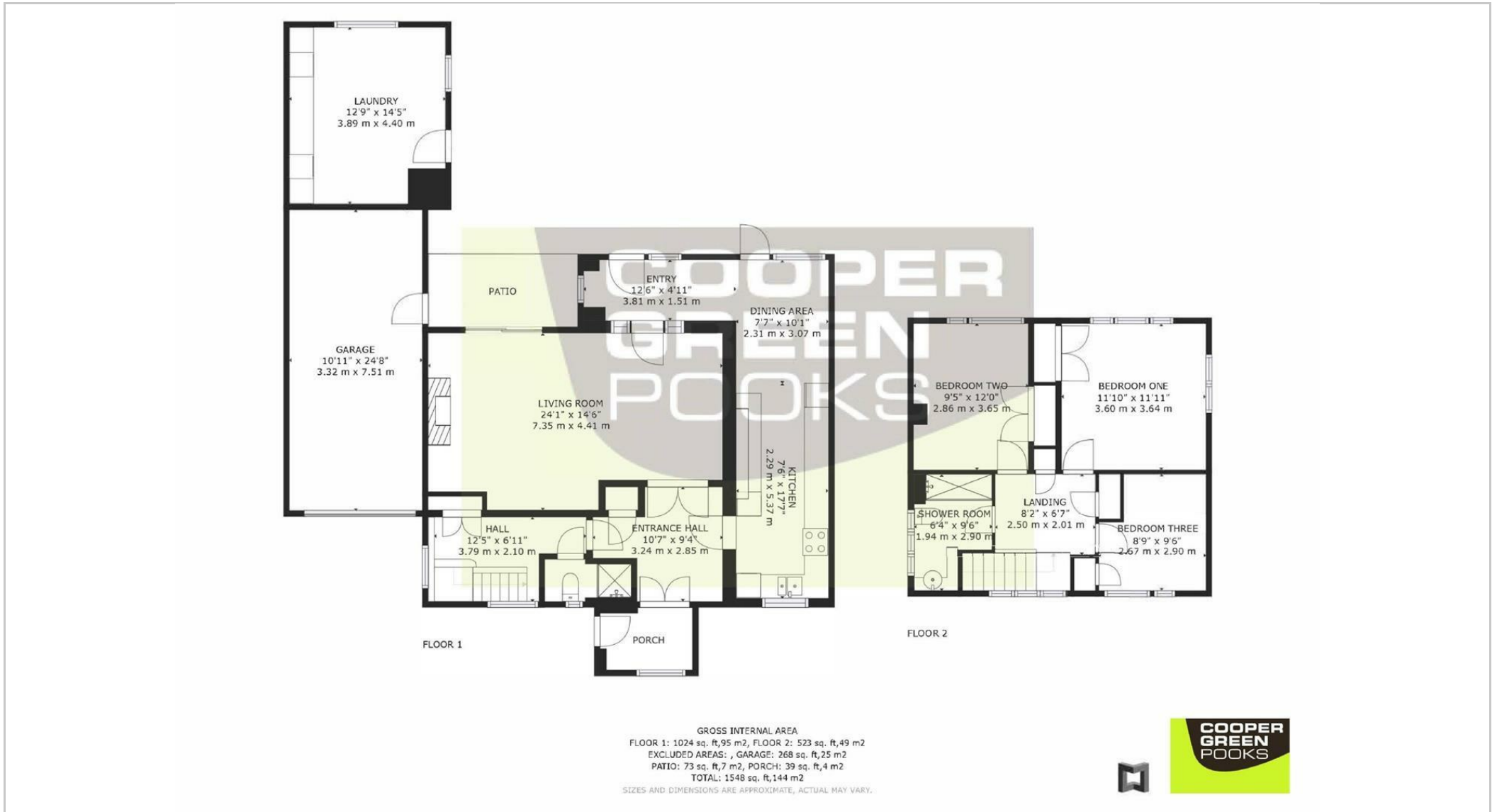

These particulars, whilst believed to be accurate are set out as a general outline only for guidance and do not constitute any part of an offer or contract. Intending purchasers should not rely on them as statements of representation of fact, but must satisfy themselves by inspection or otherwise as to their accuracy. No person in this firms employment has the authority to make or give any representation or warranty in respect of the property.