



65, Roden Grove, Wem, SY4 5HJ
£230,000



65, Roden Grove, Wem, SY4 5HJ

£230,000

Occupying a fantastic position on a quiet cul-de-sac with impressive views over open countryside, this modern semi-detached house offers well-designed accommodation, while benefitting from a good sized rear garden and driveway parking.

Description



null
Council Tax Band: B
Available:
EPC: B

Floor Plans

GROUND FLOOR

APPROX. 32.2 SQ. METRES (346.2 SQ. FEET)

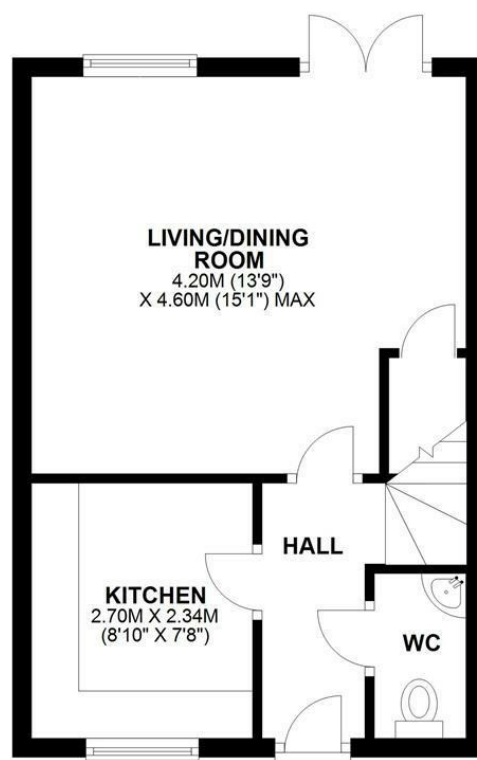

FIRST FLOOR

APPROX. 32.2 SQ. METRES (346.2 SQ. FEET)

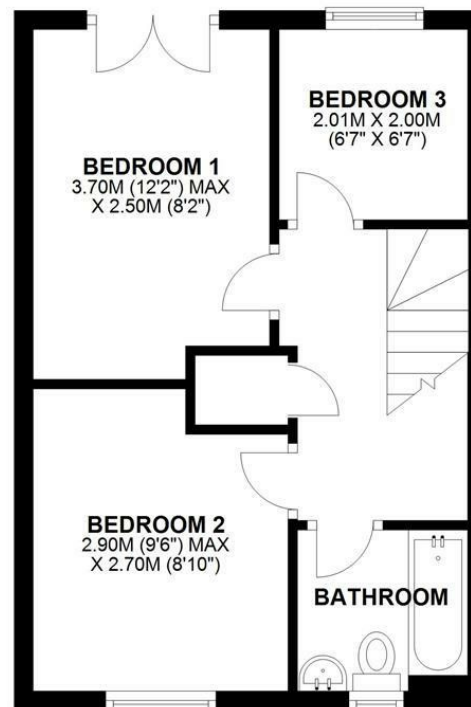

TOTAL AREA: APPROX. 64.3 SQ. METRES (692.4 SQ. FEET)

We accept no responsibility for any mistake or inaccuracy contained within the floorplan. The floorplan is provided as a guide only and should be taken as an illustration only. The measurements, contents and positioning are approximations only and provided as a guidance tool and not an exact replication of the property.
Plan produced using PlanUp.

These particulars, whilst believed to be accurate are set out as a general outline only for guidance and do not constitute any part of an offer or contract. Intending purchasers should not rely on them as statements of representation of fact, but must satisfy themselves by inspection or otherwise as to their accuracy. No person in this firm's employment has the authority to make or give any representation or warranty in respect of the property.