



31 Millmead, Sutton Road, Shrewsbury, SY2 6DR
£400 Per Month



31 Millmead, Sutton Road, Shrewsbury, SY2 6DR

£400 Per Month

Modernised second floor studio flat in a converted Edwardian School building situated in a quiet residential area a short distance from Shrewsbury town centre. Includes allocated parking space and communal gardens.

Available: 25/05/24

Description

Comprising: Communal entrance and stairs to second floor, entrance lobby including storage cupboard, modern shower room, open plan living/kitchen and bedroom area including built in double wardrobe. The modern kitchen area includes fridge, oven and hob. There is a communal laundry room on site providing use of washers and dryers. Double glazing, gas central heating. Blinds included. Use of professionally maintained communal garden, allocated parking for one car. EPC D

Unfurnished

Council Tax Band: A

Available: 25th May 2024

EPC: D

Floor Plans

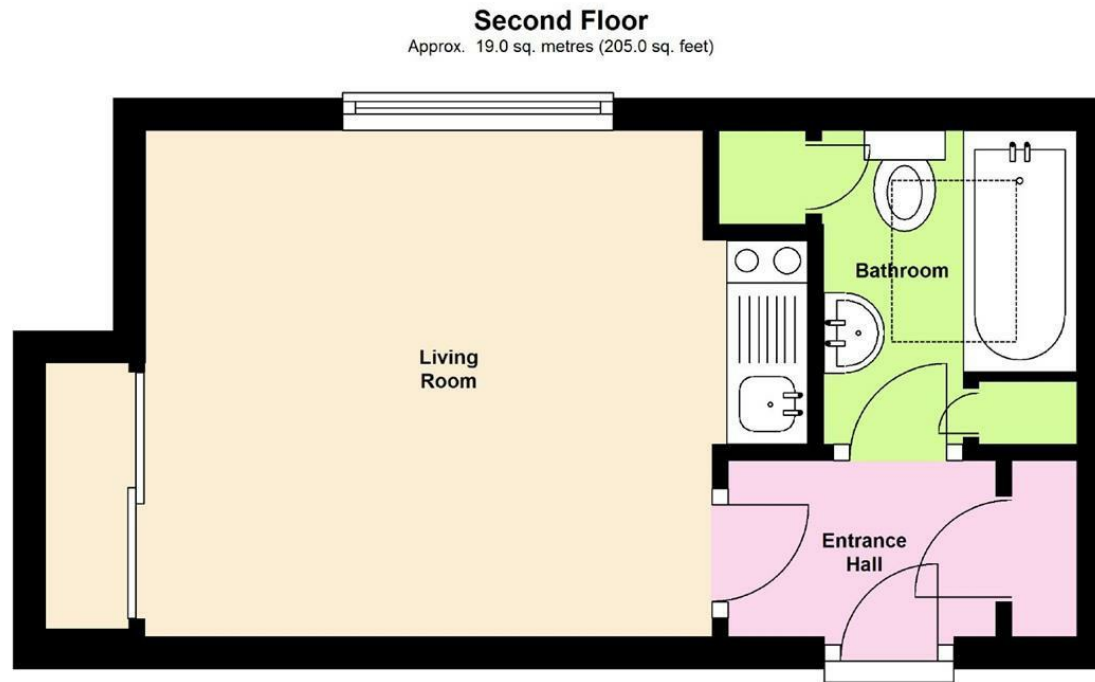

Total area: approx. 19.0 sq. metres (205.0 sq. feet)

We accept no responsibility for any mistake or inaccuracy contained within the floorplan. The floorplan is provided as a guide only and should be taken as an illustration only. The measurements, contents and positioning are approximations only and provided as a guidance tool and not an exact replication of the property.

Plan produced using PlanUp.

These particulars, whilst believed to be accurate are set out as a general outline only for guidance and do not constitute any part of an offer or contract. Intending purchasers should not rely on them as statements of representation of fact, but must satisfy themselves by inspection or otherwise as to their accuracy. No person in this firm's employment has the authority to make or give any representation or warranty in respect of the property.