



53 Copthorne Drive, Copthorne, Shrewsbury, SY3 8RX

4 bedroom semi-detached house—£525,000 Freehold

53 Copthorne Drive, Copthorne, Shrewsbury, SY3 8RX

Coopergreenpooks.co.uk

£525,000 Freehold—4 bedroom semi-detached house

sales@cgpooks.co.uk

This very attractive property is well situated on a quiet street just a few minutes' walk from the quarry park and town centre. The stylish and well-presented interior has been considerably improved and extended to provide spacious and versatile accommodation, along with private driveway and rear garden.

KEY FEATURES

- Entrance vestibule to hall with patterned tiled flooring, original stained-glass windows and cloakroom
- Family room with bay window to front and separate living room with feature fireplace and wood burner
- Superb dining room which connects to both kitchen and living room along with bi-folding doors opening to rear garden. There is also a large feature glass lantern roof light, bespoke drinks cabinet and oak boarded flooring to match the other living areas
- Large well fitted kitchen area with tiled flooring, gloss units and oak work surfaces. There is also a window and door to side, Velux roof lights to vaulted ceiling and part glazed door to inner hall/utility
- Ground floor main bedroom which has a window and bi-folding doors to sun terrace and garden, as well as a modern en-suite shower room. Both rooms have oak boarded flooring
- From hall staircase to landing where there is a separate WC, 3 double bedrooms (2 with original cast iron fireplaces) and a re-fitted family bathroom
- Replacement double glazed windows and gas fired central heating
- Gravelled driveway to front and side, providing parking for at least 2 cars
- Private lawned rear garden with established borders, large paved sun terrace and built in storage
- Located in one of the towns most popular areas, on a quiet street, a short walk from the neighbourhood store, Woodfield primary school, great pubs, including the riverside Boathouse, beautiful Quarry park and town centre.

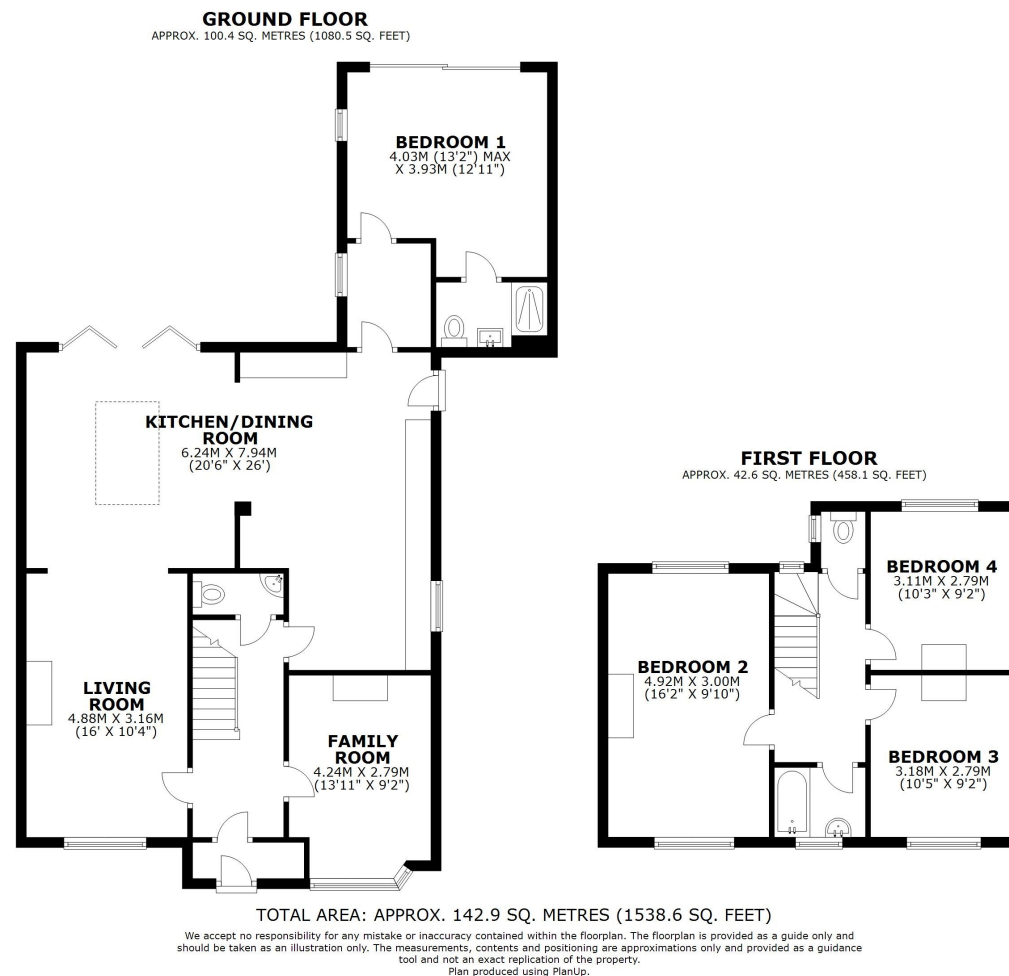







53 Copthorne Drive, Copthorne, Shrewsbury, SY3 8RX

Coopergreenpooks.co.uk

£525,000 Freehold—4 bedroom semi-detached house

sales@cgpooks.co.uk



Cooper Green Pooks
3 Barker Street
Shrewsbury
SY1 1QF

www.cgpooks.co.uk
sales@cgpooks.co.uk



53 Copthorne Drive, Copthorne, Shrewsbury, SY3 8RX

£525,000 Freehold—4 bedroom semi-detached house

sales@cgpooks.co.uk

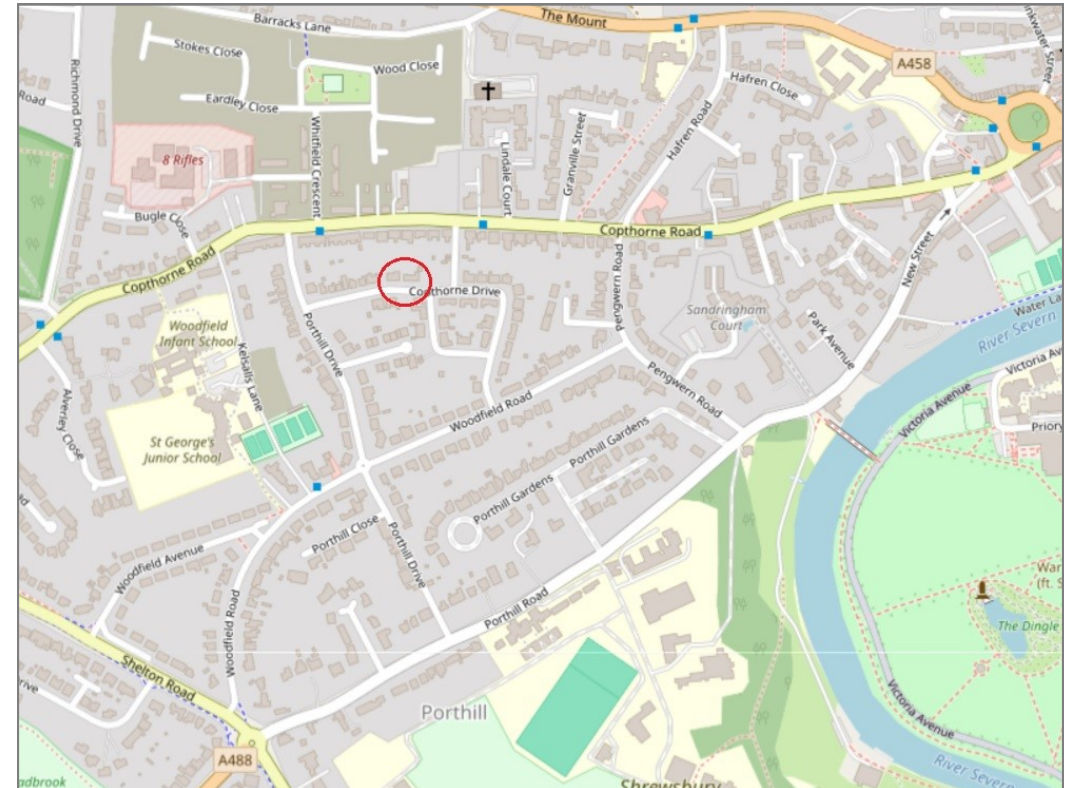
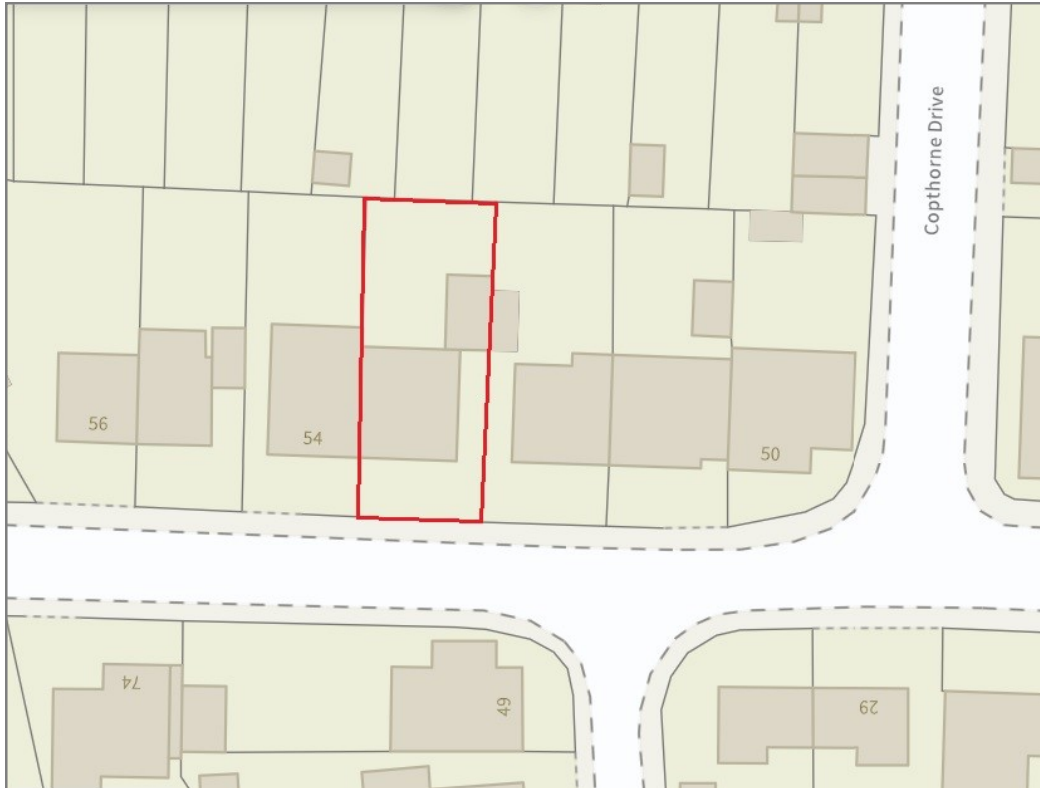

BOUNDARIES NOT CONFIRMED

Tenure	Freehold
Local Authority	Shropshire Council
Council Tax	Band C
EPC Band	Band E
Services	All mains services are connected

Expert mortgage advice available
3 Barker St, Shrewsbury SY1 1QF
Cooper Green Pooks
01743 276666



Your home may be repossessed if you do not keep up repayments on your mortgage.
There may be a fee for mortgage advice. The actual amount you pay will depend upon your circumstances. The fee is up to 1% but a typical fee is 0.3% of the amount borrowed.

53 Copthorne Drive, Copthorne, Shrewsbury, SY3 8RX

Coopergreenpooks.co.uk

£525,000 Freehold—4 bedroom semi-detached house

sales@cgpooks.co.uk

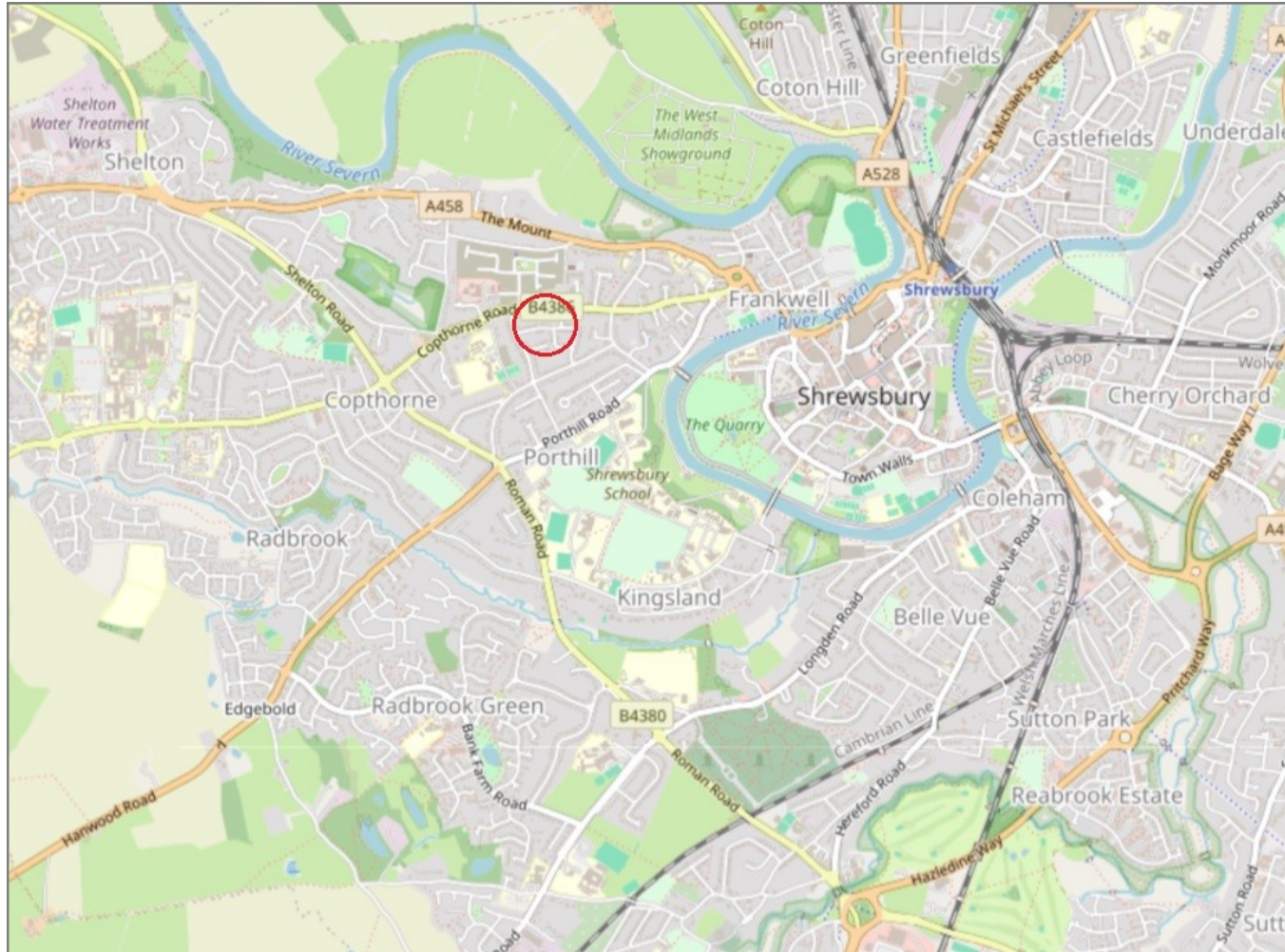

IMPORTANT NOTICE: Cooper Green Pooks for themselves and for the lessors or vendors of this property whose agents they are give notice that: 1 No appliances, services or service installations have been tested and no warranty as to suitability or serviceability is implied. Any prospective purchaser or lessee is advised to obtain verification from their surveyor or solicitor. 2. The particulars are set out as a general outline only for the guidance of the intended purchasers or lessees and do not constitute, nor constitute part of, an offer or contract. 3. All descriptions, reference to condition and necessary permissions for use and occupation and other details are given in good faith and are believed to be correct but any intending purchasers or lessees should not rely on them as statements or representation of fact but satisfy themselves by inspection or otherwise as to the correctness of each of them. 4. No person in the employment of Cooper Green Pooks has any authority to make or give any representation or warranty whatsoever in relation to this property. 5. All rentals and prices are quoted exclusive of Stamp Duty, legal and surveyors fees and any other associated purchasers or lessees costs. 6. Floor plans are indicative only and should not be relied on. 7. The plan showing the boundary of the property is indicative only and has not been checked against the legal title so should not be relied on. 8. All dimensions, floor areas and site areas are only approximate and should not be relied on. Dimensions are generally maximum room dimension.