

4, Pool Road, Hadnall, Shrewsbury, SY4 4BG

£382,000



4, Pool Road, Hadnall, Shrewsbury, SY4 4BG

£382,000

This spacious detached property has been newly modernised to a very high standard throughout, providing impressive and well planned accommodation in a quiet village setting with private garden and fantastic views across adjoining countryside.

Description



null
Council Tax Band: D
Available:
EPC:

Floor Plans

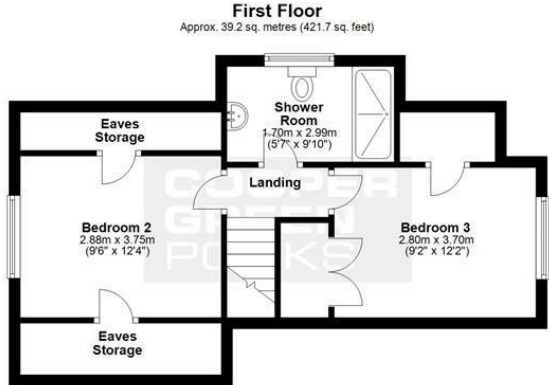

Total area: approx. 131.2 sq. metres (1412.1 sq. feet)

We accept no responsibility for any mistake or inaccuracy contained within the floorplans. The floorplan is provided as a guide only and should be taken as an illustration only. The measurements, contents and positioning are approximations only and provided as a guidance tool and not an exact replication of the property.
Plan produced using PlanUp.

These particulars, whilst believed to be accurate are set out as a general outline only for guidance and do not constitute any part of an offer or contract. Intending purchasers should not rely on them as statements of representation of fact, but must satisfy themselves by inspection or otherwise as to their accuracy. No person in this firm's employment has the authority to make or give any representation or warranty in respect of the property.