



2 Didcot Close, Castlefields, Shrewsbury, SY1 2UH

2 bedroom ground floor apartment—£158,000 Leasehold

2 Didcot Close, Castlefields, Shrewsbury, SY1 2UH

Coopergreenpooks.co.uk

£158,000 Leasehold—2 bedroom ground floor apartment

sales@cgpooks.co.uk

This immaculately presented ground floor apartment has recently been modernised to a high standard throughout, whilst being located in a quiet residential area with private parking and the added advantage of a good sized garden to the front side and rear.

KEY FEATURES

- Private entrance to hall with built in store.
- Living/dining room with views to front.
- Impressive recently fitted kitchen and shower room.
- 2 bedrooms, one of which has a range of custom made storage cupboards/wardrobe.
- Recently installed uPVC double glazed windows and gas fired central heating boiler.
- Large private garden to the front side and rear, which is neatly laid mainly to lawn with paved terrace and store, whilst being enclosed by new timber fencing.
- Private parking for at least 2 cars.
- Quiet residential area, close to lovely river walks, various local shops, schools and town centre.
- Lease recently extended with 123 years remaining and a fixed service charge of just £60 per year

Cooper Green Pooks
3 Barker Street
Shrewsbury
SY1 1QF

www.cgpooks.co.uk
sales@cgpooks.co.uk
01743 276666



Ground Floor

Approx. 53.3 sq. metres (574.0 sq. feet)

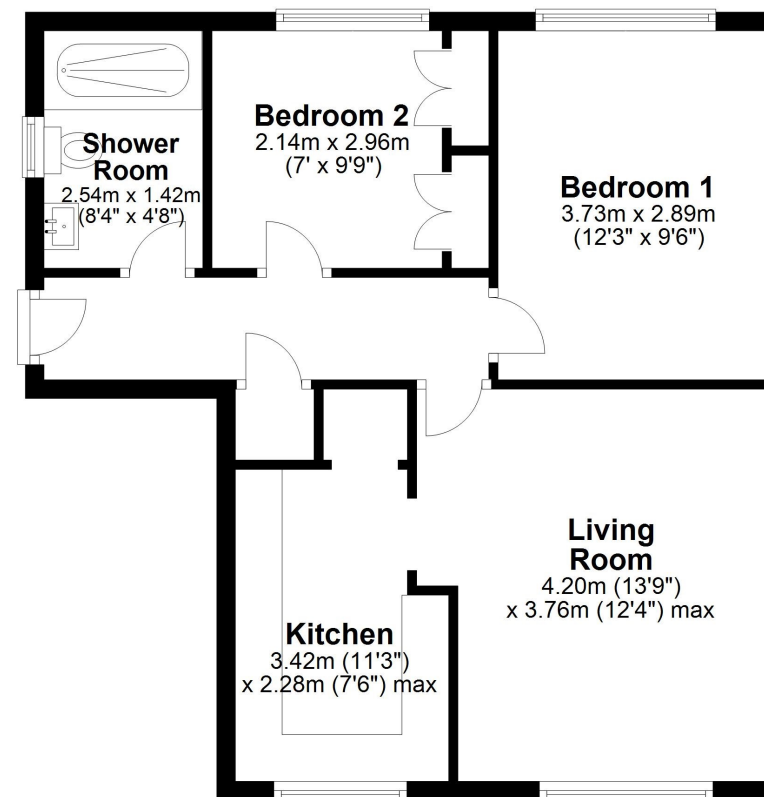

Total area: approx. 53.3 sq. metres (574.0 sq. feet)

We accept no responsibility for any mistake or inaccuracy contained within the floorplan. The floorplan is provided as a guide only and should be taken as an illustration only. The measurements, contents and positioning are approximations only and provided as a guidance tool and not an exact replication of the property.

Plan produced using PlanUp.





2 Didcot Close, Castlefields, Shrewsbury, SY1 2UH

Coopergreenpooks.co.uk

£158,000 Leasehold—2 bedroom ground floor apartment

sales@cgpooks.co.uk



Cooper Green Pooks
3 Barker Street
Shrewsbury
SY1 1QF

www.cgpooks.co.uk
sales@cgpooks.co.uk
01743 276666



2 Didcot Close, Castlefields, Shrewsbury, SY1 2UH

£158,000 Leasehold—2 bedroom ground floor apartment

sales@cgpooks.co.uk



Tenure	Leasehold
Lease	123 years remaining
Service Charge	£60
Local Authority	Shropshire Council
Council Tax	Band A
Services	All mains services are connected

Expert mortgage advice available
3 Barker St, Shrewsbury SY1 1QF
Cooper Green Pooks
01743 276666



Your home may be repossessed if you do not keep up repayments on your mortgage.
There may be a fee for mortgage advice. The actual amount you pay will depend upon your circumstances. The fee is up to 1% but a typical fee is 0.3% of the amount borrowed.

2 Didcot Close, Castlefields, Shrewsbury, SY1 2UH

Coopergreenpooks.co.uk

£158,000 Leasehold—2 bedroom ground floor apartment

sales@cgpooks.co.uk

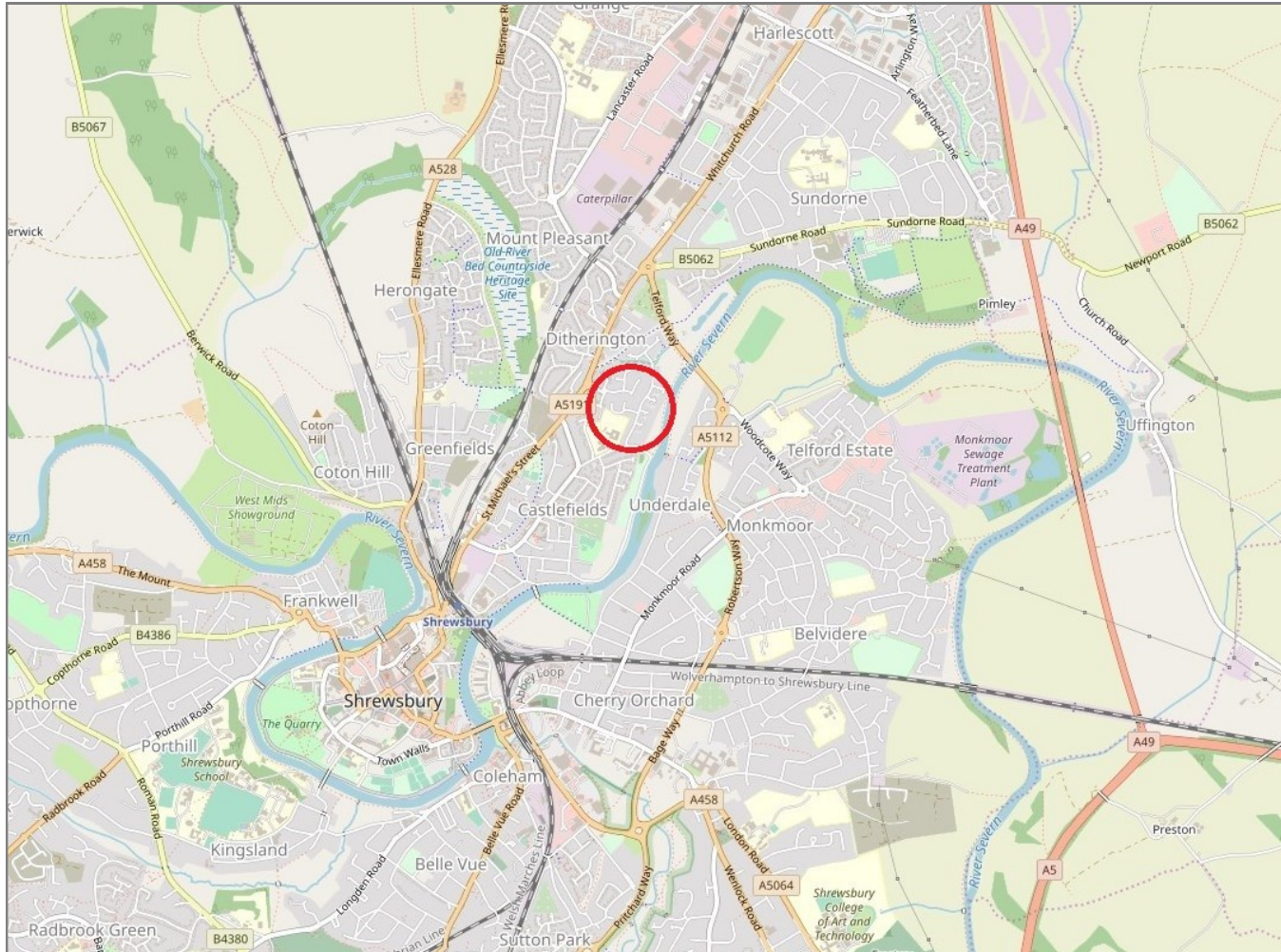

IMPORTANT NOTICE: Cooper Green Pooks for themselves and for the lessors or vendors of this property whose agents they are give notice that: 1 No appliances, services or service installations have been tested and no warranty as to suitability or serviceability is implied. Any prospective purchaser or lessee is advised to obtain verification from their surveyor or solicitor. 2. The particulars are set out as a general outline only for the guidance of the intended purchasers or lessees and do not constitute, nor constitute part of, an offer or contract. 3. All descriptions, reference to condition and necessary permissions for use and occupation and other details are given in good faith and are believed to be correct but any intending purchasers or lessees should not rely on them as statements or representation of fact but satisfy themselves by inspection or otherwise as to the correctness of each of them. 4. No person in the employment of Cooper Green Pooks has any authority to make or give any representation or warranty whatsoever in relation to this property. 5. All rentals and prices are quoted exclusive of Stamp Duty, legal and surveyors fees and any other associated purchasers or lessees costs. 6. Floor plans are indicative only and should not be relied on. 7. The plan showing the boundary of the property is indicative only and has not been checked against the legal title so should not be relied on. 8. All dimensions, floor areas and site areas are only approximate and should not be relied on. Dimensions are generally maximum room dimension.