

shepherds

A better home
moving experience



3 Belvedere Apartments

Hertford, SG14 1AS

Price Guide £269,000



3 Belvedere Apartments

Hertford, SG14 1AS

Stylish Two Bedroom First Floor Apartment in the heart of Hertford

Set within a character converted building, this beautifully presented two bedroom first floor flat offers a blend of period charm and modern living, right in the centre of Hertford. The property benefits from an EXTENDED LEASE of approximately 120 years and is ideal for first-time buyers, commuters or investors alike.

The generous 16' open-plan living space features a contemporary kitchen area and opens out through French doors onto a private balcony – perfect for enjoying your morning coffee or unwinding in the evening. The accommodation also includes two bedrooms and a sleek, refitted shower room with a modern white suite.

Ideally located in the town centre, you'll have immediate access to Hertford's excellent range of shops, cafes, and restaurants, along with the convenience of two mainline train stations offering direct links to London.

A must-see property offering both lifestyle and location – early viewing highly recommended.





- Two bedroom first floor flat
- Town centre location
- Easy access to all local amenities and two train stations
- Open plan 16' living room with modern kitchen
- Refitted shower room
- Lease with 120 years remaining
- Private balcony
- Location Via What 3 Words: [tigers.bridge.swan](https://www.what3words.com/tigers.bridge.swan)

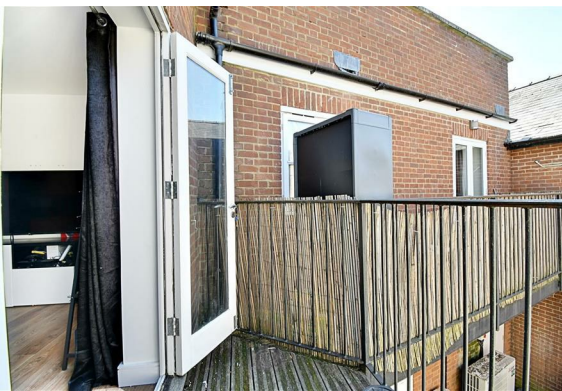

Floor Plan

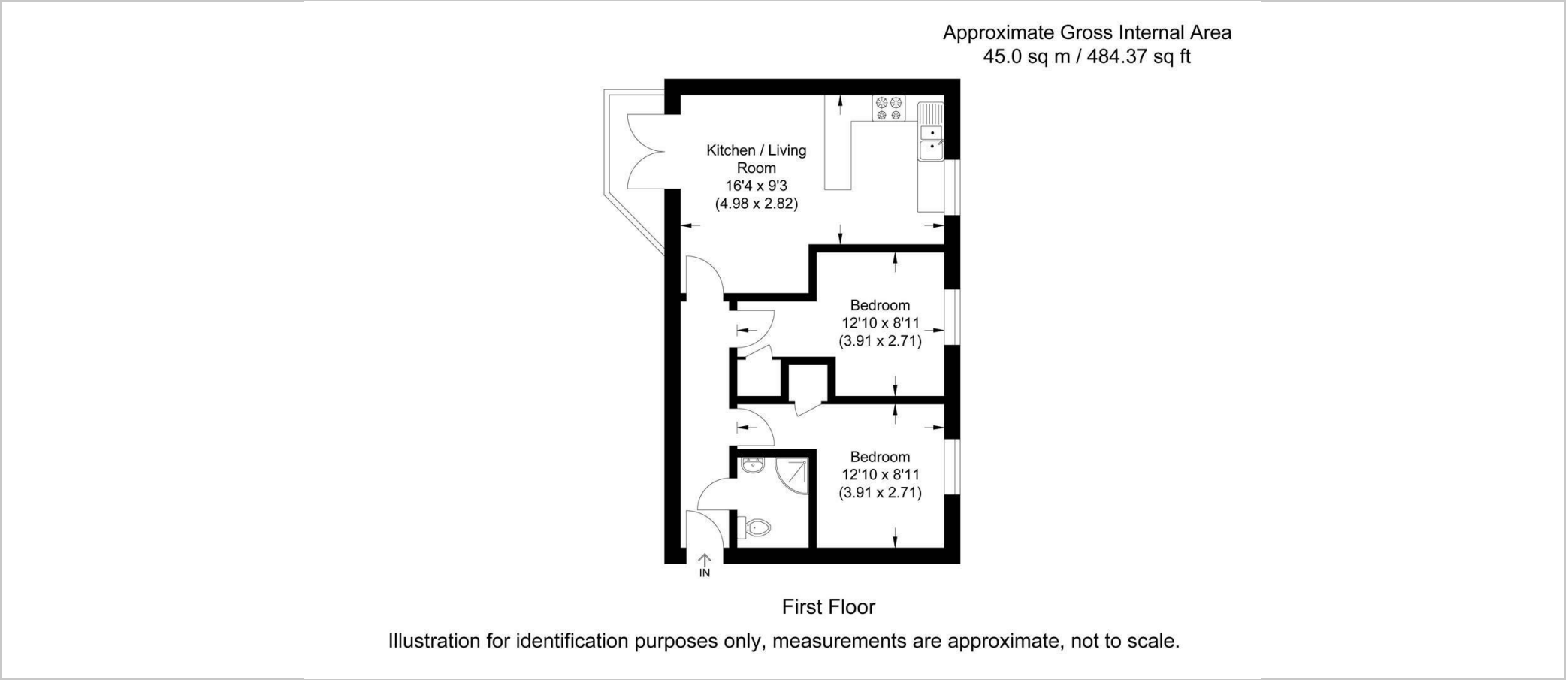

Viewing

Please contact Shepherds of Hertford on 01992 551955
if you wish to arrange a viewing appointment for this property or require further information.

Energy Performance Graph

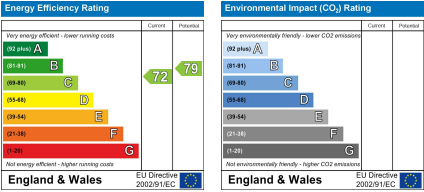

These particulars, whilst believed to be accurate are set out as a general outline only for guidance and do not constitute any part of an offer or contract. Intending purchasers should not rely on them as statements of representation of fact, but must satisfy themselves by inspection or otherwise as to their accuracy. No person in this firms employment has the authority to make or give any representation or warranty in respect of the property.

Riverside House, 6 Millbridge, Hertford, SG14 1PY
Tel: 01992 551955 Email: enquiries@shepherdsofhertford.co.uk