

shepherds
A better home
moving experience



1 Lodge Close

Bengeo, SG14 3DH

Guide Price £945,000



1 Lodge Close

Bengeo, SG14 3DH

SOLD BY SHEPHERDS - Situated in a sought-after cul-de-sac in Bengeo, this beautifully presented **CHAIN-FREE** four-bedroom detached home offers modern living in a prime location. Finished to an exceptional standard, this turn-key property boasts underfloor heating throughout the ground floor and a thoughtfully designed and flexible layout ideal for contemporary family life with the additional possibility of housing a dependant relative via the accommodation on the ground floor.

The heart of the home is the spacious open-plan kitchen and dining area, featuring high-quality appliances and ample space for both cooking and entertaining. Two generous reception rooms provide flexible living options, while a downstairs cloakroom adds convenience.

Upstairs, the master bedroom benefits from a stylish en-suite, complemented by three further well-proportioned bedrooms and a family bathroom. A third bathroom ensures practicality for busy households.

Externally, the property features a good-sized garden with an outbuilding, perfect for additional storage. The garage and driveway provide ample parking.





- Immaculate four-bedroom detached home
- Turn-key condition
- Underfloor heating
- Spacious open-plan kitchen/diner
- Two generous reception rooms
- Master bedroom with en-suite
- Downstairs cloakroom
- Good-sized rear garden with versatile outbuilding
- Garage and driveway



Floor Plan

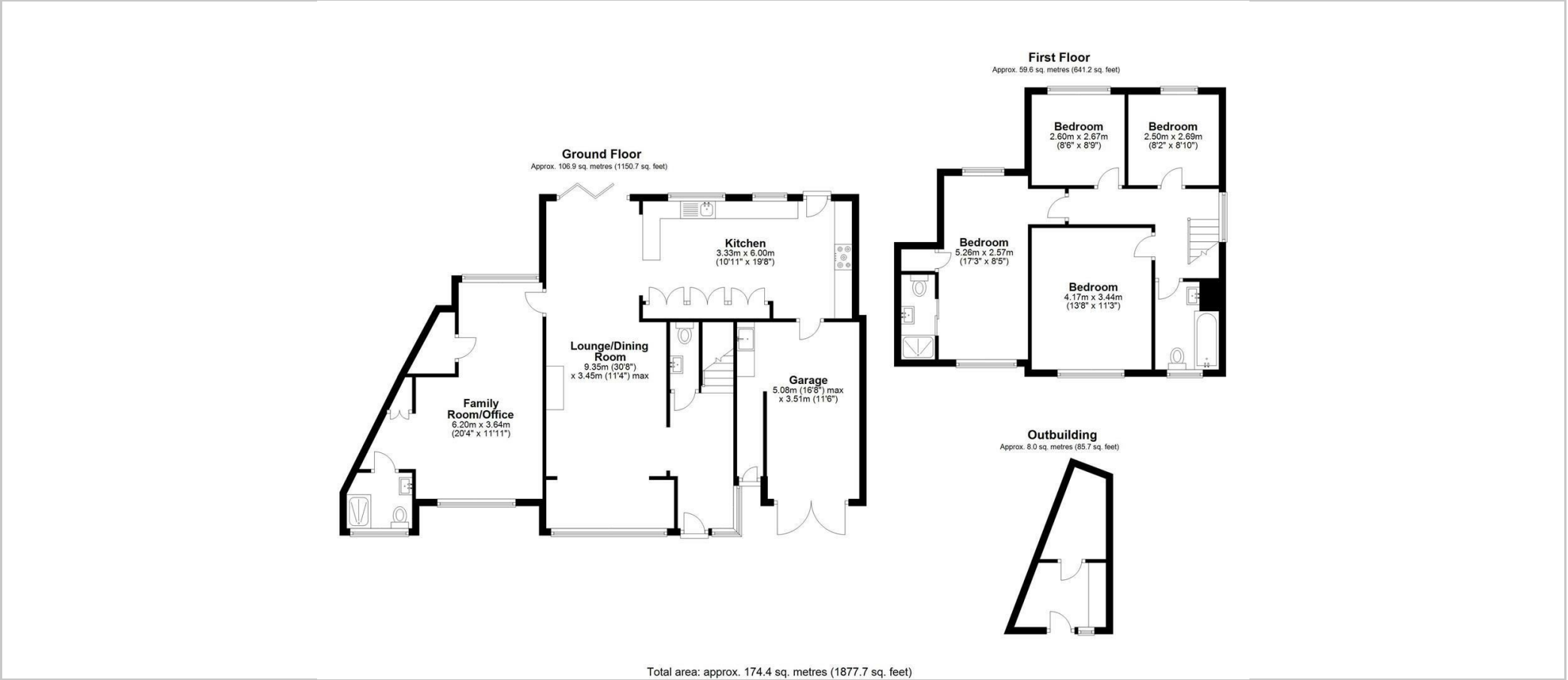

Viewing

Please contact Shepherds of Hertford on 01992 551955 if you wish to arrange a viewing appointment for this property or require further information.

Energy Performance Graph

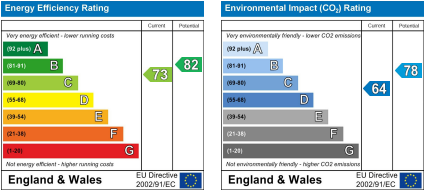

These particulars, whilst believed to be accurate are set out as a general outline only for guidance and do not constitute any part of an offer or contract. Intending purchasers should not rely on them as statements of representation of fact, but must satisfy themselves by inspection or otherwise as to their accuracy. No person in this firms employment has the authority to make or give any representation or warranty in respect of the property.

Riverside House, 6 Millbridge, Hertford, SG14 1PY
Tel: 01992 551955 Email: enquiries@shepherdsofhertford.co.uk