

shepherds

A better home
moving experience



1 Copperwood

Hertford, SG13 7HZ

Price Guide £325,000



1 Copperwood

Hertford, SG13 7HZ

Price Guide £325,000



Entrance Door:

Front door leading into entrance hall.

Entrance Hall:

Laminate floor, stairs to first floor, inner door to living area.

Living Area:

23'4" x 10'10" (7.11m x 3.30m)

Dual aspect to front and window to rear, laminate floor, television point, radiator, coving, open plan to breakfast area.

Kitchen:

14'10" x 6'5" (4.52m x 1.96m)

Window to front, modern refitted kitchen with cream Shaker style base and wall cupboards, laminate beech effect work surfaces incorporating one & a half bowl single drainer stainless steel sink unit with mixer taps, built-in oven and separate stainless steel gas hob with stainless steel extractor hood, integrated fridge and freezer, space for washer/dryer with plumbing provided, laminate floor.

Breakfast Area:

Laminate floor, understairs cupboard housing gas boiler supplying central heating and hot water.

First Floor Landing:

Window to rear, airing cupboard housing hot water cylinder, access to loft space, doors off.

Bedroom 1:

11'6" x 10'11" (3.51m x 3.33m)

Box bay window to front, fitted wardrobe, radiator, coving.

Bedroom 2:

11'6" x 6'8" (3.51m x 2.03m)

Window to front with elevated views, fitted wardrobe, radiator, coving.

Bathroom:

6'9" x 6'1" (2.06 x 1.85)

Opaque window to rear, refitted white suite comprising low level WC, pedestal wash hand basin and panel enclosed bath with mixer taps & shower attachment plus separate wall mounted electric shower, tiled floor, radiator.

Communal Grounds:

Grassed areas with planted trees and shrubs.

Allocated Parking:

For one vehicle closeby, with further spaces for visitors parking available.

Tenure:

Leasehold : 999 years from 1983

Ground Rent : £400 p.a.

Maintenance Charge : £1,100 p.a.



Floor Plan

Copperwood, Hertford, Herts SG13

APPROX. GROSS INTERNAL FLOOR AREA 171 SQFT / 67 SQM

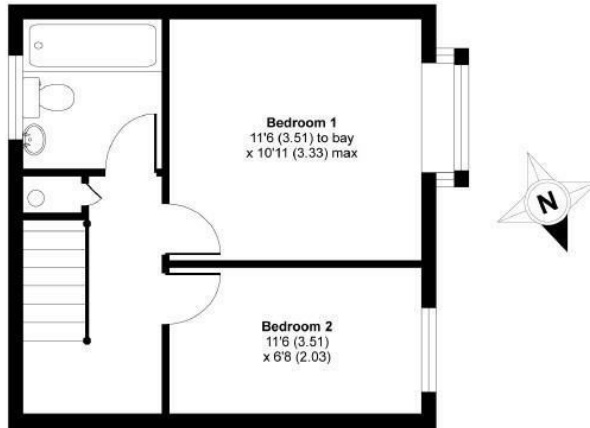

FIRST FLOOR

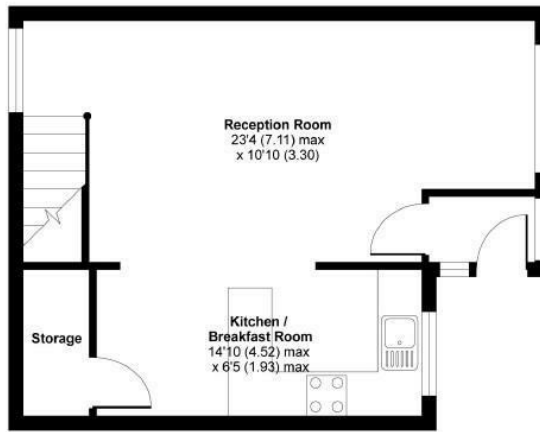

GROUND FLOOR

Whilst every attempt has been made to ensure the accuracy of the floor plans contained here, measurements of doors, windows and rooms are approximate and no responsibility is taken for any error, omission or mis-statement. These plans are for representation purposes only as defined by RICS Code of Measuring Practice and should be used as such by any prospective purchaser. The services, systems and appliances listed in this specification have not been tested by Shepherd Estates and no guarantee as to their operating ability or their efficiency can be given.

Copyright nichecom.co.uk 2008 Produced for Shepherd Estates REF : 08-19040

Viewing

Please contact Shepherds of Hertford on 01992 551955 if you wish to arrange a viewing appointment for this property or require further information.

Energy Performance Graph

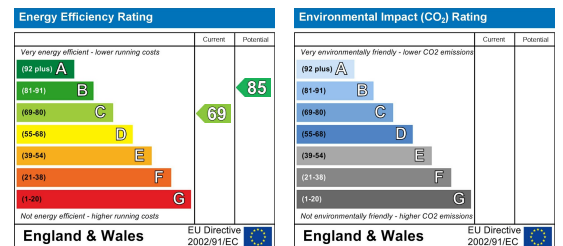

These particulars, whilst believed to be accurate are set out as a general outline only for guidance and do not constitute any part of an offer or contract. Intending purchasers should not rely on them as statements of representation of fact, but must satisfy themselves by inspection or otherwise as to their accuracy. No person in this firm's employment has the authority to make or give any representation or warranty in respect of the property.