

shepherds  
A better home  
moving experience



9 Elder Court

Hertford, SG13 7GD

Guide Price £300,000



## 9 Elder Court

Hertford, SG13 7GD

SOLD BY SHEPHERDS - STUNNING PANORAMIC VIEWS - 200 YEAR LEASE and NO GROUND RENT - over the Lea basin marina and beyond from this well presented two-bedroom modern apartment, available with NO CHAIN. Nestled in an incredibly convenient riverside location only a minutes walk from Hertford East mainline station and an array of local amenities within the bustling town centre just beyond. First floor, with lift access, this apartment looks out over both the river and Hartham Common from its private DOUBLE BALCONY and enjoys ready access 'on it's doorstep' to beautiful riverside and country walks. The living space comprises a lounge opening to a fully equipped kitchen with integrated appliances, a modern bathroom, and the added bonus of designated parking in a secure underground car park.





- Two bedroom first floor apartment
- Views over the river and Hartham Common
- OFFERED CHAIN FREE
- Private balcony
- Modern fitted kitchen and bathroom
- Allocated underground car park



Floor Plan

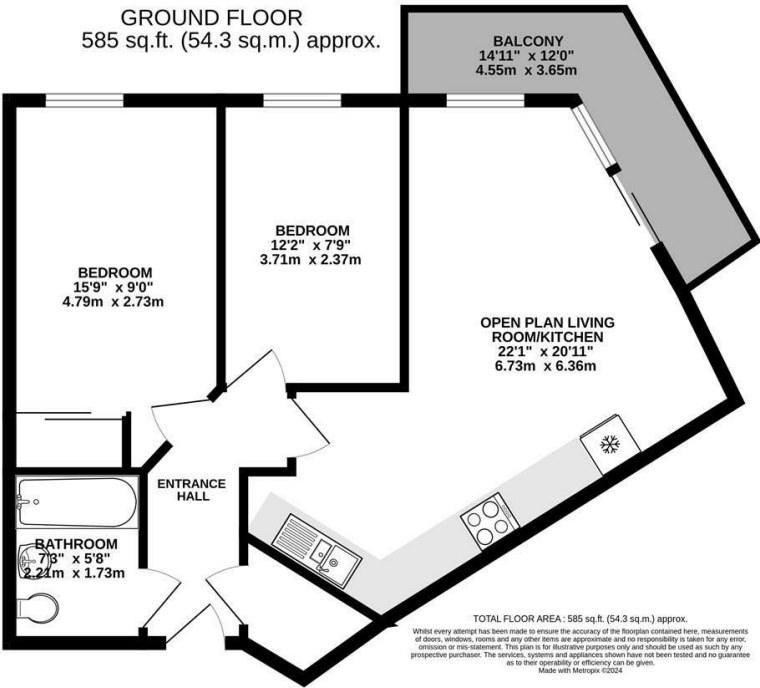

Viewing

Please contact Shepherds of Hertford on 01992 551955 if you wish to arrange a viewing appointment for this property or require further information.

Energy Performance Graph

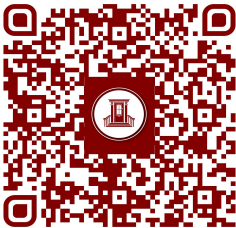
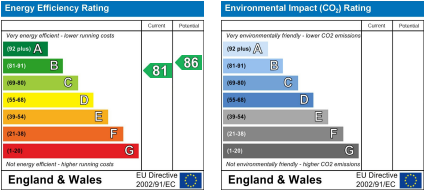

These particulars, whilst believed to be accurate are set out as a general outline only for guidance and do not constitute any part of an offer or contract. Intending purchasers should not rely on them as statements of representation of fact, but must satisfy themselves by inspection or otherwise as to their accuracy. No person in this firm's employment has the authority to make or give any representation or warranty in respect of the property.

Riverside House, 6 Millbridge, Hertford, SG14 1PY  
Tel: 01992 551955 Email: enquiries@shepherdsofhertford.co.uk