



7 Sturla Close

Hertford, SG14 3YJ

Price Guide £600,000



7 Sturla Close

Hertford, SG14 3YJ

Price Guide £600,000



Front door into:

Porch:

Radiator, cupboard, UPVC double glazed window to front and door to:

Kitchen/Dining Room:

24'5 x 13'4 (7.44m x 4.06m)

Comprising of:

Kitchen:

Fitted with a contemporary range of base and wall mounted units with contrasting worksurface incorporating sink with mixer tap and drainer, built in fridge, freezer, dishwasher, microwave, washing machine and Bosch oven, venting induction hob, stairs to first floor and door to:

Dining Room:

Radiator.

Living Room:

12'2 x 8'11 (3.71m x 2.72m)

Bifold doors opening to garden, skylight and radiator.

Cloakroom:

Low level WC, wash hand basin with mixer tap, radiator and opaque UPVC double glazed window to side.

First Floor Landing:

Airing cupboard, access to loft and doors to:

Bedroom One:

13'3 x 9'1 (4.04m x 2.77m)

UPVC double glazed window to rear, wardrobes, radiator and door to:

En-Suite Shower Room:

Low level WC, wash hand basin with mixer tap, tiled walk in shower, chrome heated towel rail, skylight and opaque UPVC double glazed window to rear.

Bedroom Two:

8'5 x 6'10 (2.57m x 2.08m)

Dual aspect UPVC double glazed window to side and rear, radiator and fitted blinds.

Bedroom Three:

11'10 x 6'9 (3.61m x 2.06m)

UPVC double glazed window to front, radiator and fitted blinds.

Bathroom:

Low level WC, wash hand basin with mixer tap, panel enclosed bath with mixer tap and rainfall shower head and chrome heated towel rail.

Garden:

Paved patio area with step down to artificial grass and enclosed by panel fencing, pedestrian gated side access and outside tap, power and light.

Garage and parking:

16'7 x 8'2 (5.05m x 2.49m)

Up and over door with power and light, electric car charging and two parking spaces in front.



Floor Plan

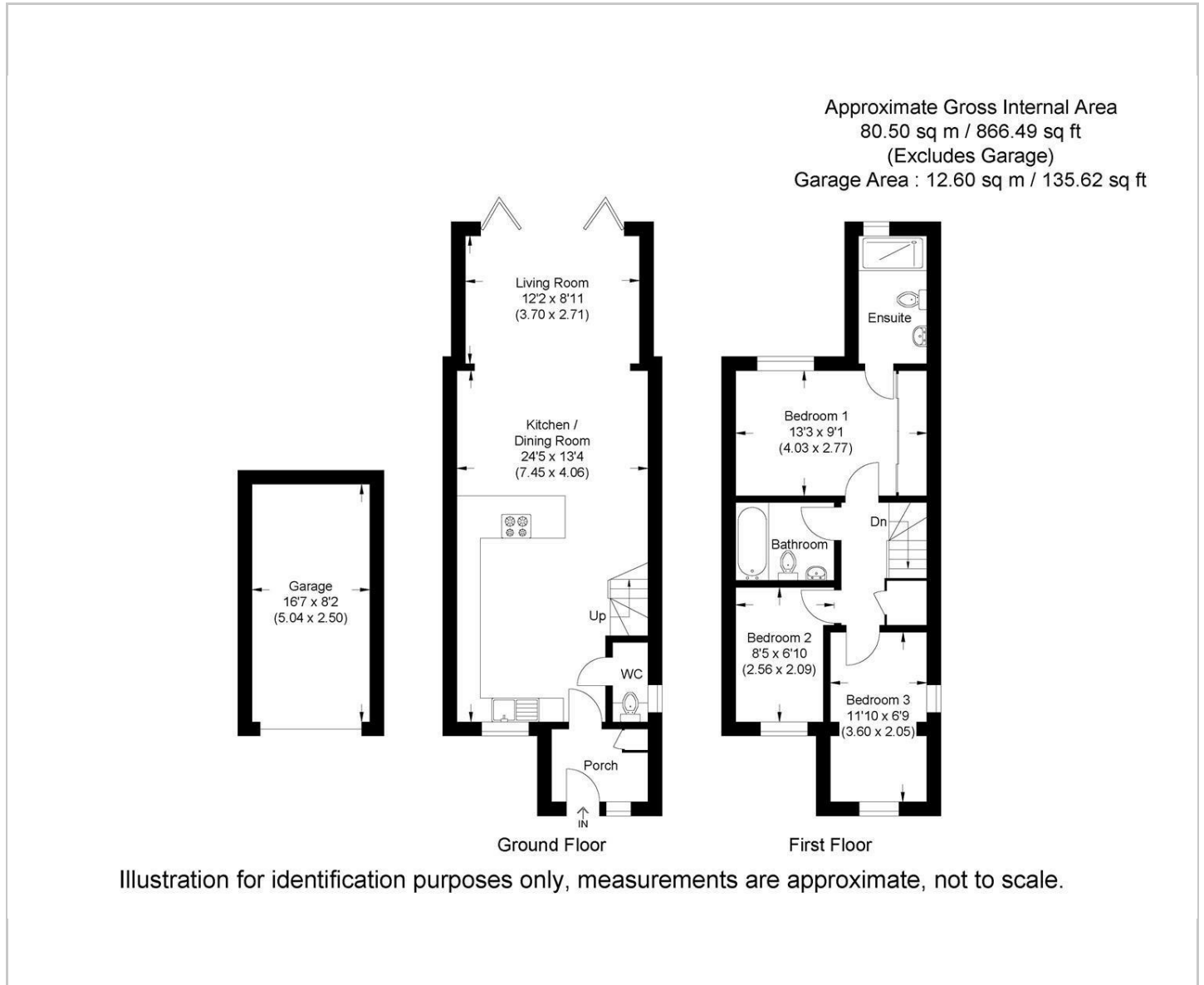

Viewing

Please contact Shepherds of Hertford on 01992 551955 if you wish to arrange a viewing appointment for this property or require further information.

Energy Performance Graph

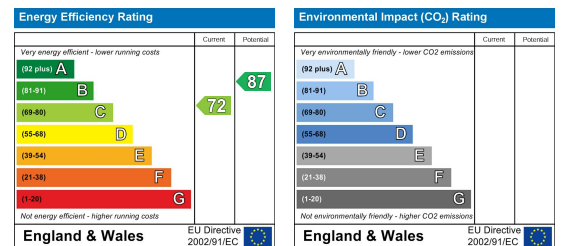

These particulars, whilst believed to be accurate are set out as a general outline only for guidance and do not constitute any part of an offer or contract. Intending purchasers should not rely on them as statements of representation of fact, but must satisfy themselves by inspection or otherwise as to their accuracy. No person in this firm's employment has the authority to make or give any representation or warranty in respect of the property.