



40 Edward House

Hertford, SG13 8FQ

Price Guide £300,000



40 Edward House

Hertford, SG13 8FQ

Price Guide £300,000



Accessed via secure entry phone system with both stairs and lift access leading to third floor and private front door into:

Entrance Hall:

Recessed spot lights, emergency pull cord, entry phone handset and doors to:

Walk in Cupboard:

A large walk in storage cupboard housing wall mounted gas boiler.

Lounge:

25'3 x 10'2 (7.70m x 3.10m)

Far reaching views over Hertford Castle and beyond in this spacious sitting room with UPVC double glazed door and windows, television and telephone points and door to:

Kitchen:

9'9 x 7'3 (2.97m x 2.21m)

UPVC double glazed window to rear, fitted with an extensive range of contemporary style gloss white base and wall units with contrasting work surfaces over incorporating single drainer stainless steel sink unit with mixer tap, tiled flooring, extractor, under unit and plinth lighting, built in stainless steel oven with separate ceramic hob and stainless steel extractor hood, built in stainless steel microwave and integrated fridge freezer.

Bedroom:

16'8 x 9'7 (5.08m x 2.92m)

UPVC double glazed window to rear with views towards Hertford Castle and beyond, television point, large walk in wardrobe.

Wet Room:

7'1 x 7'0 (2.16m x 2.13m)

Fitted with a modern suite comprising concealed cistern WC, vanity wash hand basin with mixer tap and cupboard under, shower area with rainfall head and hand attachment, extensively tiled walls, extractor, wall mounted mirror with light and chrome heated towel rail.

Communal Facilities:

The development offers an extensive range of facilities to include:

Bistro restaurant with table service, onsite shop, guest suite for overnight visitors, communal lounge with Wi-Fi, mobility scooter charging points.

Outside:

Attractive communal gardens for residents use with patio.

Tenure:

Leasehold - 999 years from 2018. (993 years remaining)

Service Charge - £7247.00

Ground rent - to be confirmed

The service charge includes cleaning of communal windows, water rates for communal areas and apartments, electricity, heating, lighting and power for communal areas, 24 hour emergency call system, upkeep of gardens and grounds, buildings insurance and contingency fund including internal and external redecoration of communal areas.

Council Tax:

East Herts District Council tax band C

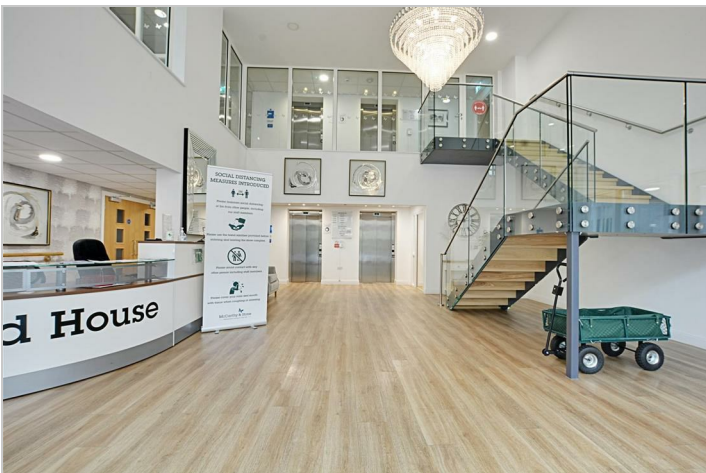

Floor Plan

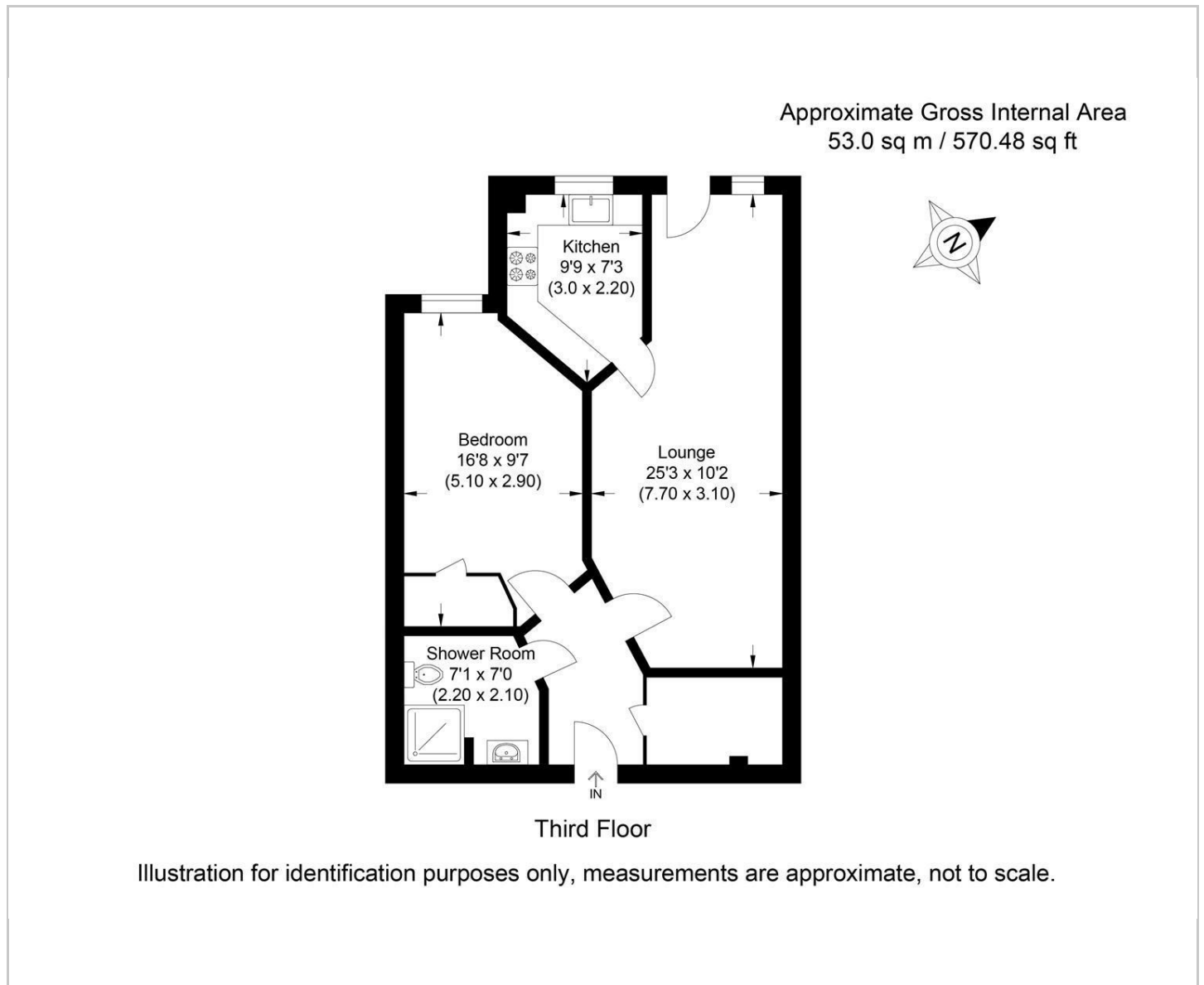

Viewing

Please contact Shepherds of Hertford on 01992 551955 if you wish to arrange a viewing appointment for this property or require further information.

Energy Performance Graph

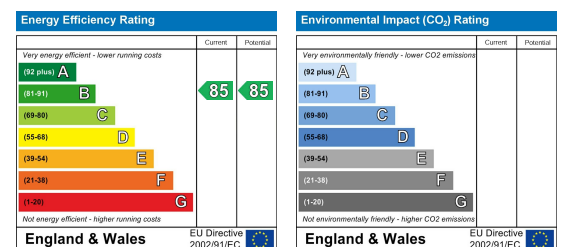

These particulars, whilst believed to be accurate are set out as a general outline only for guidance and do not constitute any part of an offer or contract. Intending purchasers should not rely on them as statements of representation of fact, but must satisfy themselves by inspection or otherwise as to their accuracy. No person in this firm's employment has the authority to make or give any representation or warranty in respect of the property.