



19 Windsor Street

, York, YO23 1DN

£1,150 PCM

SORRY WE ARE NOW FULL FOR VIEWINGS | Windsor Street | Popular South Bank Location | Short Walk To Bish Rd Shops & Cafes | Two Double Bedrooms | Handy For Railway Station & City Centre | Open Plan Lounge & Dining Room | On Street Parking Available | EPC rating TBC | Council Tax Band B | Available Early August

- SORRY - FULL FOR VIEWINGS ON THIS PROPERTY
- Short Walk To Bish Rd Shops & Cafes
- Two Double Bedrooms
- Handy For Railway Station & City Centre
- Open Plan Lounge & Dining Room
- On Street Parking Available
- EPC rating TBC
- Council Tax Band B
- Available Early August

Viewing

Please contact our Quantum Estate Agency Lettings Office on 01904 631631 if you wish to arrange a viewing appointment for this property or require further information.



For Sale

Energy Efficiency Rating

	Current	Potential
Very energy efficient - lower running costs		
(92 plus) A		86
(81-91) B		
(69-80) C		
(55-68) D		
(39-54) E		
(21-38) F		
(1-20) G	60	
Not energy efficient - higher running costs		

England & Wales

EU Directive 2002/91/EC

Environmental Impact (CO₂) Rating

	Current	Potential
Very environmentally friendly - lower CO ₂ emissions		
(92 plus) A		87
(81-91) B		
(69-80) C		
(55-68) D		
(39-54) E		
(21-38) F		
(1-20) G	58	
Not environmentally friendly - higher CO ₂ emissions		

England & Wales

EU Directive 2002/91/EC

GROUND FLOOR
334 sq ft (31.0 sq m) approx.

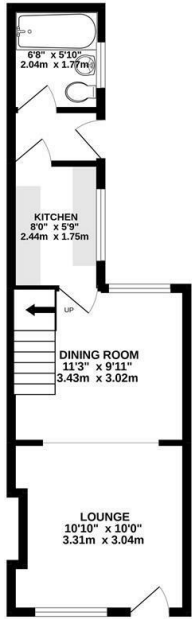

1ST FLOOR
228 sq ft (21.2 sq m) approx.

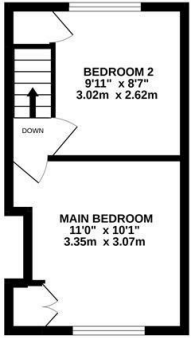

TOTAL FLOOR AREA: 562 sq ft (52.2 sq m) approx.
While every attempt has been made to ensure the accuracy of the floorplan contained here, measurements of doors, windows, rooms and any other items are approximate and no responsibility is taken for any error, omission or misstatement. This plan is for illustrative purposes only and should not be used as such by any prospective purchaser. The services, systems and appliances shown have not been tested and no guarantee is given as to their operability or efficiency can be given.
Made with Metaplex 120022



6 Walmgate, York, YO1 9TJ
t: 01904 631631 e: homes@quantumstateagency.com www.quantumstateagency.com

These particulars, whilst believed to be accurate are set out as a general outline only for guidance and do not constitute any part of an offer or contract. Intending purchasers should not rely on them as statements of or representation of fact (especially if a substantial journey is required to view the property), but must satisfy themselves by inspection or otherwise as to their accuracy. No person in this firm's employment has the authority to make or give any representation or warranty in respect of the property.