



8 Hatters Close

Copmanthorpe, York, YO23 3XQ

£1,300 PCM

*Fees apply

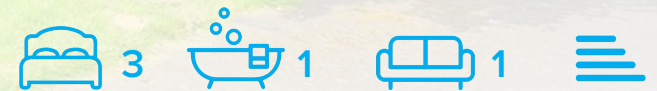

To Let

Hatters Close *** 6 month let only ***
Detached house *** Three Bedrooms ***
Unfurnished *** Large garage ***
Conservatory *** Front & Rear garden ***
Available NOW *** EPC rating E ***
Council Tax C***

[Agency Information](#)

[Permitted Payments](#)

[Brochure- Referencing](#)

[Material Information](#)



To Let



Energy Efficiency Graph

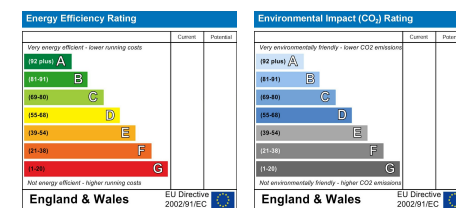

GROUND FLOOR
464 sq. ft. (43.1 sq.m.) approx.

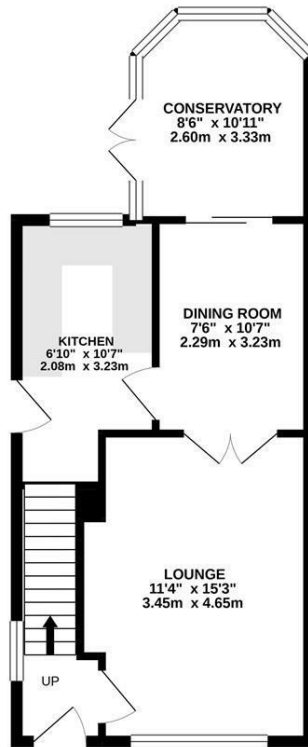

1ST FLOOR
381 sq. ft. (35.4 sq.m.) approx.

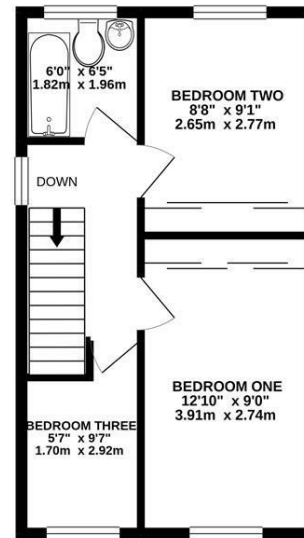

TOTAL FLOOR AREA: 845 sq. ft. (78.5 sq.m.) approx.
While every attempt has been made to ensure the accuracy of the floorplan contained herein, measurements of doors, windows, rooms and any other items are approximate and no responsibility is taken for any error, omission or mis-statement. This plan is for illustrative purposes only and should be used as such by any prospective purchaser. The services, systems and appliances shown have not been tested and no guarantee as to their operability or efficiency can be given.
Made with Metropix 0.0200

6 Walmgate, York, YO1 9TJ

t: 01904 631631 e: homes@quantumstateagency.com www.quantumstateagency.com

These particulars, whilst believed to be accurate are set out as a general outline only for guidance and do not constitute any part of an offer or contract. Intending purchasers should not rely on them as statements of or representation of fact (especially if a substantial journey is required to view the property), but must satisfy themselves by inspection or otherwise as to their accuracy. No person in this firm's employment has the authority to make or give any representation or warranty in respect of the property.