

Dunstable Office:
01582 477 077



Residential Sales • Property Management • Lettings



Stuart Street, Dunstable

Offers In Excess Of £300,000

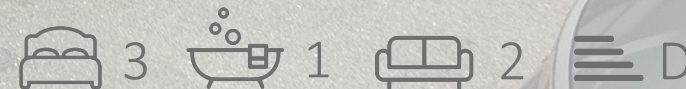

Stuart Street, Dunstable

This WELL PROPORTIONED 3 bedroom FAMILY HOME is SUPERBLY PRESENTED throughout and is offered for sale with a BRICK BUILT OUTBUILDING which is perfect for use as a home office or studio plus the HUGE BENEFIT OF PERMIT PARKING.

Lounge/Diner

26'4" x 12'11" (8.02m x 3.93m)

Kitchen

13'4" x 7'8" (4.06m x 2.34m)

Main Bedroom

11'7" x 14'4" (3.52m x 4.38m)

Bedroom 2

11'10" x 8'11" (3.61m x 2.73m)

Bedroom 3

7'3" x 7'8" (2.21m x 2.34m)

Bathroom

6'5" x 5'0" (1.95m x 1.52m)

Rear Garden

Outbuilding

8'3" x 14'3" (2.51m x 4.34m)





Floor Plan

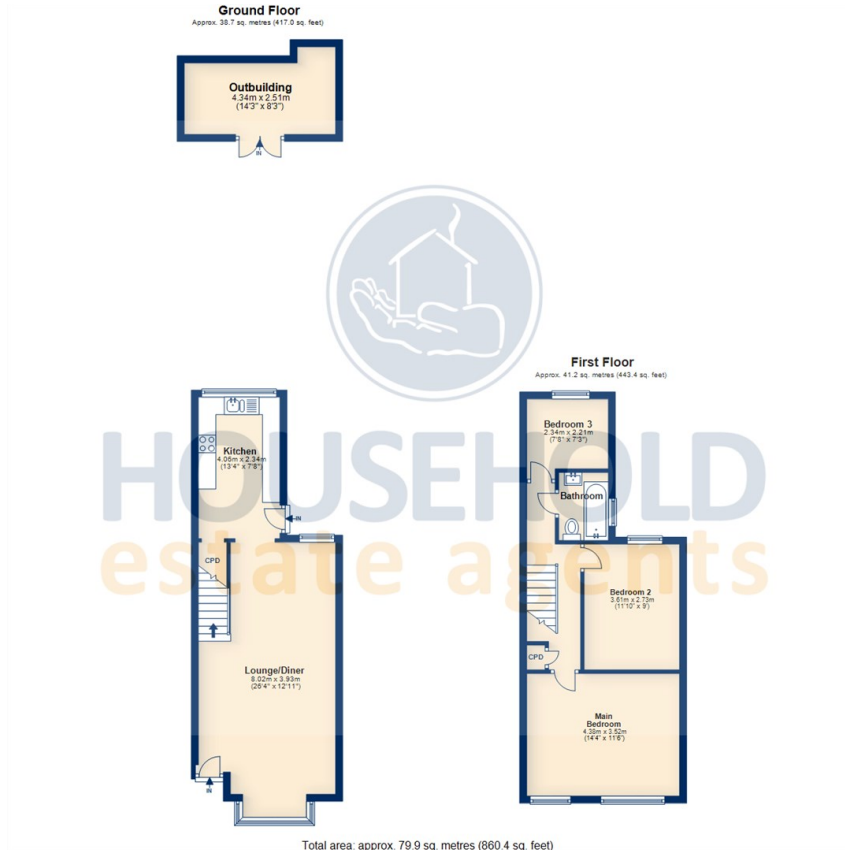

Area Map

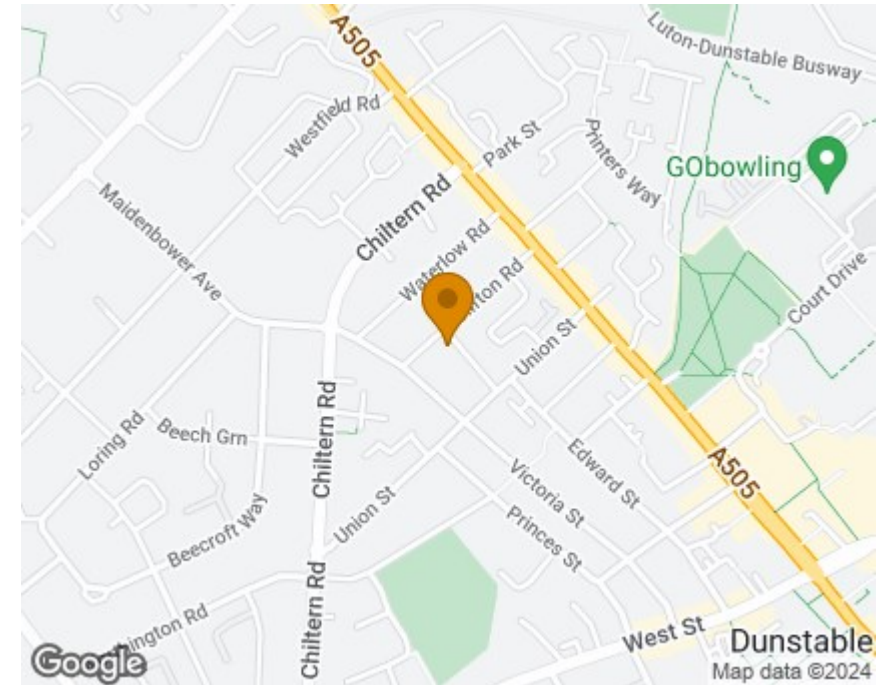

EPC

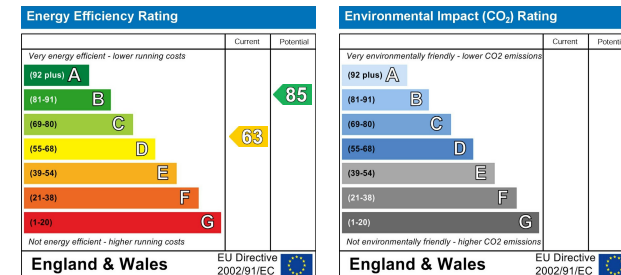

Viewing

Please contact our Dunstable - Sales Office on 01582 477 077 if you wish to arrange a viewing appointment for this property or require further information.

address: 15b High Street North
Dunstable, Beds LU6 1HX

telephone: 01582 477 077

email: dunstable@house-hold.co.uk

website: www.house-hold.co.uk

Additional Office: **Toddington:** 2-4 High Street
- 01525 877 771

The Property Experts with the Personal Touch

MISDESCRIPTONS ACT: Household Estate Agents Ltd. For themselves and for the vendors of this property, whose agents they are, give notice that the particulars are set out as a general outline only for the guidance of intending purchasers and do not constitute or constitute part of any offer of contract, All descriptions, dimensions references to the condition and necessary permissions for use and occupation and other details are given without responsibility, and the intending purchasers should not rely upon them as statements or representations of fact but must satisfy themselves by inspection or otherwise as to their correctness. No person in the employment of Household Estate Agents Limited has any authority to give or make any representation or warranty whatsoever in relation to this property.