



Hillfield Avenue, N8

£700,000

This charming two bedroom first floor flat features a modern kitchen and bathroom, two well-proportioned bedrooms, and a spacious reception room. The property also benefits from ample storage, a private terrace, and a large private garden with an outbuilding.

Hillfield Avenue is a quiet residential turning situated moments away from the many shops, restaurants and other amenities of both Crouch End Broadway and Hornsey High Street. Nearby green spaces include Priory Park and Alexandra Palace.

Features

- Two Bedrooms
- Private Garden
- Share of Freehold
- Recently Renovated
- First Floor
- Private Terrace

Hillfield Avenue, LONDON, N8

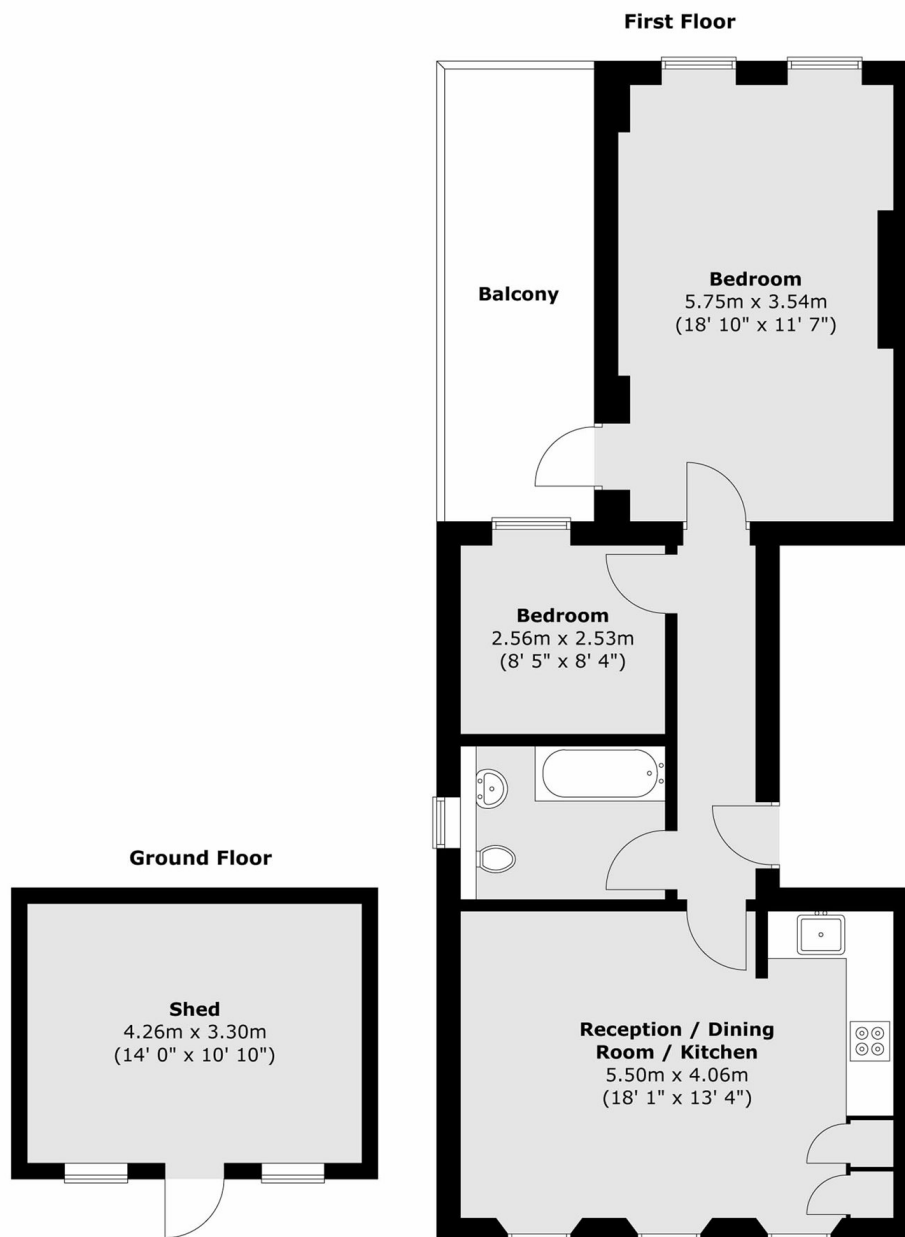

Total area (approx.) : 60.3 sq. m (649 sq. ft)
Total shed area (approx.) : 14 sq. m (151 sq. ft)
Total balcony area (approx.) : 11.5 sq. m (124 sq. ft)