



Coster Avenue, N4

£500,000

This spacious one bedroom apartment is located on the ground floor and offers an internal area of over 638 sq ft. The apartment has an open plan reception / dining room / kitchen, and a private patio garden.

The property is ideally located near Manor House and Finsbury Park stations, offering quick access to Central London (under 20 minutes), along with local shops, cafés, and green spaces.

Features

- Double Bedroom
- Long Lease
- Open Plan
- Private Patio Garden
- 24-hour Concierge
- Swimming Pool and Gym

Coster Avenue, London, N4

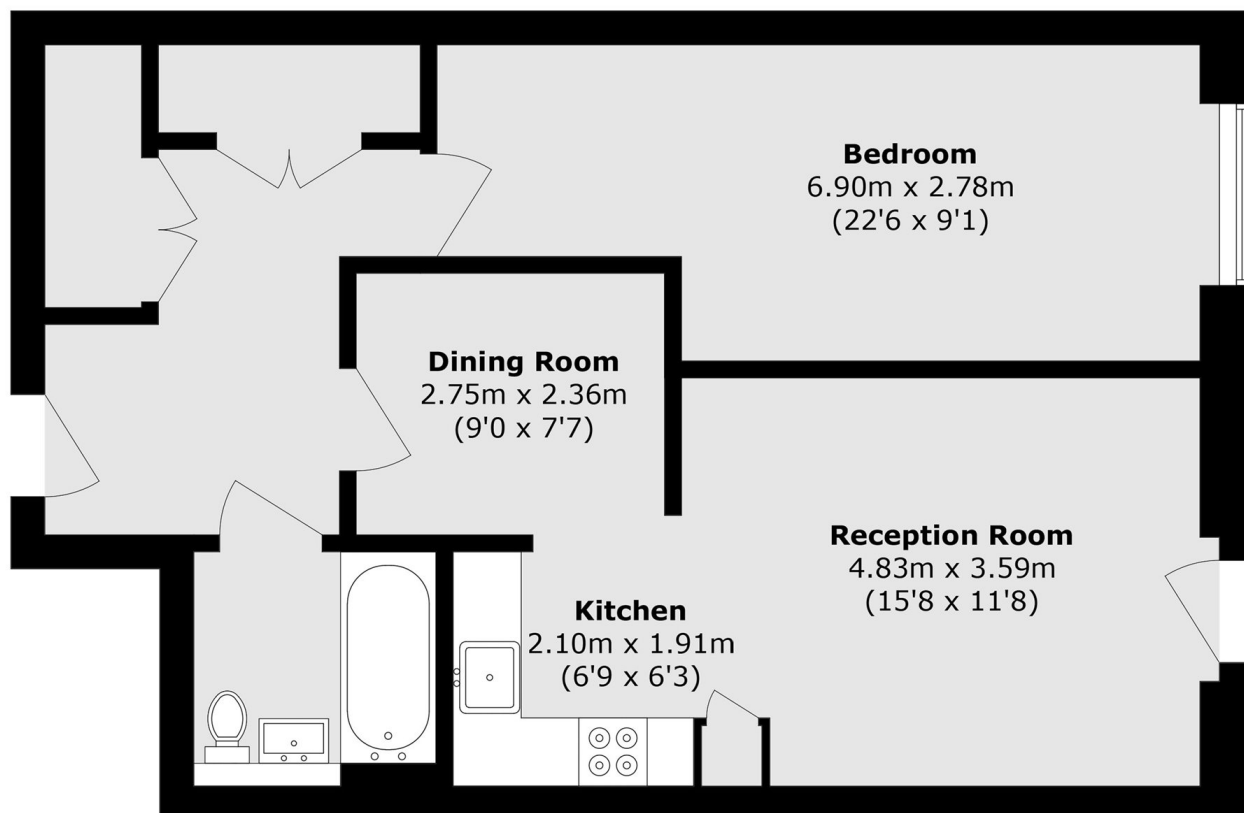

Total area (approx.): 63.3 sq. m (681.4 sq. ft)