

Mayes Road, N22

£375,000

A two bedroom, garden flat in a converted Victorian building. Presented in very good decorative order throughout, the property offers an open plan kitchen/reception, a private entrance and a large private garden.

Mayes Road is well-located for easy access to Wood Green underground station (Piccadilly line) and is also close to nearby shops, bars and restaurants. The green open spaces of Alexandra Palace is also close by.

Features

- South West Facing Garden
- Recently Refurbished
- Chain Free
- Two Bedrooms
- Close To Amenities
- Private Entrance

Mayes Road, London, N22

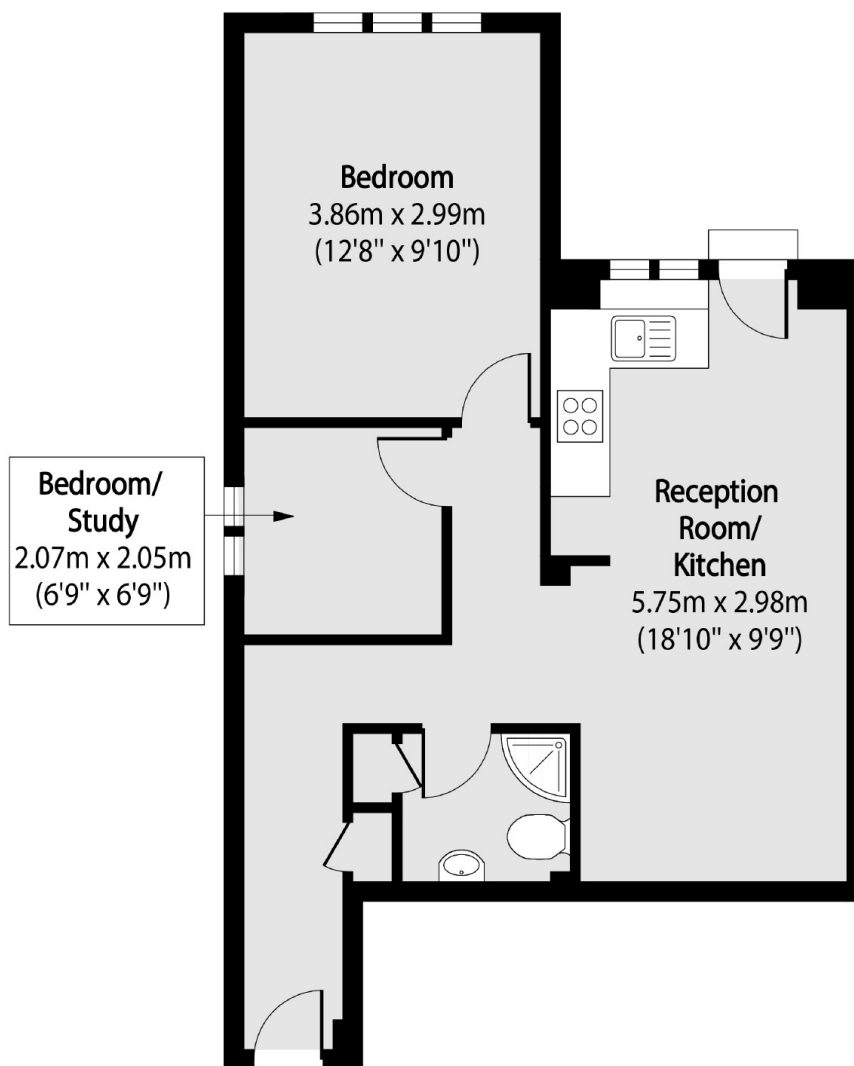

Total area (approx): 45.72 sq m (492 sq. ft)