



## Drayton Park, N5

£425,000

A modern two double bedroom apartment located within a secure development with concierge and lift access. It has a modern open plan kitchen and reception with wooden flooring and a balcony plus a spacious bathroom with shower over bath.

Ashburton Triangle is located off Drayton Park which is just moments from Arsenal tube station as well as being within easy reach of Drayton Park, Holloway Road and Highbury & Islington stations.

### Features

- Two Double Bedrooms
- Open Plan Living
- Balcony
- Concierge
- Lift Access
- Excellent Location

# Drayton Park, London, N5

## Fifth Floor

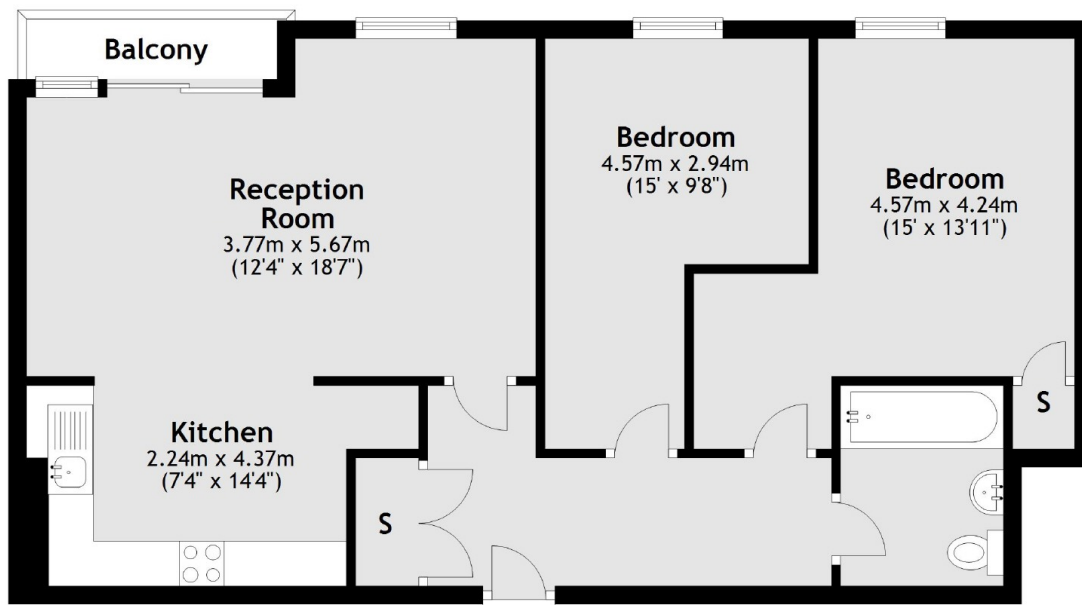

Total area: approx. 68.0 sq. metres (732.0 sq. feet)