



## Nelson Road, N8

### £1,350,000

A five bedroomed terraced house with a large south-west facing garden. This property is bursting with original features with a modern kitchen, two bathrooms and a large reception room with a bay window.

Nelson Road is conveniently located moments' walk from Stationers Park and close proximity to Crouch End's Local Broadway offering a great choice of boutiques and restaurants. Transport links are easily accessible from Finsbury Park station and Hornsey station.

### Features

- Five Bedrooms
- South-west Facing Garden
- Excellent Location
- Original Features
- Quiet Street
- Plenty of Storage

# Nelson Road, London, N8

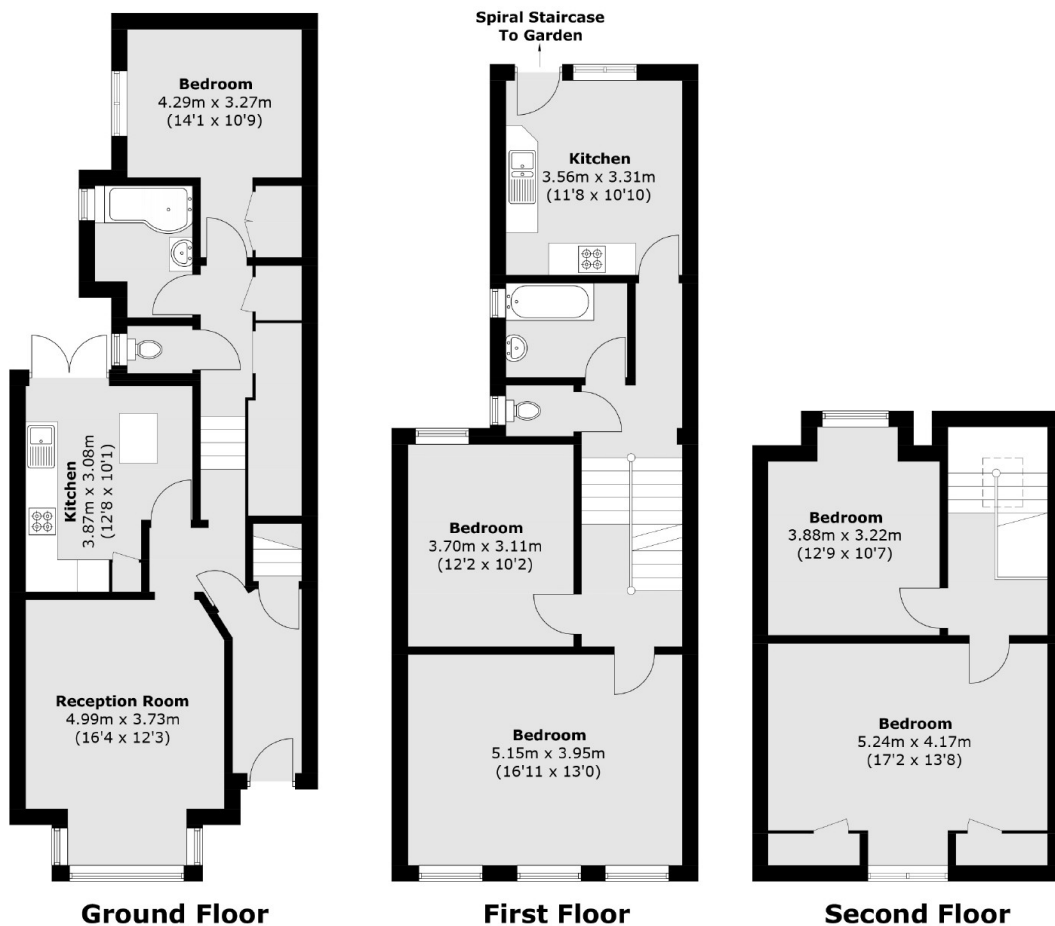

Total area (approx.): 171.4 sq. m (1844.8 sq. ft)